

STATIONARY LEG INSTALLATION

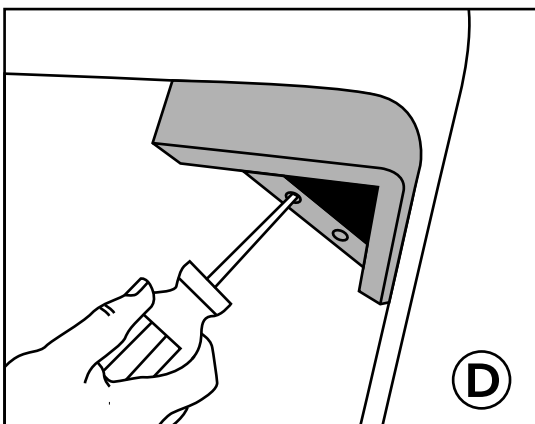
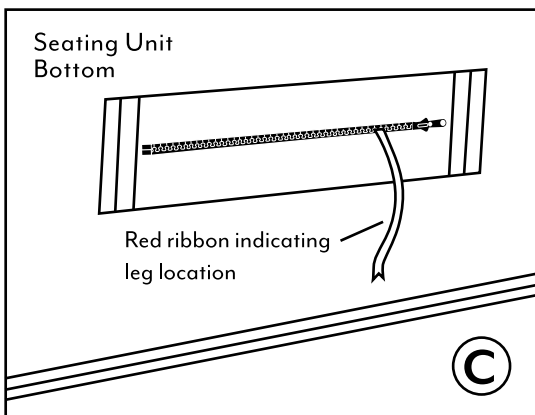
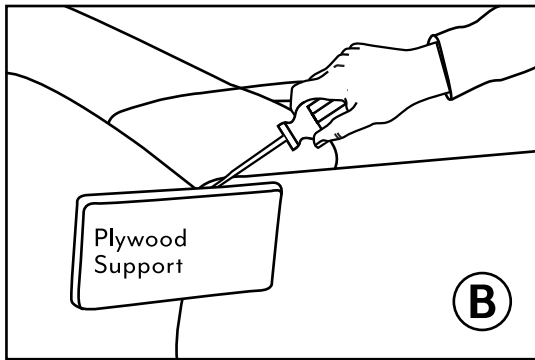
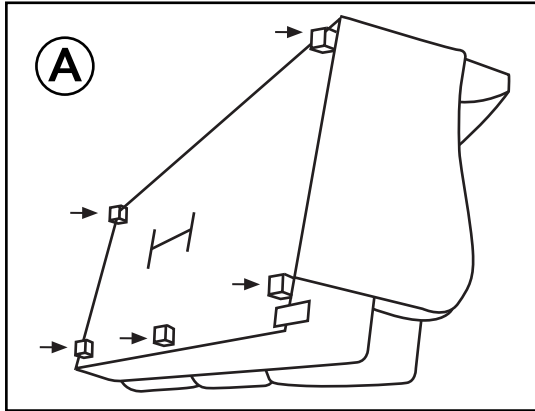

1. Remove cardboard and plastic shipping material from seating unit.
2. Tilt unit forward from rear until it rests on the ottoman/footrest and inside back.
(see diagram A)
3. If unit has plywood support, remove with a flat head screwdriver or prybar. Place the flat head screwdriver or prybar between plywood support and bottom arm rail and pry up and down to remove.
(see diagram B)
Note: Prybar/screwdriver not included.
4. Locate zipper pouch on underside of sofa.
(see diagram C) Unzip and remove legs and screws from pouch. Sofa (#10181321) will have 5 legs, Loveseat (#10281323), Chair (#10381325), and Ottoman (#10481327) will have 4 legs.
5. Place one leg at corner. Using a phillips head screwdriver, line up leg with holes and secure leg using 2 screws. Repeat for each leg. (see diagram D)
Note: Phillips head screwdriver not included.
6. After all legs are secure, carefully turn sofa upright.

SOFA SKU #10181321
LOVESEAT SKU #10281323
CHAIR SKU #10381325
OTTOMAN SKU #10481327
Vendor Code: FRNK
CI-05 REV 10/9/2025