



# ASSEMBLY INSTRUCTIONS

**JXFC 1607/1608 PWR Console LVST**

**SKU: 15216078/15216080**

Please identify and locate all assembly parts (see parts list) before discarding any packing materials.

Some parts may have become loose during transit.

Step 1: ARM ASSEMBLY INSTRUCTION

Step 1: BACK CUSHION ASSEMBLY INSTRUCTION

TWO PERSON ASSEMBLY INSERT THE TOP OF POWER MOTION LOVESEAT WITH CONSOLE INTO THE BASE OF POWER MOTION LOVESEAT WITH CONSOLE ON BOTH SIDES. AT THE SAME TIME FOR QUICK AND EASY ASSEMBLY.

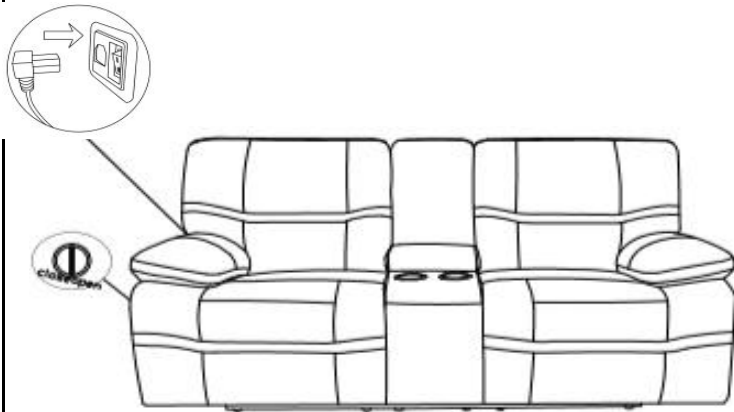
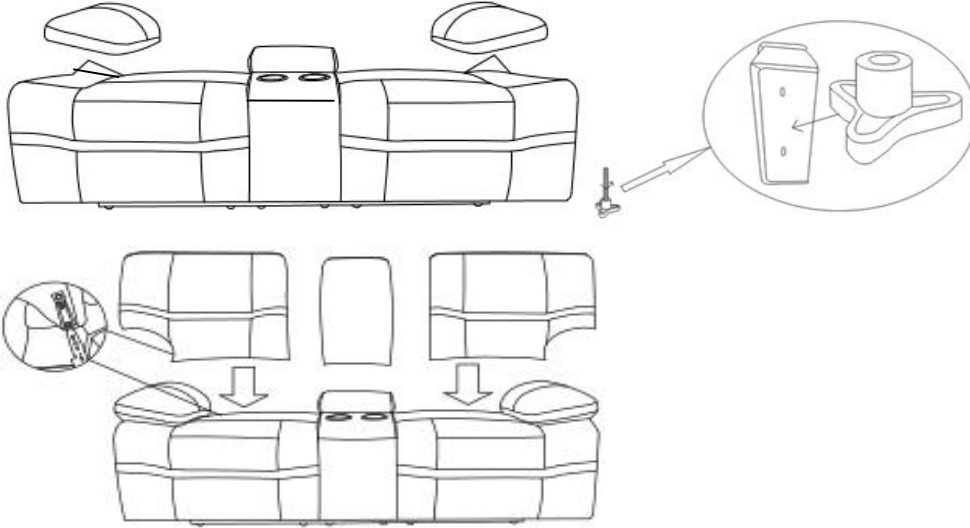

15053-222

## PARTS LIST

NO	SKETCH	DESCRIPTION	QTY
1		BASE OF POWER MOTION LOVESEAT WITH CONSOLE	1PC
2		LEFT/RIGHT ARM	2PCS
3		LHF BACK CUSHION	1PC
4		RHF BACK CUSHION	1PC
5		CONSOLE BACK CUSHION	1PC
6		HARDWARE	4PCS
7		Plug-in transformer	1PC