



## Assembly Instructions SYNE K1563-86 Pushback Recliner

SKU# 18535609 18535611 18535623 18535635 18535647  
18535659 18535661 18535673 18535685

Manufactured for Rooms To Go

**\*\*\*CAUTION:** The item is heavy, assembly should be performed by two people in soft surface

### PARTS LIST

Long Front wood Leg 2 pieces		Short Rear wood Leg 2 pieces		Bolts 4 pieces (M8*3.54, 18 thread per inch)	
---------------------------------	---	---------------------------------	---	--	---

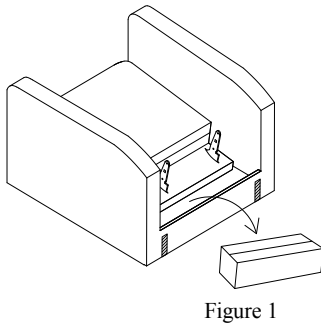
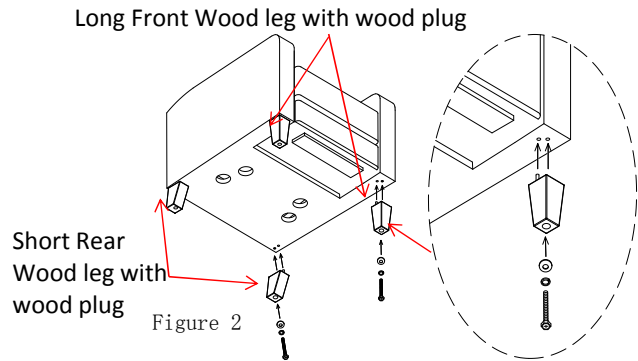

Figure 1



Long Front Wood leg with wood plug

Short Rear  
Wood leg with  
wood plug

Figure 2

**1.** The Wooden Legs are located at the rear of seat cushion, remove all the Wooden Legs from the box (See Figure 1). Attach each wooden leg to its corresponding pre-drilled hole by turning in a clockwise direction until secure (this can be done by hand (See Figure 2)).

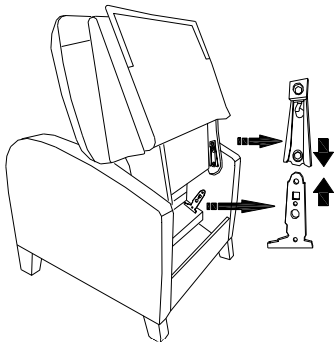

**1.** Align top brackets on both sides with metal posts.

**2.** Press both sides of the back firmly down and into a locked position. The back should automatically lock into place.

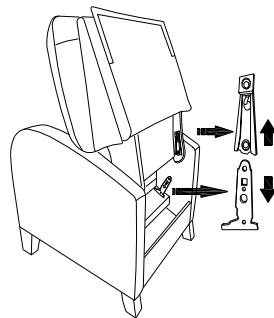
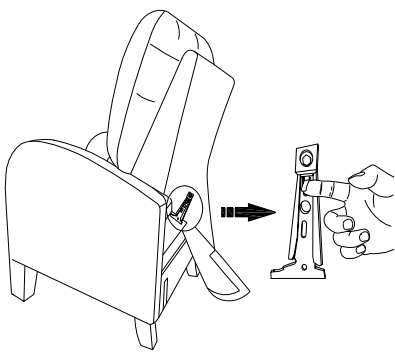
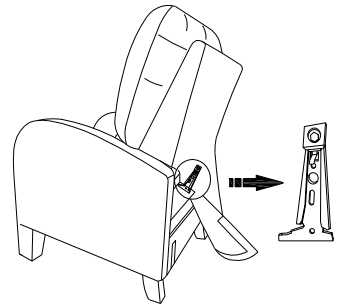

**3.** To remove the back, lift the tab on both sides and pull the back straight up. Note: if there is difficulty in getting the back to lock into place check to see that the tab is engaged in the proper space.

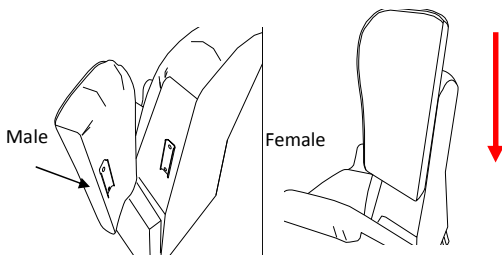

### 5. KD Wings (If applicable)

Insert the male KD Bracket into the slot of the female Bracket pressing firmly downward until the frame is tight.

**4.** To make the chair easier to recline, tip it on its back and turn the tension adjusters counter clockwise. Turn them clockwise to increase the resistance needed to recline. Note: to keep the chair tension balanced, turn both sides in equal amounts.

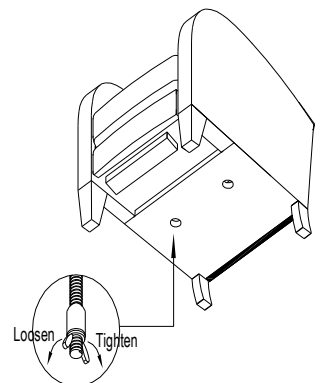

Note: There are no tension adjusters on mechanisms #1632, #1671, #1672, #2032, #2034, or #2072. But mechanisms #8550, #2000, 7550 or #8546 have the tension adjusters and you can get the mechanism numbers from the side of the mechanism. Follow point 5 above to adjust the tension.