

Item # : AF18NAOST

Assembly Instructions

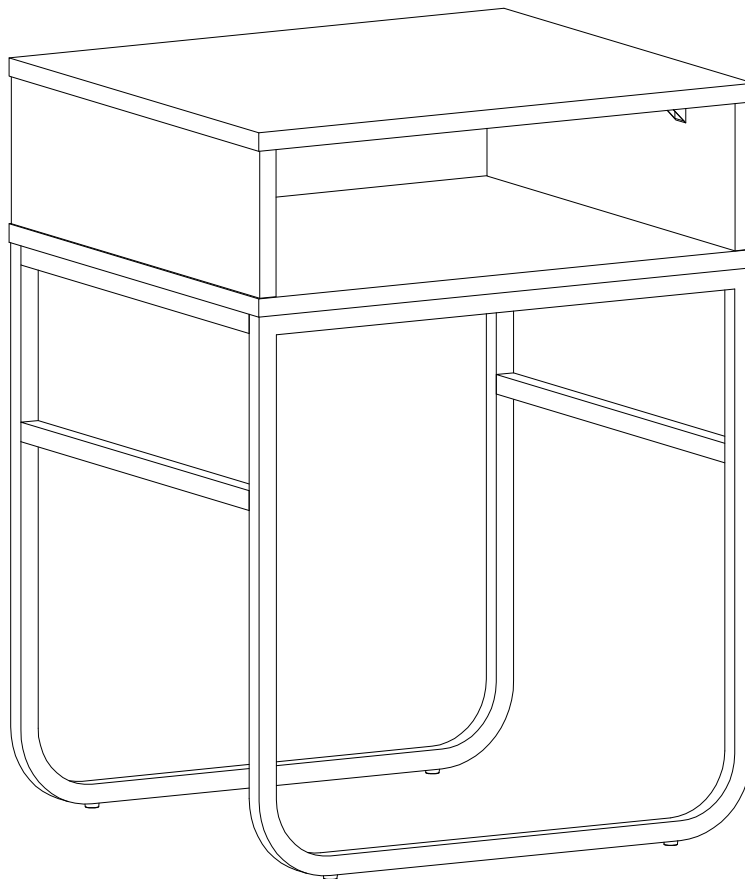

Walker Edison®

Please visit our website for the most current instructions, assembly tips, report damage, or request parts. www.walkeredison.com

Revised 25/12/2019 (I)

General Assembly Guidelines

- I. Ensure that all parts and hardware are available before beginning assembly.
- II. Follow each step carefully to ensure the proper assembly of this product.
- III. Two people are recommended for ease in the assembly of this product.
- IV. The three main types of hardware used to assemble this product are: wood dowels, screws and bolts.
- V. The provided glue is to secure wood dowels in place. When first inserting dowels, locate the appropriate hole for the dowel, place a small amount of glue in the hole and insert the dowel. Wipe away excess glue immediately.

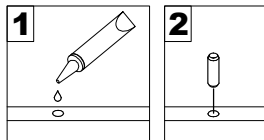

In future assembly steps when dowels are necessary to attach assembly parts together, place a small amount of glue on the end of the dowel before attaching parts together. Wipe away excess glue immediately.

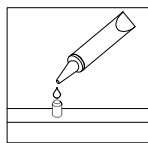

- VI. A Phillips head screwdriver is required for the assembly of this product .

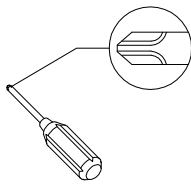

- VII. Power tools should not be used to assemble this product.

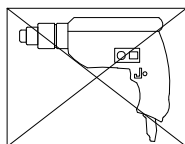

Parts List

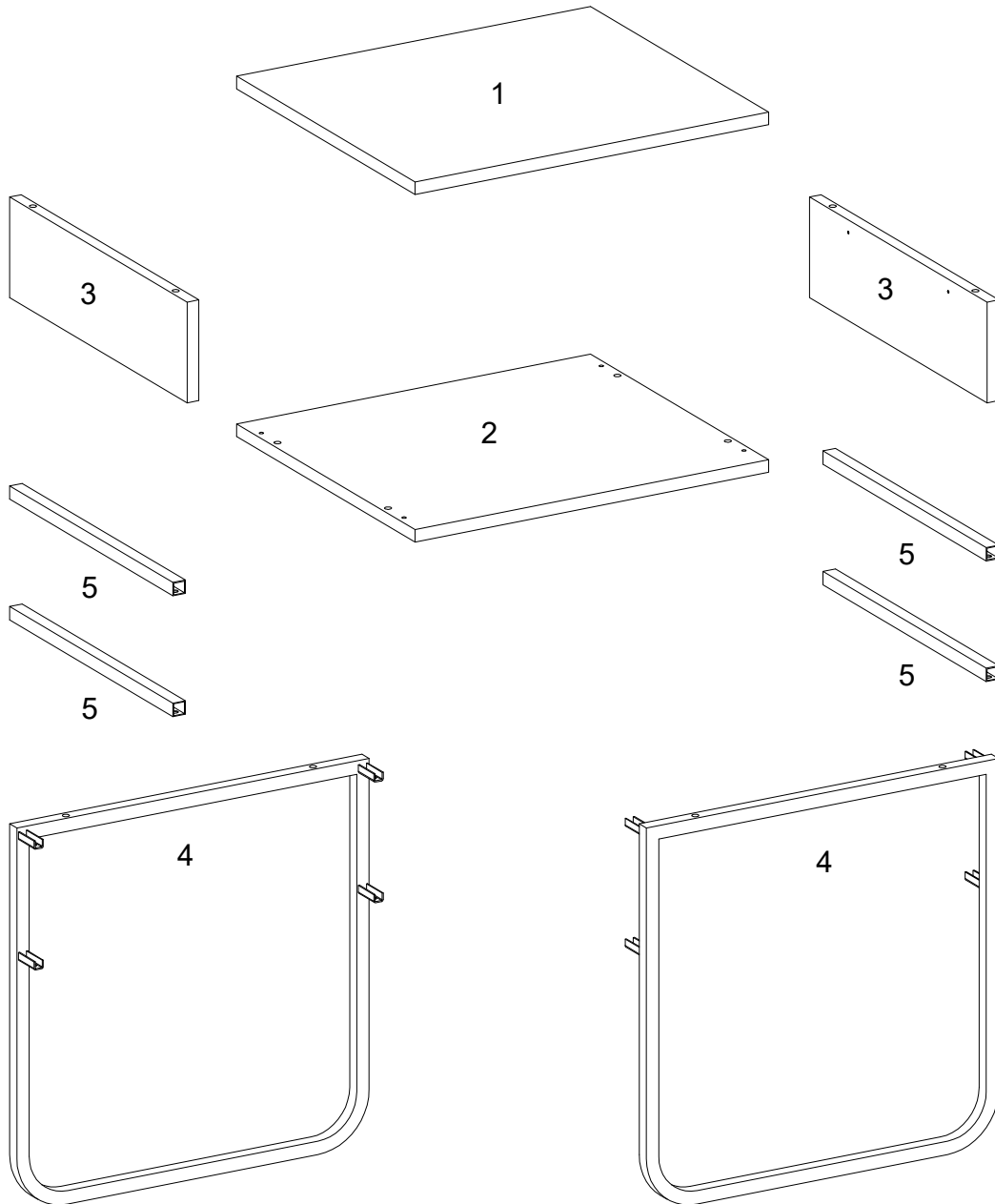

Hardware List

A		Ø8x30mm	Wooden dowel	8	pcs
B		Ø4x12mm	Screw	8	pcs
C		Ø4x38mm	Screw	4	pcs
D		M6x10mm	Bolt	16	pcs
E		M6x27mm	Bolt	4	pcs
F		M4	Hex Key	1	pc
G			bracket	4	pcs
H			Glue tube	1	pc
J			Adjustable floor leveler	4	pcs

*The hardware quantities listed above are required for proper assembly.
Some extra hardware may also have been included.*

Step 1

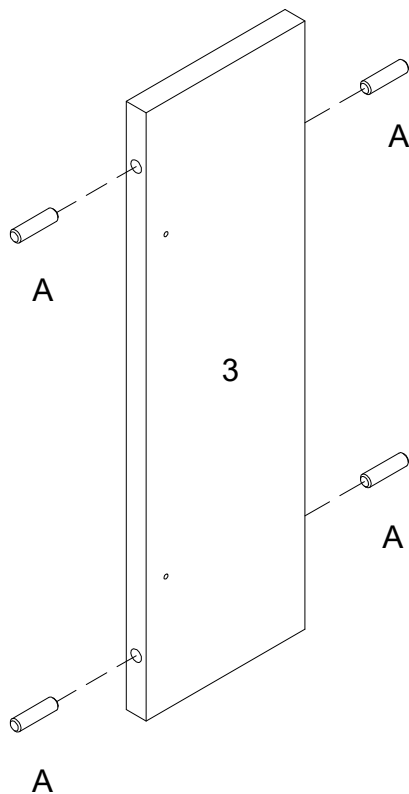

X2

Insert wooden dowel (A) into part(3) as per diagram.

Step 2

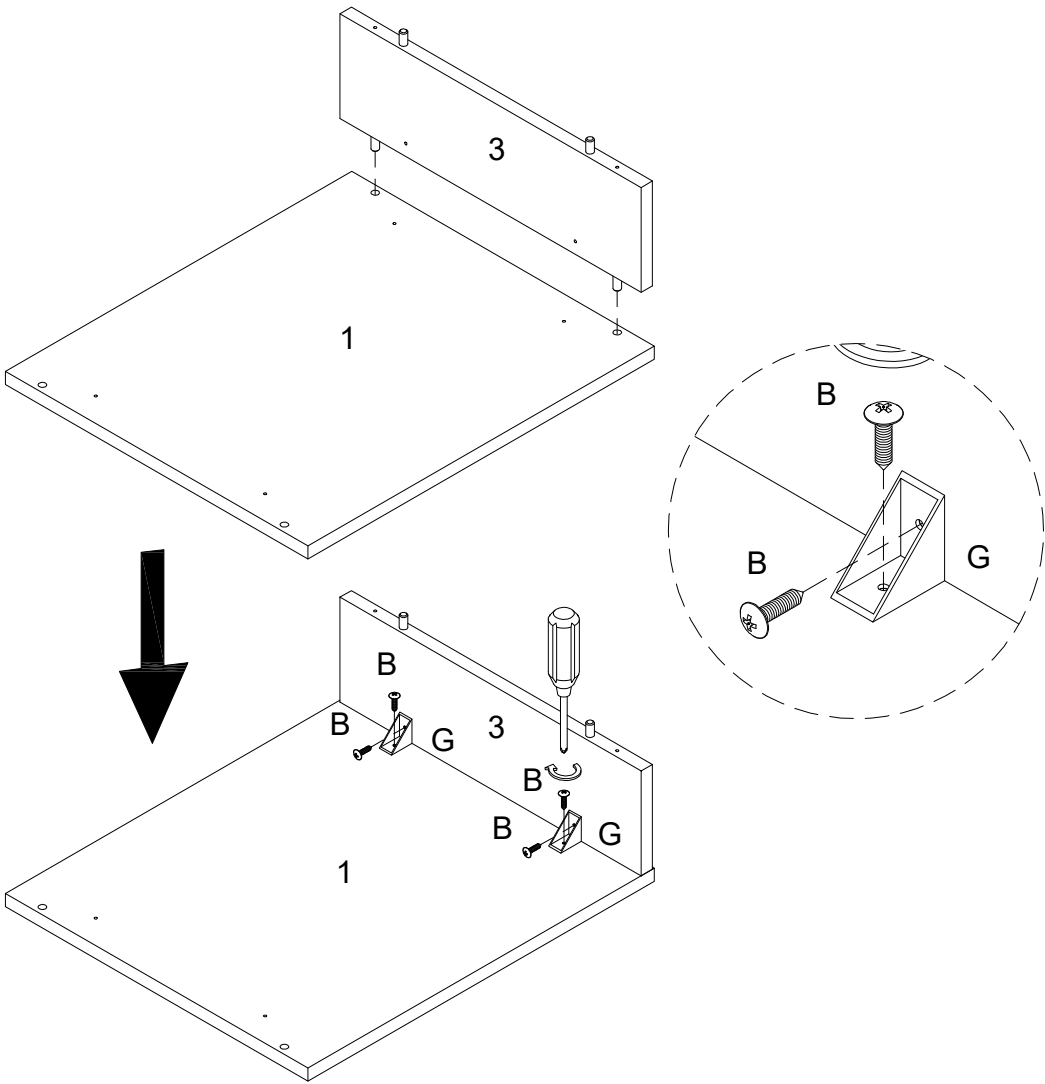

Put part (3) to part (1), then using screw (B) attach bracket (G) to parts (1,3) with Philips head screwdriver as per diagram.

Step 3

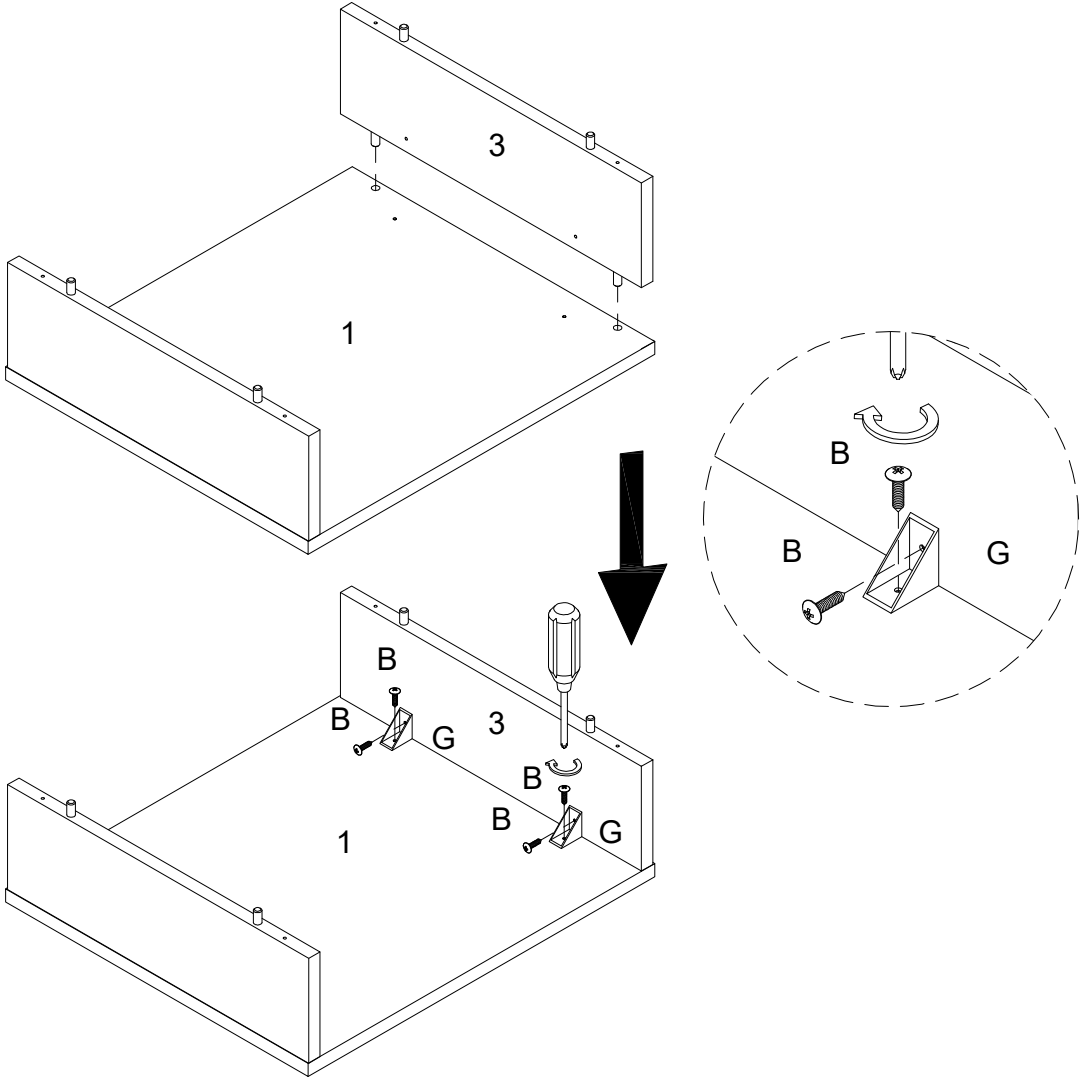

Put part (3) to part (1), then using screw (B) attach bracket (G) to parts (1,3) with Philips head screwdriver as per diagram.

Step 4

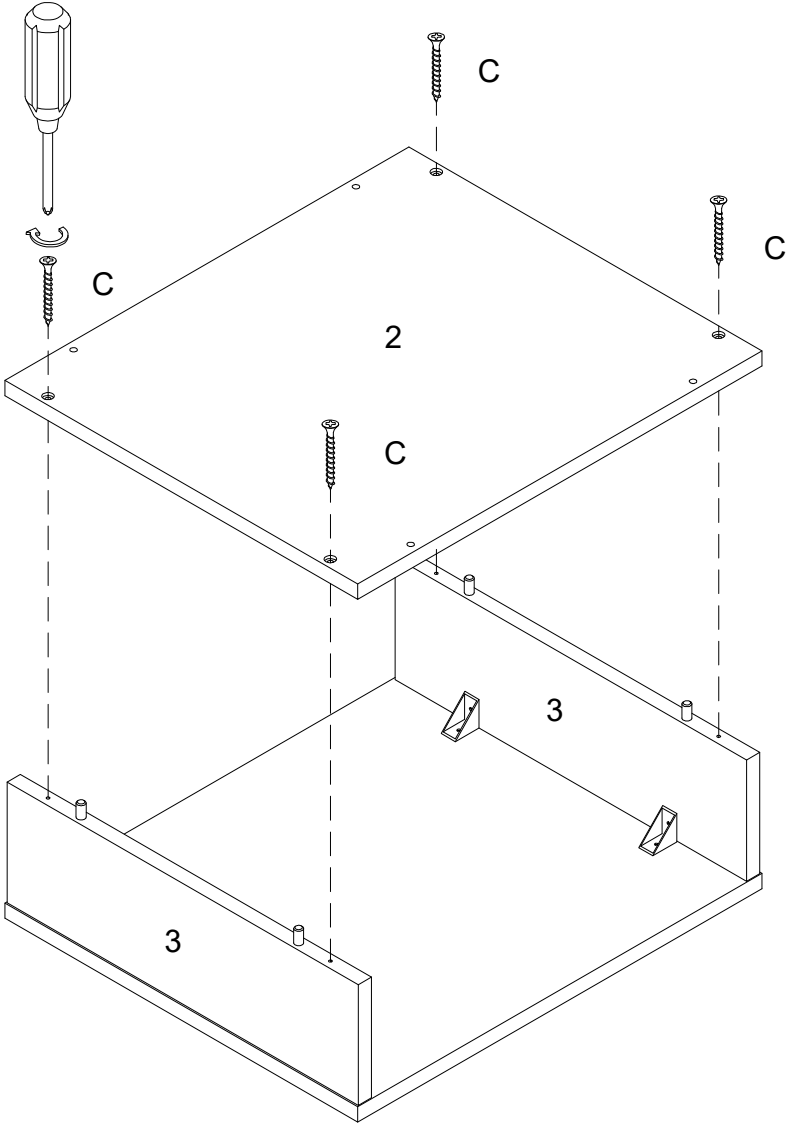

Using screw (C) attach part (2) to part (3) with Philips head screwdriver as per diagram.

Step 5

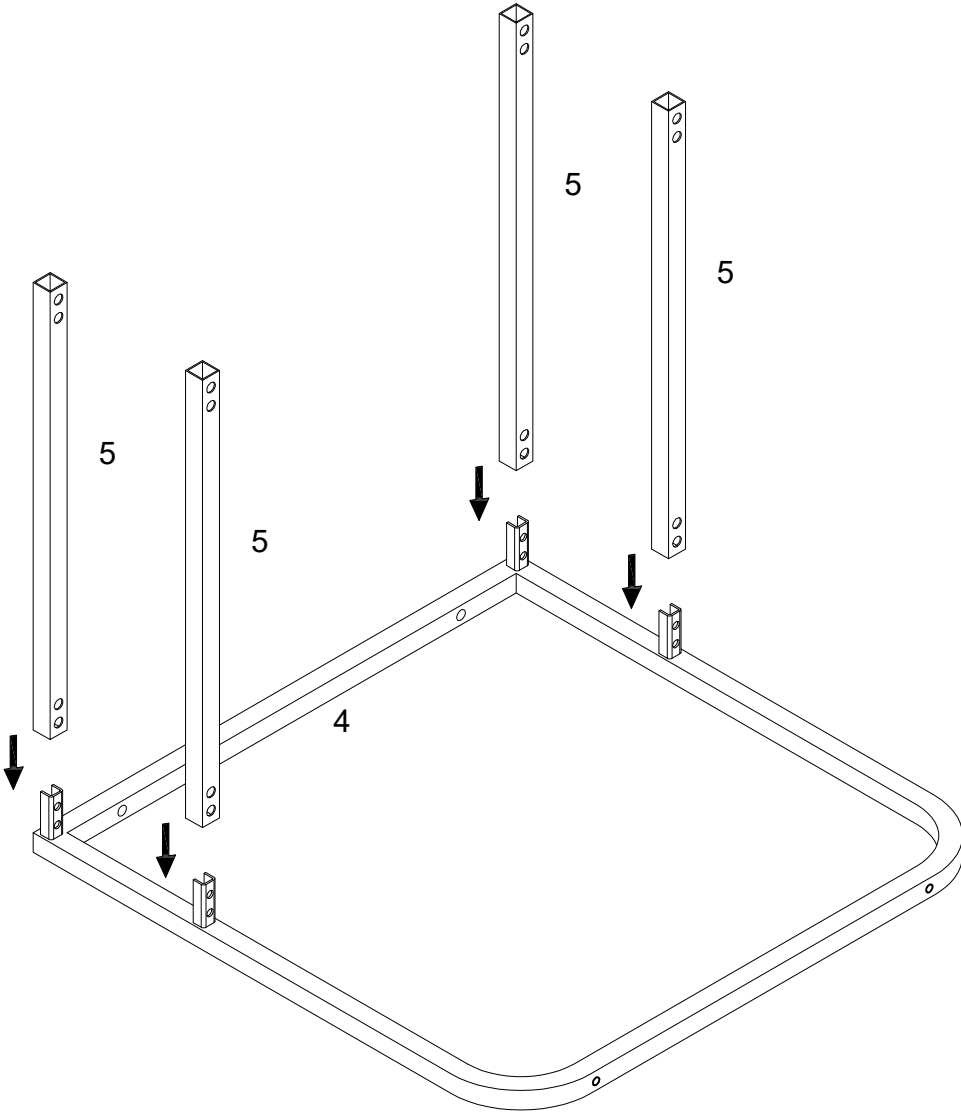

Attach part (5) to part (4) as per diagram.

Step 6

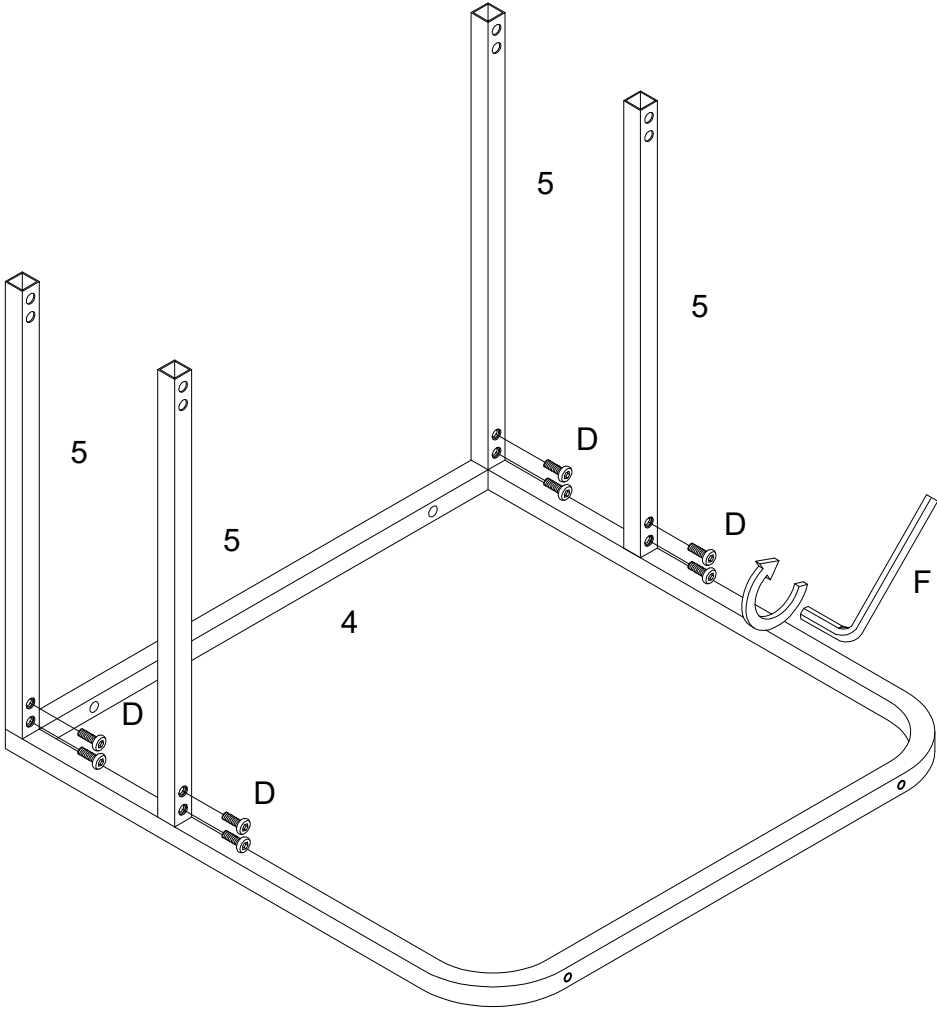

Using bolt (D) attach part (5) to part (4) with Hex key (F) as per diagram.
Note : Do not fully tighten all the bolts .

Step 7

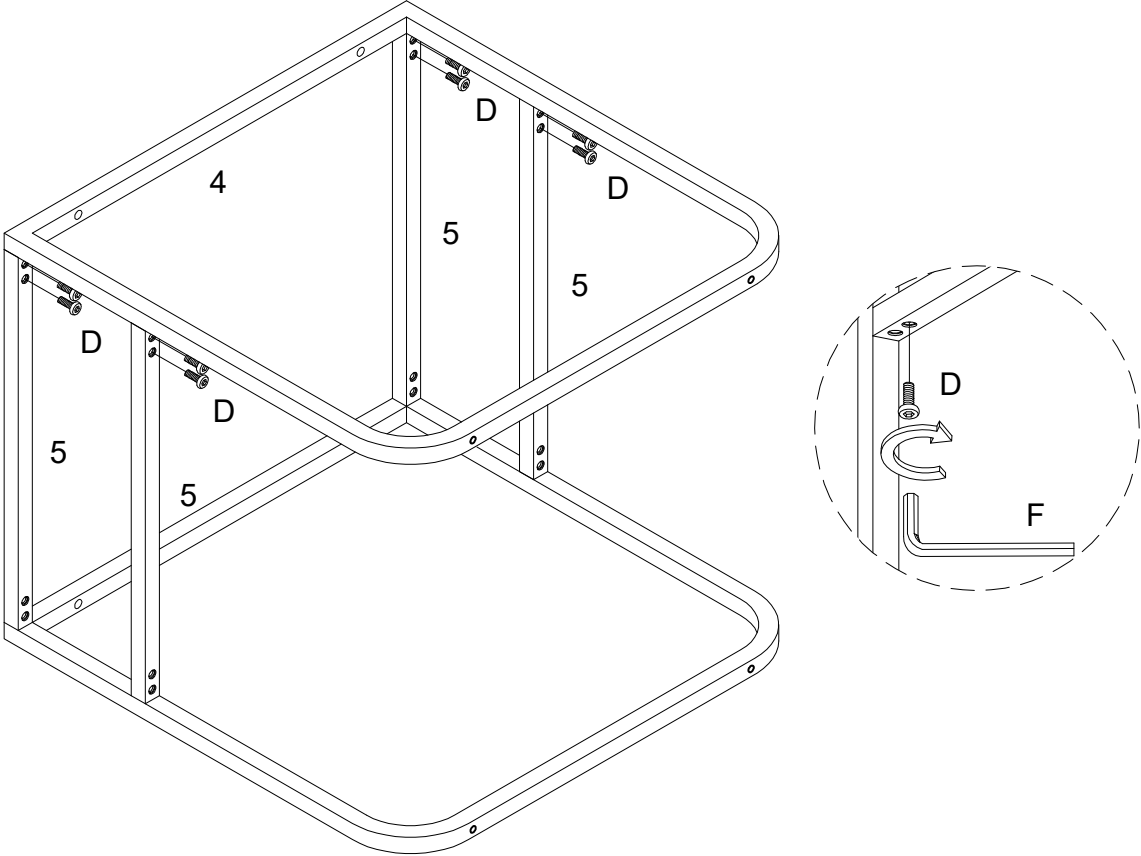

Using bolt (D) attach part (5) to part (4) with Hex key (F) as per diagram.

Step 8

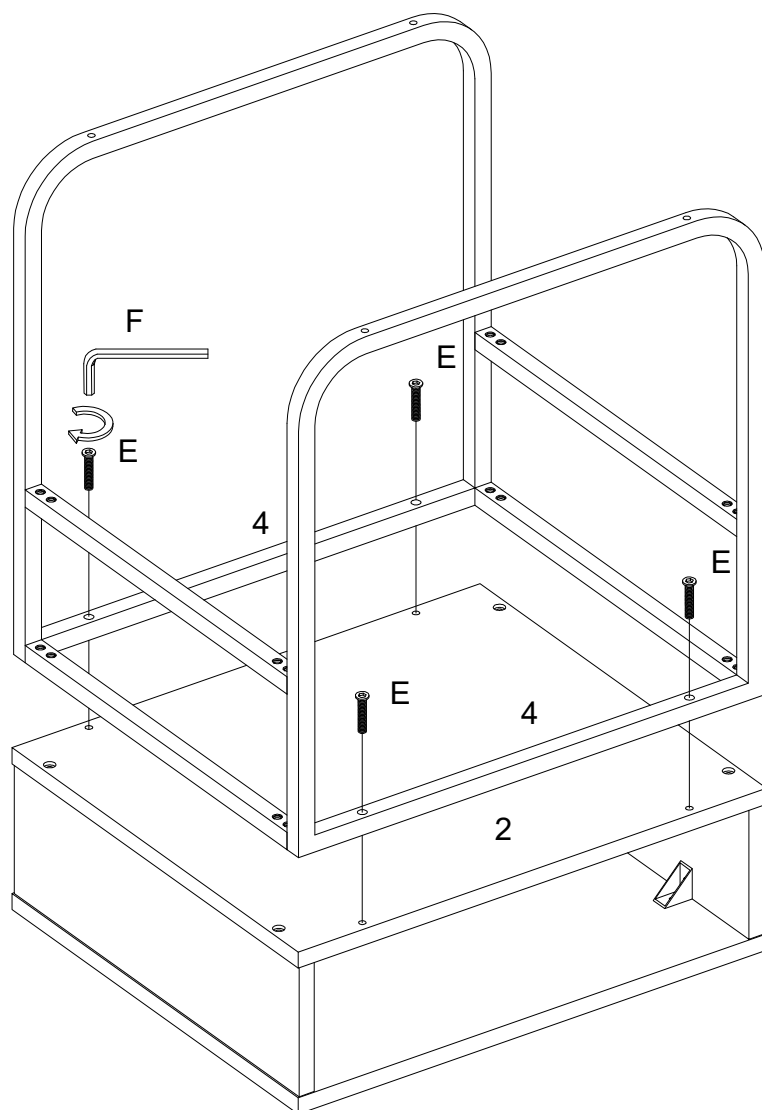

Using bolt (E) attach part (4) to part (2) with Hex key (F) as per diagram.

Note : Fully tighten all the bolts .

Step 9

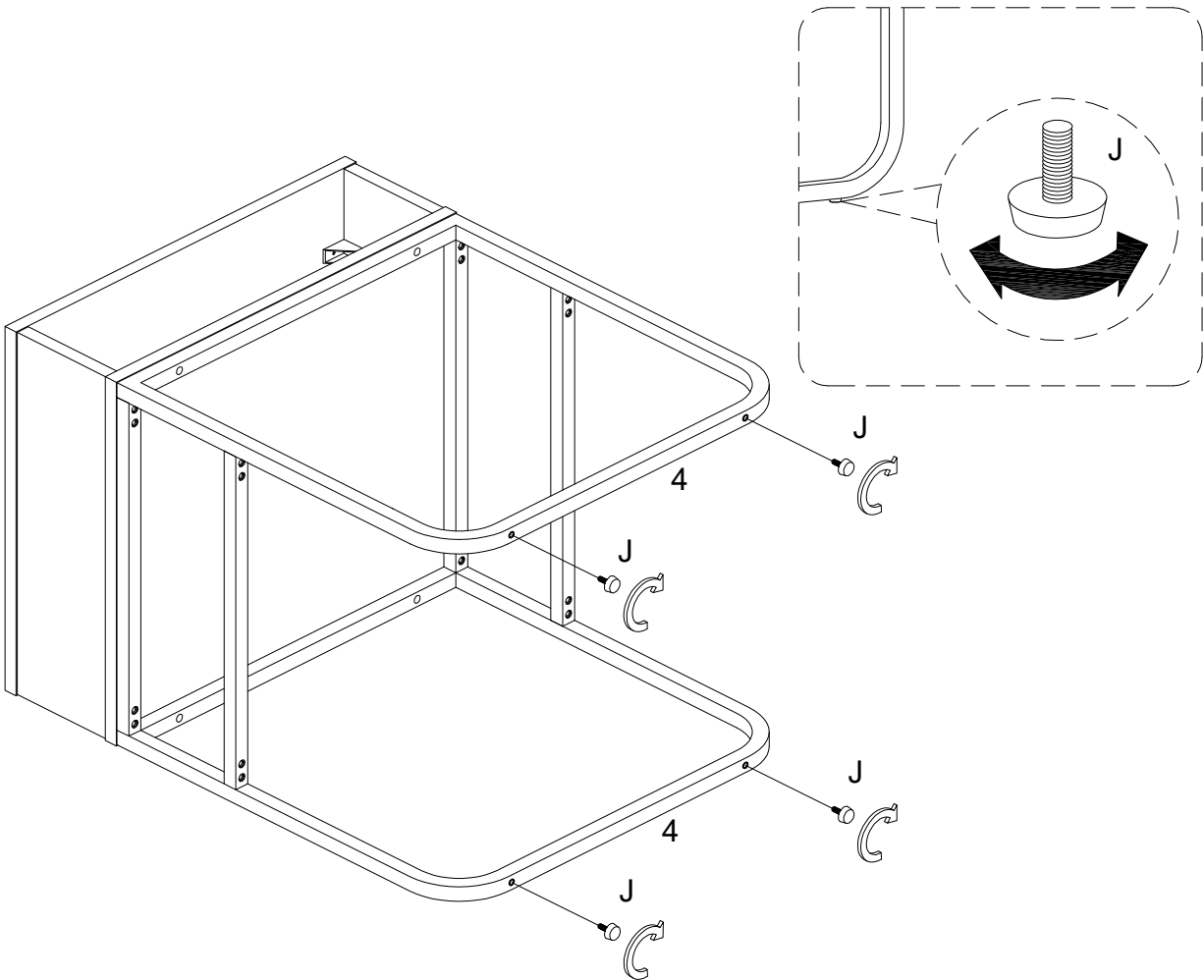

Secure adjustable floor leveler (J) into part (4) ,if necessary adjust the floor leveler at the bottom of the support leg to level the unit .

Step 10

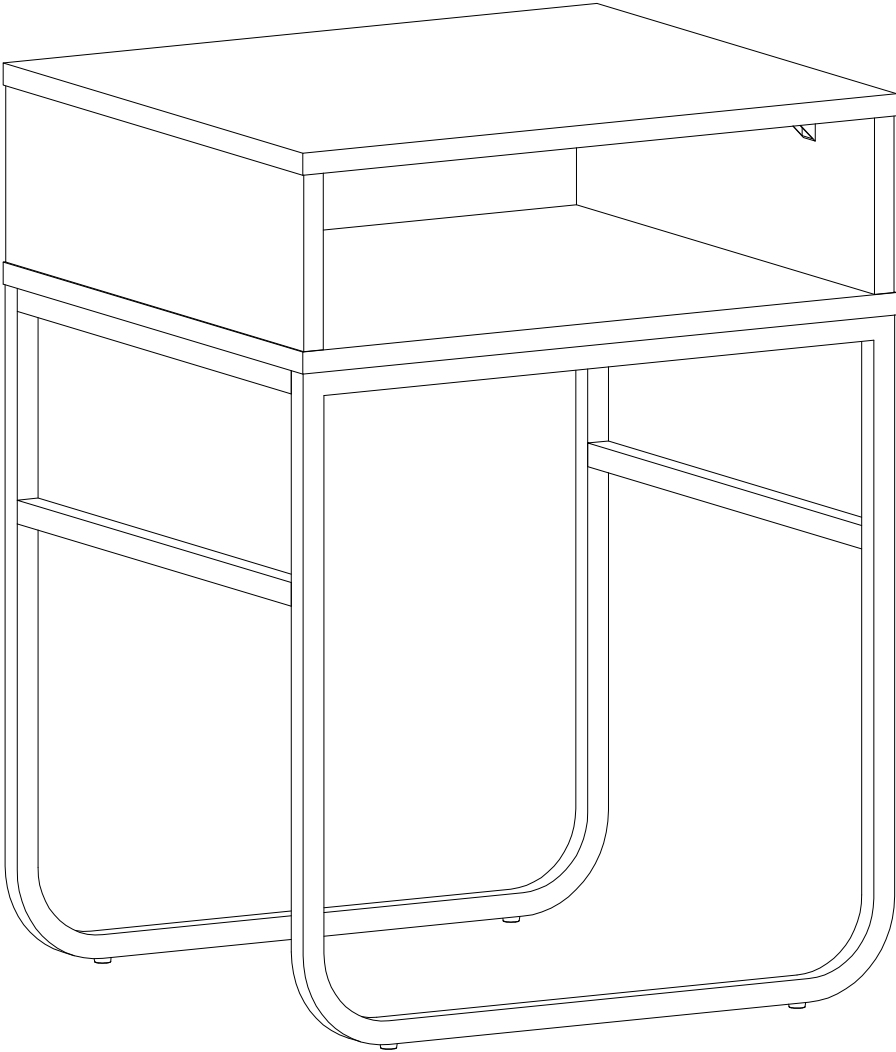

Final Assembly