

PARTS LIST / LISTE DES PIÈCES / LISTA DE PIEZAS

ITEM NO. / ARTICLE NO. / ARTICULO NO : DS-D229-049

DESCRIPTION / DESCRIPCIÓN : CHEST / COMMODE / CÓMODA

This product is not designed as a clothing unit and HAS NOT BEEN ASTM F2057-17 tested (tip test)



Serious or fatal injuries can occur from furniture tip-over. **We have provided a tip-restraint for your safety. Please install immediately and follow the guidelines below:**

- Place heavier items in bottom drawers.
- Do not set heavy items, including TVs on top of product unless product specifically allows.
- Do not allow children to climb on product, including doors, shelving and drawers.
- Open drawers individually.

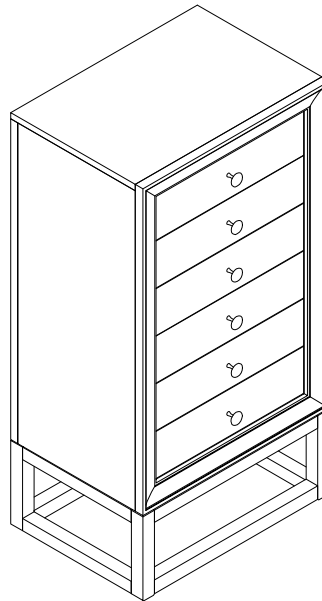
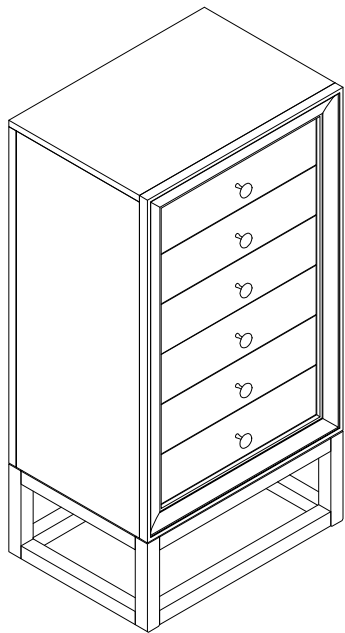

A

x1 Chest
x1 Commode
x1 Cómoda

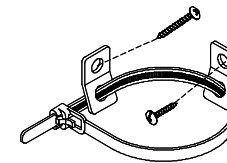

B

x1 Furniture Tipping Restraint
x1 Systeme antibasculement
x1 Control para evitar vulcos

* Replaceable Part

ASSEMBLY INSTRUCTIONS / NOTICE DE MONTAGE / INSTRUCCIONES DE MONTAJE

ITEM NO. / ARTICLE NO. / ARTICULO NO : DS-D229-049

DESCRIPTION / DESCRIPCIÓN : CHEST / COMMODE / CÓMODA

This product is not designed as a clothing unit and HAS NOT BEEN ASTM F2057-17 tested (tip test)



Serious or fatal injuries can occur from furniture tip-over. **We have provided a tip-restraint for your safety. Please install immediately and follow the guidelines below:**

- Place heavier items in bottom drawers.
- Do not set heavy items, including TVs on top of product unless product specifically allows.
- Do not allow children to climb on product, including doors, shelving and drawers.
- Open drawers individually.

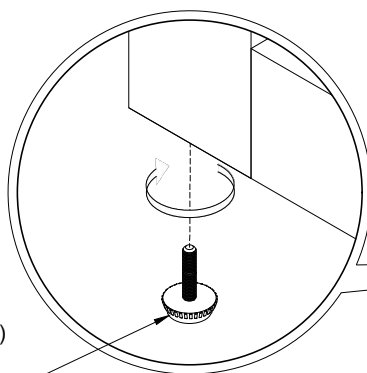
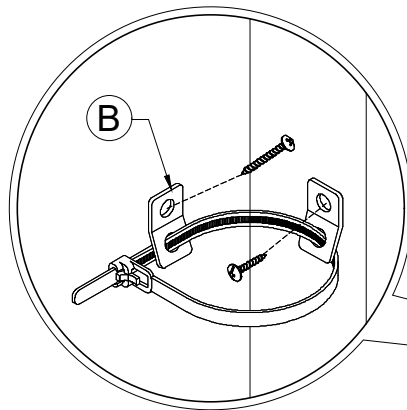
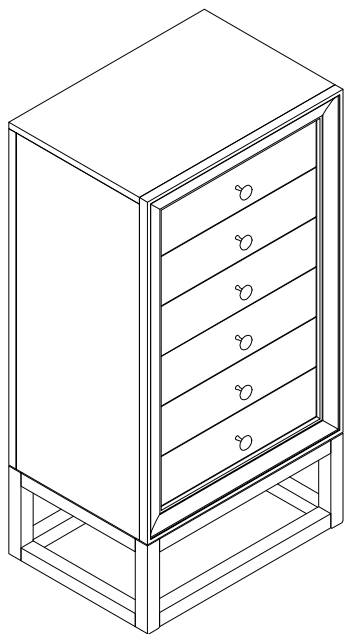

Adjustable leveler (4pcs)
Patin réglable (×4)
Nivelador ajustable(x4)

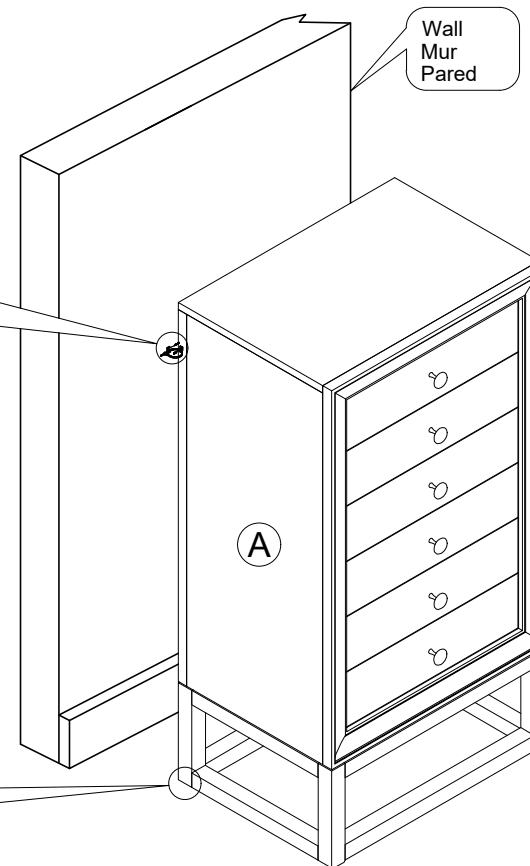

* Replaceable Part

REPLACEABLE / PARTIE REMPLAÇABLE / PARTE REEMPLAZABLE

ITEM NO. / ARTICLE NO. / ARTICULO NO : DS-D229-049

DESCRIPTION / DESCRIPCIÓN : CHEST / COMMODE / CÓMODA

This product is not designed as a clothing unit and HAS NOT BEEN ASTM F2057-17 tested (tip test)



Serious or fatal injuries can occur from furniture tip-over. **We have provided a tip-restraint for your safety. Please install immediately and follow the guidelines below:**

- Place heavier items in bottom drawers.
- Do not set heavy items, including TVs on top of product unless product specifically allows.
- Do not allow children to climb on product, including doors, shelving and drawers.
- Open drawers individually.

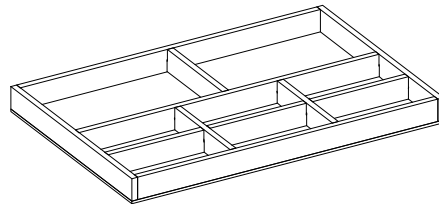
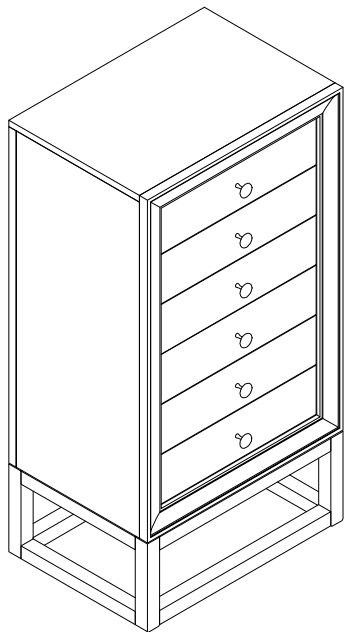

x6 RDS229-049-TRAY - Jewelry tray *
Plateau de bijoux
Bandeja de joyas

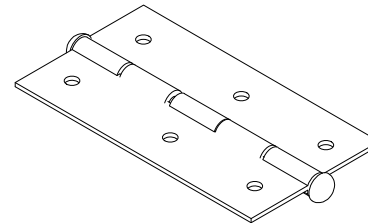

x6 RDS229-049-HINGE - Hinge *
Charnière
Bisagra

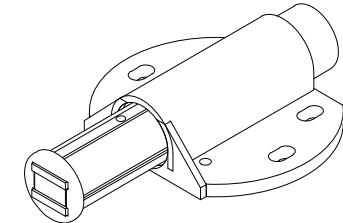

x2 RDS229-049-CATCH - Magnet Catch *
Catch de aimant
Captura de imán

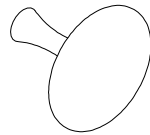

x6 RDS229-049-KNOB - Knob with Screw *
Poignée et vis
Tirador y Tornillo

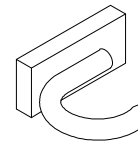

x28 RDS229-049-HOOK - Hook with Screw *
Crochet et vis
Gancho y Tornillo



x6 COMGLIDE-12-45 - Glide *
Glissière
Carril de deslizamiento

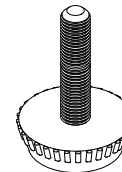

x4 RC-FG-BLACK - Black leveler *
Patin réglable
Nivelador

* Replaceable Part