

Assembly Instructions

ALBY Office Chair

PLEASE NOTE: Check that you have received all components and hardware before assembling. If you are missing any parts, contact your retailer

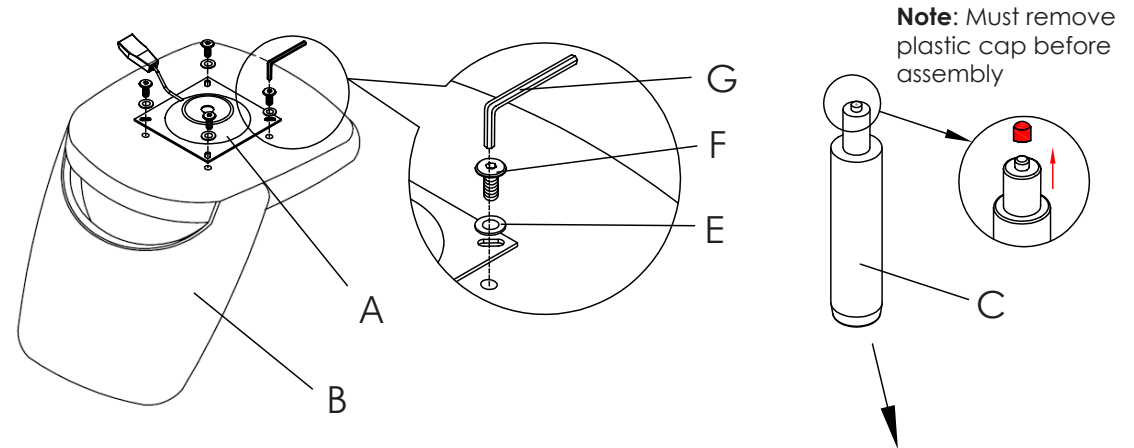
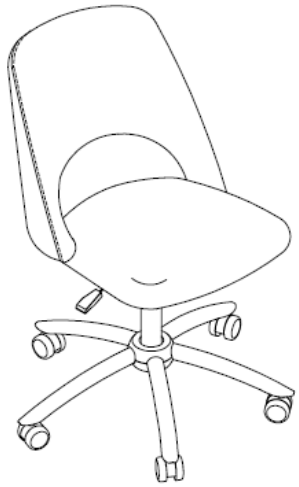

A (1 pc)



B (1 pc)



C (1 pc)

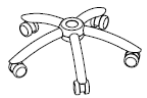

D (1 pc)



E (4 pcs)



F (4 pcs)

Ø16xØ6

M6 x 16mm



G (1 pc)

4mm

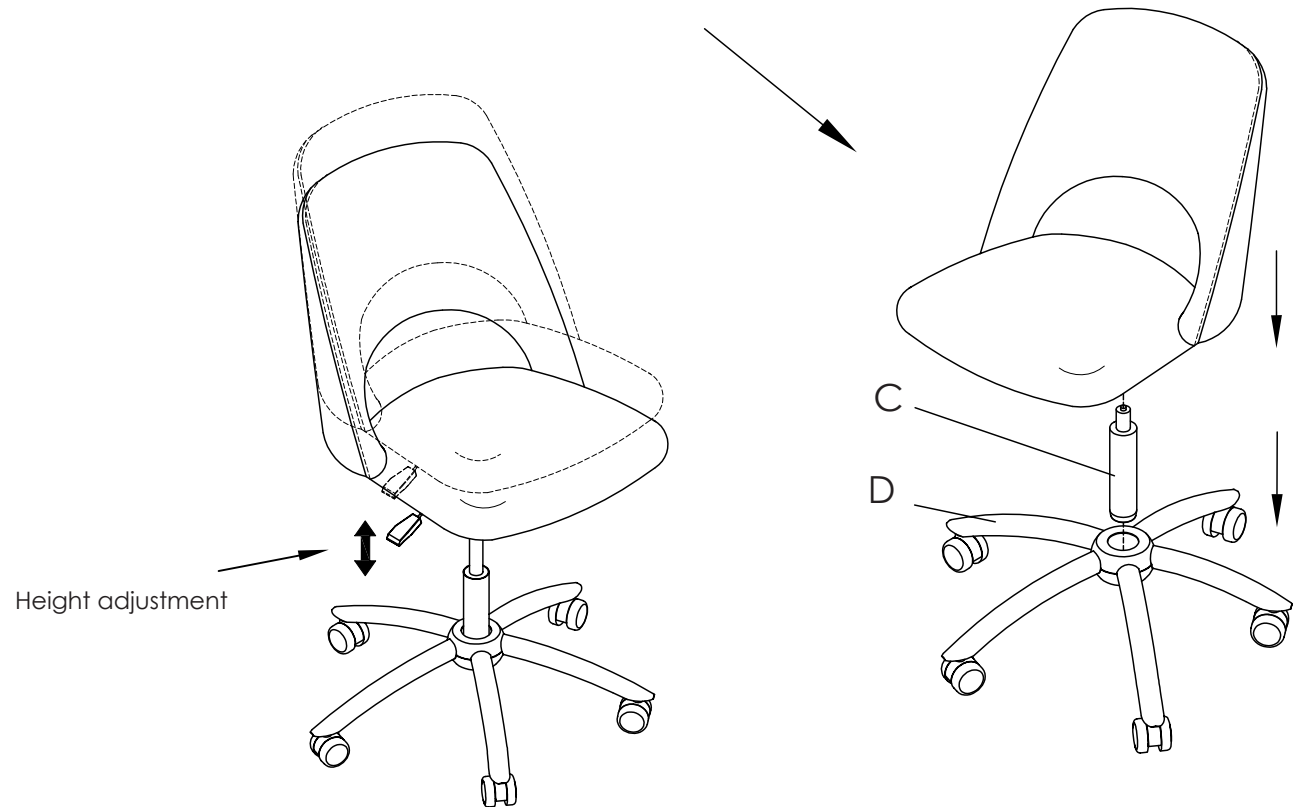

During assembly, hand tighten screws only. When the screws are in place, tighten completely.