



Assembly Instructions

RETG 1422-02 END TABLE - SKU# 23014208

Manufactured by RETG for Rooms To Go

Version#1 - 10/07/2025

***** Caution : Please read all instructions carefully before starting the assembly process. These parts are cumbersome and heavy. Therefore, two people are recommended in order to prevent personal injury and insure the parts are not damaged during the assemble.**

PARTS LIST

No.	Description	Sketch	Q'ty
1	Table top		1 Pc
2	Table base		1 Pc
3	Right Table legs		2 Pcs
4	Left Table legs		2 Pcs

HARDWARE LIST

No.	Description	Zize	Sketch	Q'ty
A	Allen Key Z	M4		1 Pc

HARDWARE LIST			Q'ty
Pre-installed on Part 1&2	Allen Bolt Ø5/16" x 18 x 2-1/4" Pre-installed		12 Pcs
	Spring Washer Ø5/16" Pre-installed		12 Pcs
	Flat Washer Ø5/16" Pre-installed		12 Pcs
	Threaded Washer Ø5/16"- 18 x 10mm Pre-installed		12 Pcs

Remark:

+ Do not fully tighten all bolts until assembly is complete

STEP 1:

Place the Table top (1) on a padded area, Remove the drawers from the table top: Fully extend the drawer, then press the plastic tab down on the right and up on the left at the same time as shown below. While holding the tabs pressed down/up, pull the drawer out.

STEP 2: Flip the Table top (1) upside down. Place a blanket or some form of padding underneath of the top when placing on a hard surface to avoid scratches. Place Right Table legs (3) and Left Table legs (4) so that it fits the redetermined pin holes in back panel of Table top (1). Use an Allen key Z(A) to tighten the bolts which were pre-installed on the table corners.

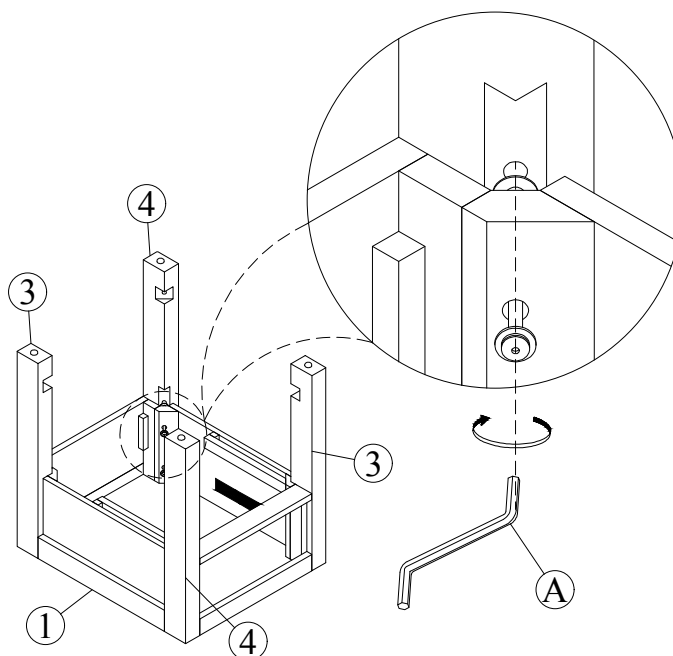
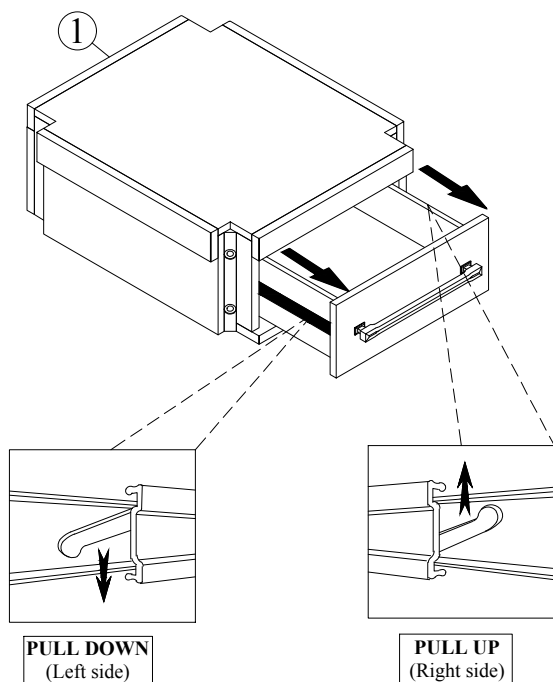

Hardware Pack Location (s):

RETG 1422-02 END TABLE - SKU#23014208



Assembly Instructions

RETG 1422-02 END TABLE - SKU# 23014208

Manufactured by RETG for Rooms To Go

Version#1 - 10/07/2025

***** Caution : Please read all instructions carefully before starting the assembly process. These parts are cumbersome and heavy. Therefore, two people are recommended in order to prevent personal injury and insure the parts are not damaged during the assemble.**

STEP 3:

Turn the Table base (2) upside down into the holes marked on the Right Table legs (3) and Left Table legs (4) assembly. Use the Z-wrench (A) to tighten the bolts that are already installed on the table corners.

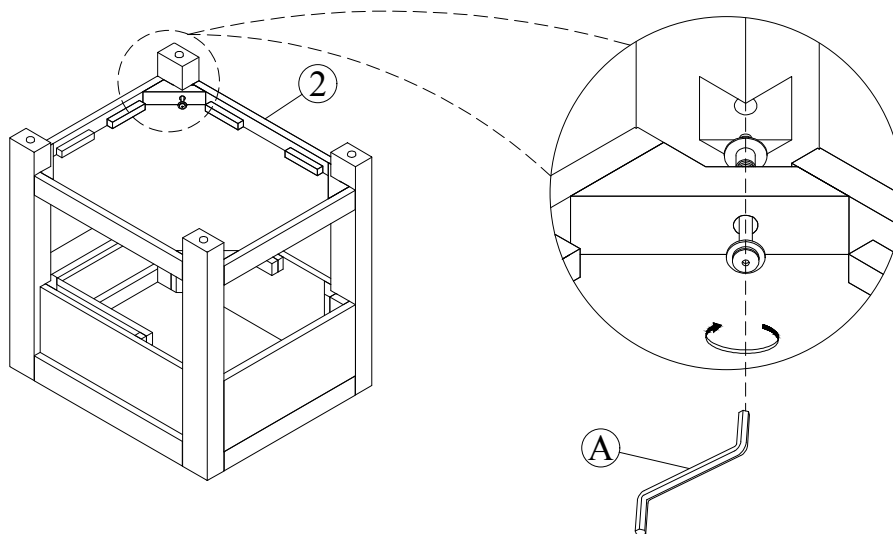

STEP 4:

Turn the table to the upright position.
Re-installed all the drawers in the table top. Fully extend the slides from the case. Then align the slides on the drawer to the slides on the case as shown. Push the drawer back in. You may have to slide the drawer in and out several times in order to properly align the ball bearings.

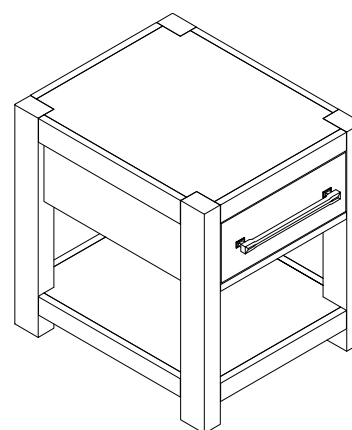
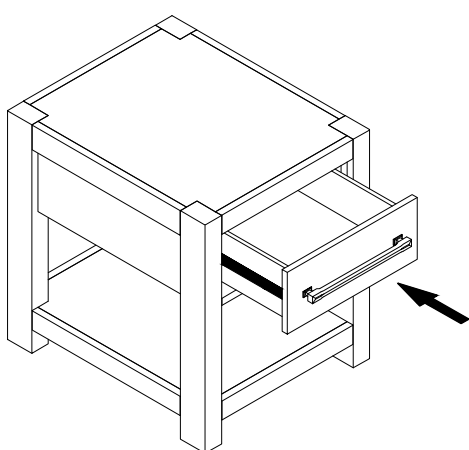

COMPLETE ASSEMBLY

Hardware Pack Location (s):

RETG 1422-02 END TABLE - SKU#23014208