

- ⚠ WARNING:** To avoid serious personal injury:
- Carefully and strictly follow assembly instructions. Improper assembly of furniture can result in structural failure, instability of the product, or tip-over.
 - Monitor and carefully control the assembly components. These include small parts and hardware that may present a choking hazard to small children. Furniture should be assembled only by responsible adults and children should not be involved in the assembly process.
 - Where provided, wall mounting hardware should always be used as prescribed in these instructions to anchor furniture to walls. Proper use of the wall mounting hardware can significantly reduce the potential for furniture tip-over and crushing injuries.

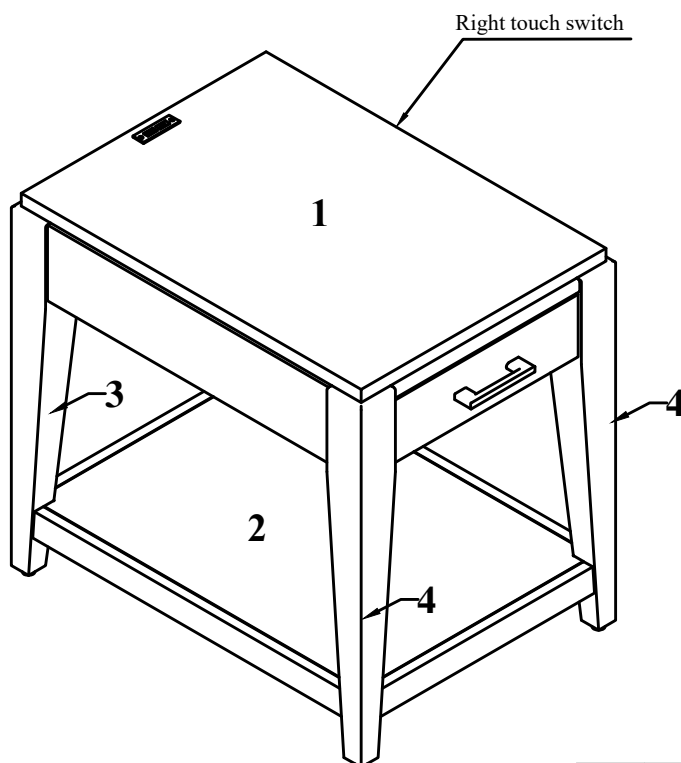

LIST OF PARTS AND HARDWARE:				
No.		Description		Q'ty
A		Hex Nut	Φ5/16"*(6mm)	10
B		Flat washer	Φ5/16"*16*1.5mm	10
C		Lock washer	Φ5/16"	10
D		Allen wrench	Φ5/16"	1
1		Table Top		1
2		Table Leaf		1
3		Back Leg		2
4		Front Leg		2
5		USB		1
		Tools Required (Not Included)		

NOTE:
ASSEMBLE UNIT ON A SOFT SURFACE.
ASSEMBLEZ L'UNITÉ SUR UNE SURFACE MOLLE.

DO NOT TIGHTEN BOLTS UNTIL THE UNIT IS COMPLETELY ASSEMBLED.
NE SERREZ PAS LES BOULONS JUSQU' À CE QUE L'UNITÉ SOIT COMPLÈTEMENT ASSEMBLÉE

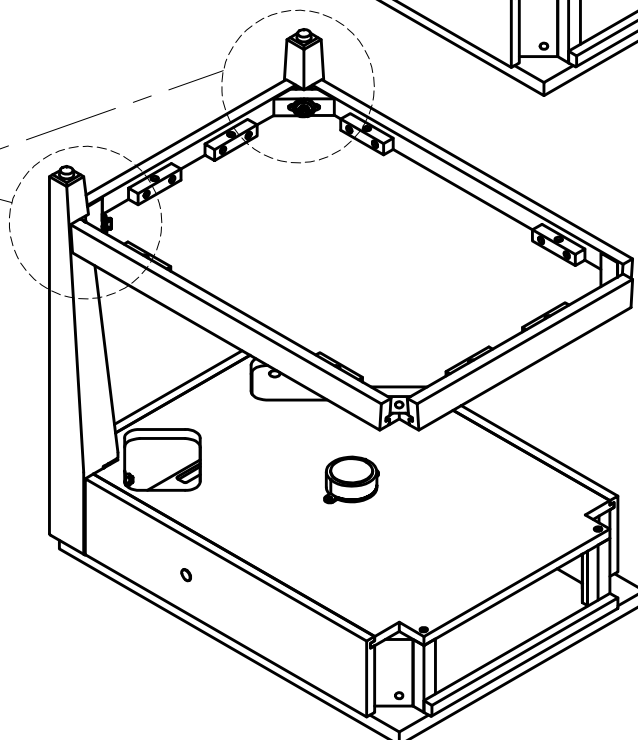
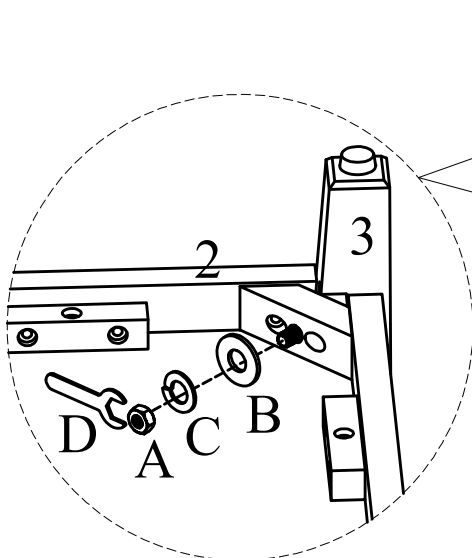
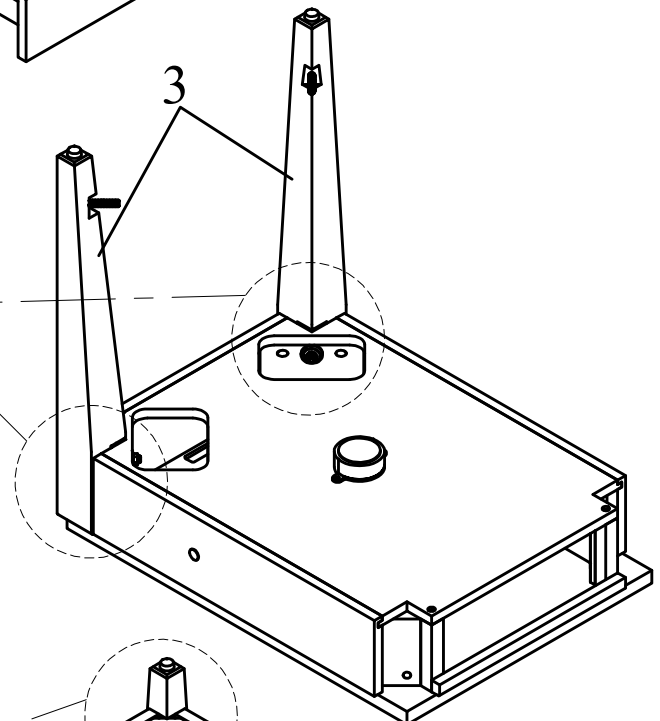
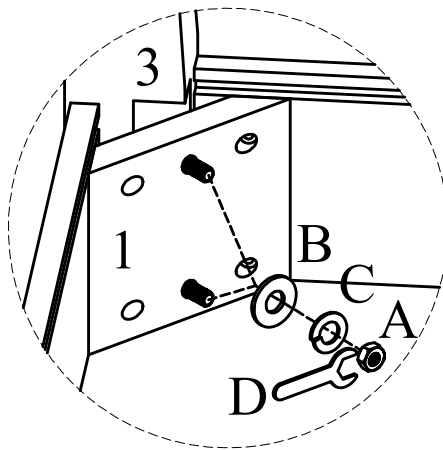
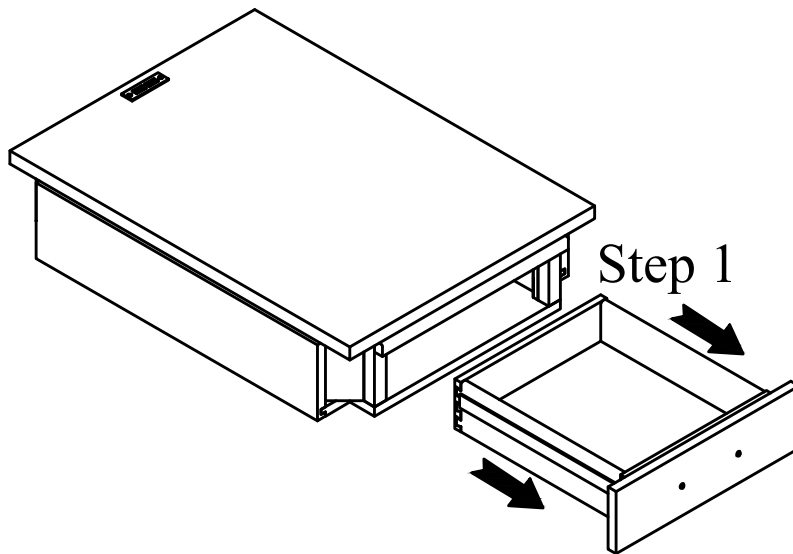

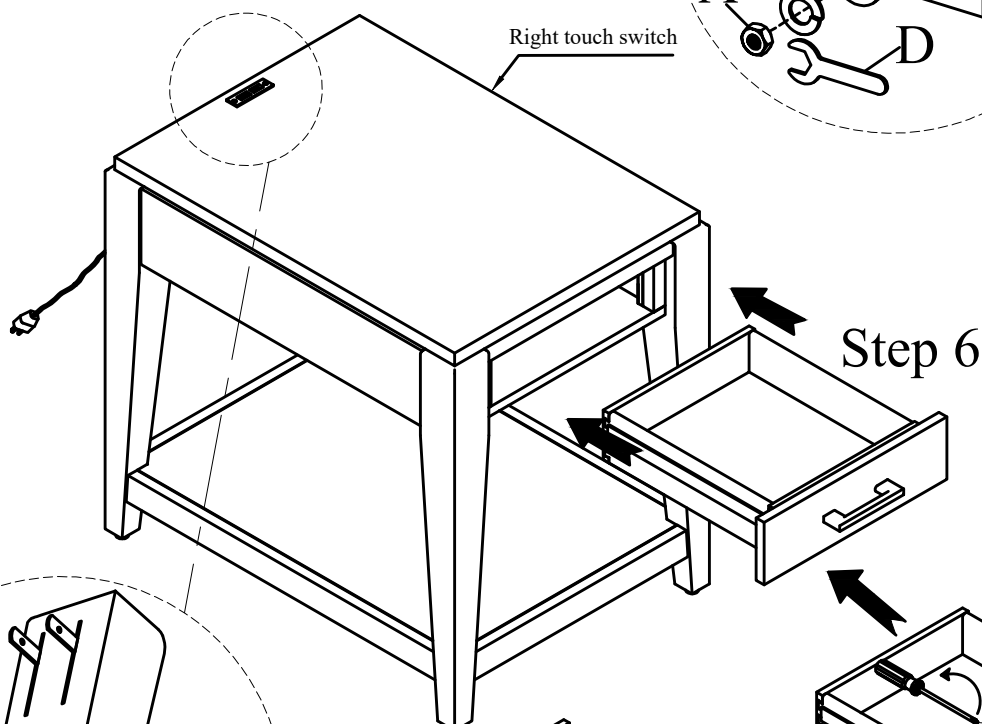
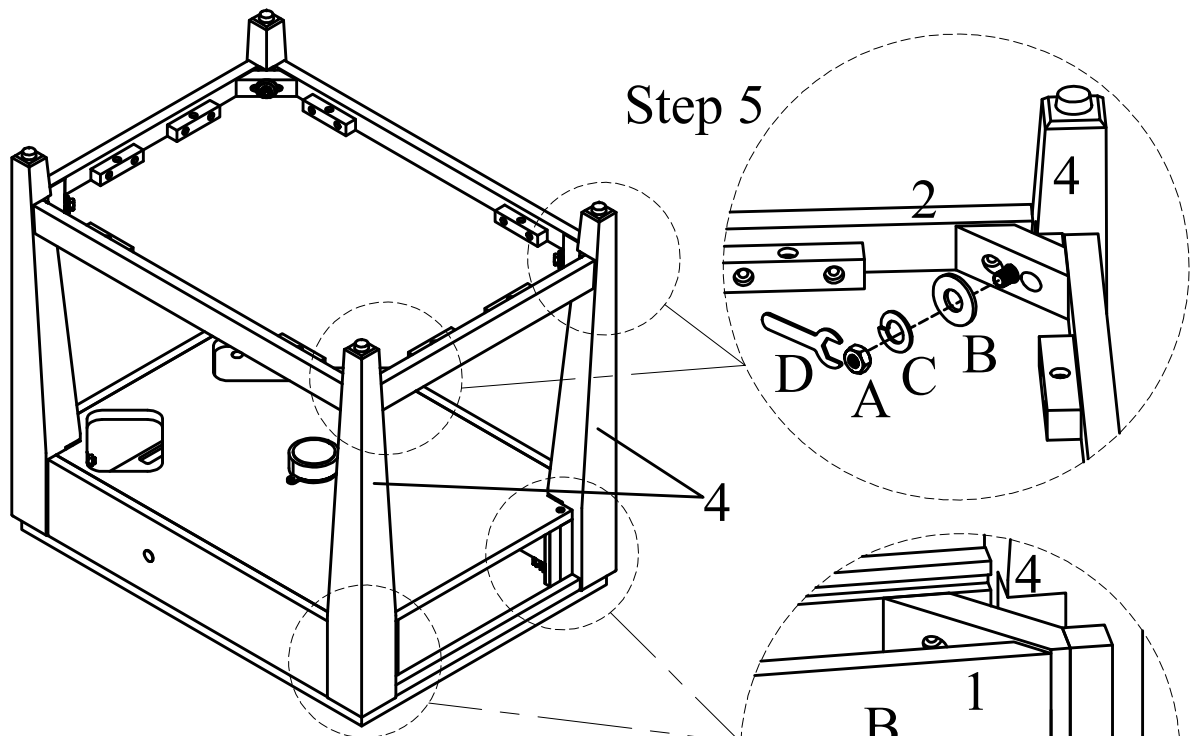

Step 7

