

# TV CONSOLE

## ASSEMBLY INSTRUCTIONS MODEL No. AVA249

**Important:** Be sure to check all packing material carefully for small parts which may come loose inside carton during shipment. Separate, identify and count all parts and metal hardware. Compare with part list and hardware illustrations to be sure all parts are present. If any part(s) is missing or damaged contact your dealer's customer services department. For efficient and fast service, please indicate the model number and the part needed.

**ATTENTION:** Some lettered parts listed on the instruction sheets may not be in the parts bag, they may already be assembled.

### TOOLS REQUIRED

(Not included)  
Phillips Screwdriver

### HARDWARE:



ANTI-TIP  
Part No. HB-488 (1 Pc)



P.H. SCREW 6 x 1/2"  
Part No. HCPF-0612P (2 Pcs)



SUPPORT RAIL  
Part No. TOP44POP-0126  
**ATTACHED ON THE SHELF**

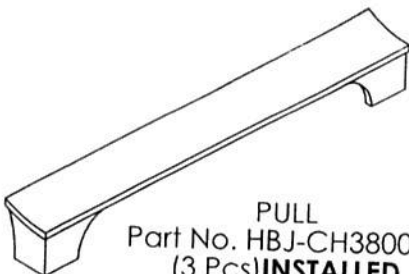

PULL  
Part No. HBJ-CH3800MS  
(3 Pcs) **INSTALLED**



BOLT 8/32 X7/8" Part No.  
HCPP-078A  
(6 Pcs) **INSTALLED**



HOLE PLUG  
Part No. HCPH-STDT  
(2 Pcs) **INSTALLED**

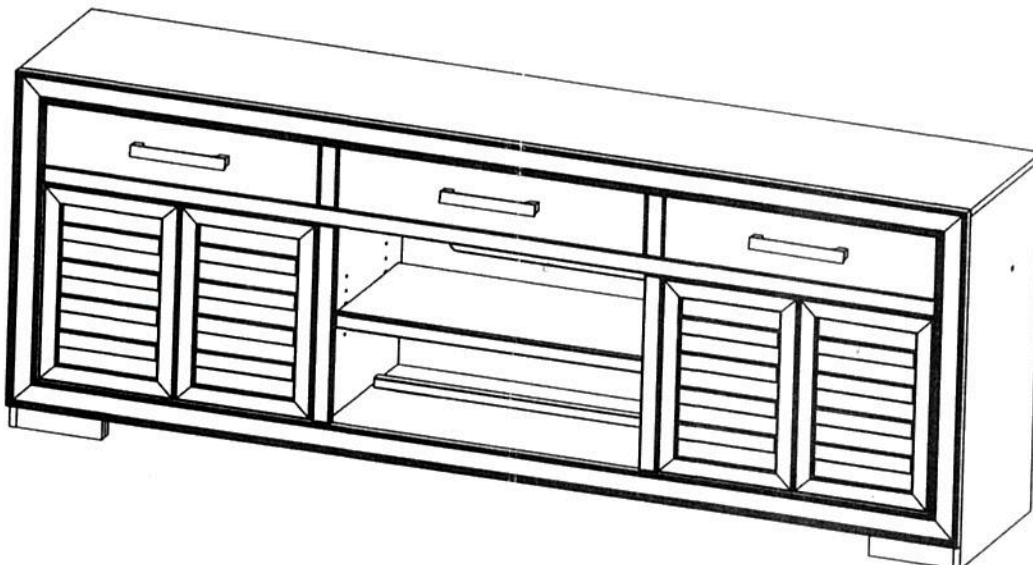

# FIRE PLACE 27" INSTALLATION

## Step 1.

Detach the **rail support** from the shelf.

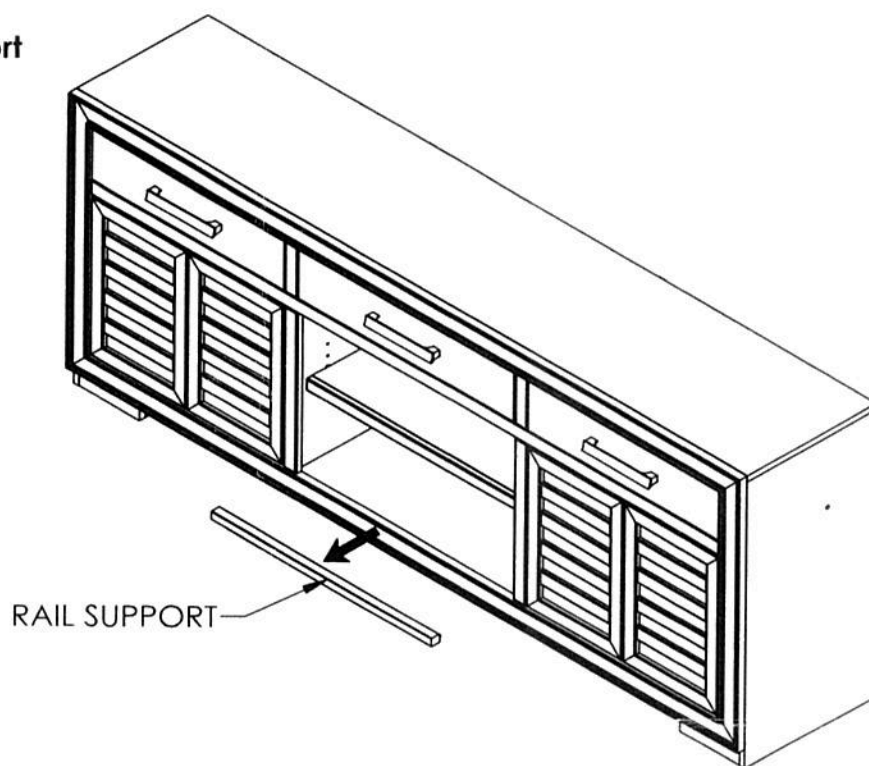

## Step 2.

Remove the central **back panel** and detach the **shelf** using a screwdriver as shown in page 4.

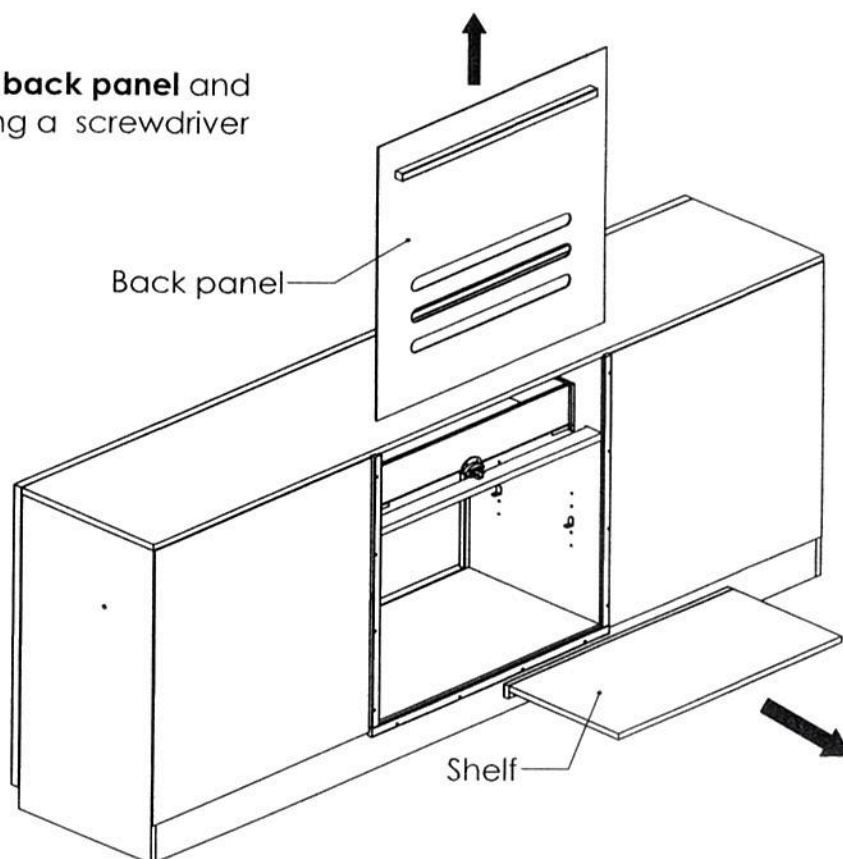

# FIRE PLACE INSTALLATION

## Step 3.

Place the fireplace inside the cabinet and install the support rail behind the fireplace using screws (**HCPF-0612P**) and **screwdriver**.

Slide the panel back in.

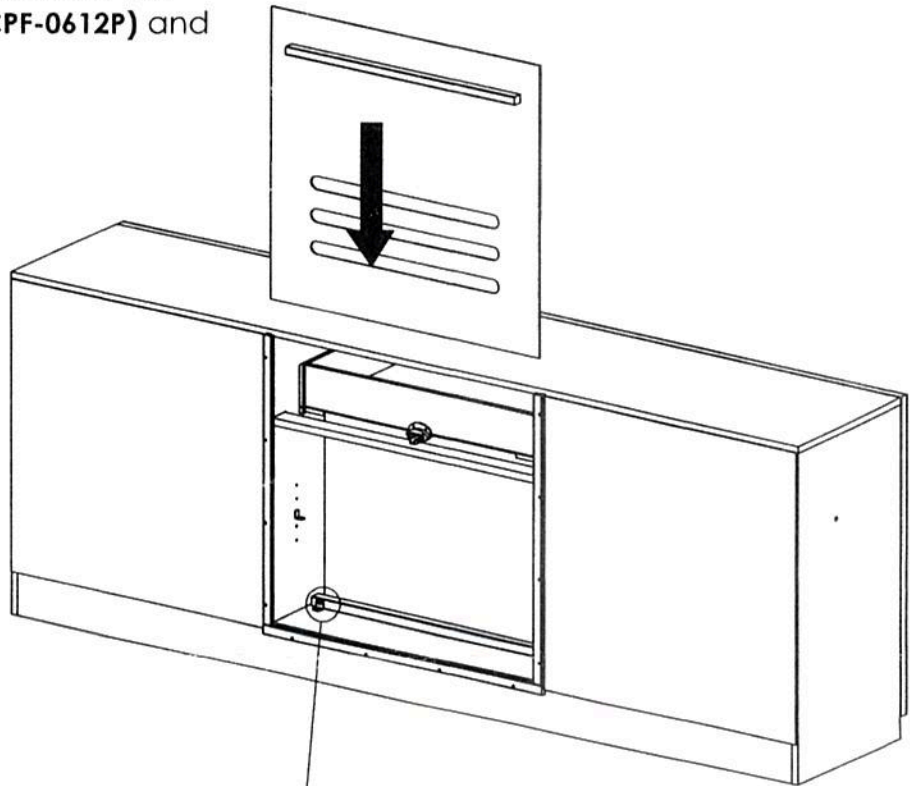

**FIREPLACE 27" NOT INCLUDED**

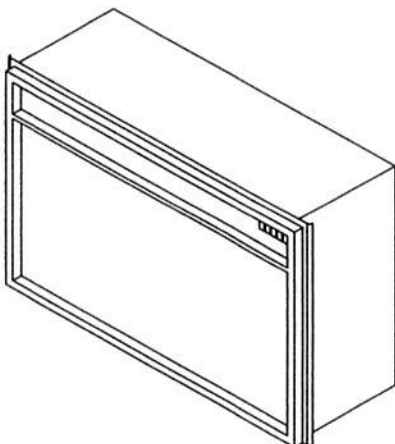

SCREW  
**HCPF-0612P**

# INSTRUCTIONS SHEET

## ADJUSTABLE WOOD SHELF

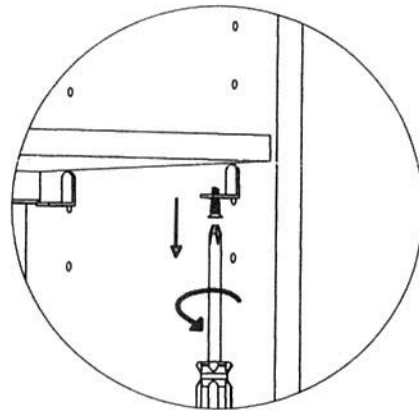
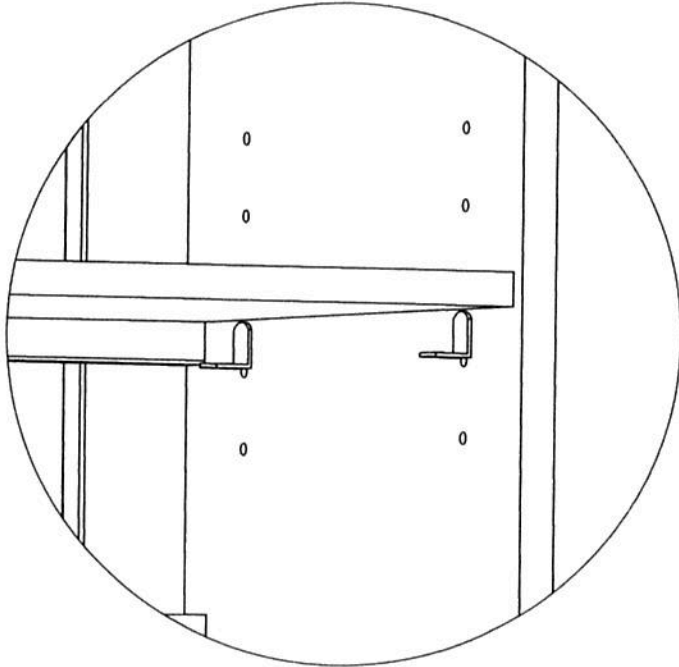

STEP 1.

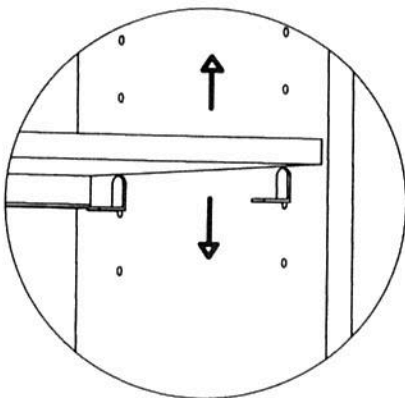

STEP 2.

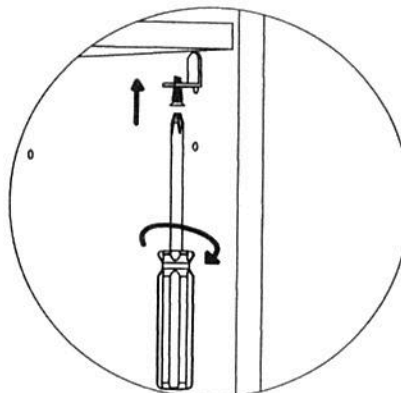

STEP 3.