



Assembly Instructions

RETG 1420-06 80" CONSOLE - SKU# 24120230

Manufactured by RETG for Rooms To Go

Version#1 - 05/09/2024

USE AND CARE INSTRUCTIONS

⚠ WARNING -Children have died from furniture tip over. To reduce the risk of furniture tip over, adhere to the recommendations below.

- For use with televisions weighing 235lbs/ 106.6kgs or less. Use with heavier televisions may result in instability causing tip over resulting in death or serious injury.
- Plasma/LCD-flat panel TV screen of various screen size to a maximum TV screen size 75 inches
- All other support shelves should not be loaded more than 25 lbs/ 11.3 kgs
- All drawers should not be loaded more than 25 lbs/ 11.3 kgs
- Always place TV no more than two inches from the back edge of the console. Placing TV more than two inches from the back edge may increase the risk that the console will tip over.

DO NOT REMOVE THIS LABEL.

⚠ WARNING -Death or serious injury may occur when children climb on audio and/or video equipment furniture. A remote control or toys placed on the furnishing may encourage a child to climb on the furnishing and as a result the furnishing may tip over on to the child.

⚠ AWARNING - Relocating audio and/or video equipment to furniture not specifically designed to support audio and/or video equipment may result in death or serious injury due to the furnishing collapsing or overturning onto the child.

Hardware Pack Location (s):

RETG 1420-06 80" CONSOLE - SKU# 24120230



Assembly Instructions

RETG 1420-06 80" CONSOLE - SKU# 24120230

Manufactured by RETG for Rooms To Go

Version#1 - 05/09/2024

***** Caution : Please read all instructions carefully before starting the assembly process. These parts are cumbersome and heavy. Therefore, two people are recommended in order to prevent personal injury and insure the parts are not damaged during the assemble.**

PARTS LIST

No.	Description	Sketch	Q'ty
1	80" Console		1 Pc
2	Media pier (Sold Separately)		2 Pcs
3	Firebox (Sold Separately)		1 Pcs

HARDWARE LIST

No.	Description	Zize	Sketch	Q'ty
B	Metal Bracket	50 x 20 x 3mm		4 Pcs
C	Allen Bolt	Ø1/4" x 20 x 1"		8 Pcs
	Lock Washer	Ø1/4"		
	Flat Washer	Ø1/4" x 5/8"		
D	Allen Key Z	M4		1 Pc

ANTI TIPPING KIT LIST

No.	Description	Sketch	Q'ty
A	Tipping Restraint		1 Set

TOOLS REQUIRED (NOT PROVIDED)

Description	Sketch
Phillips screwdriver	

▲ WARNING - Death or serious injury may occur when children climb on audio and/or video equipment furniture. Remote control or toys placed on the furnishing may encourage a child to climb on the furnishing and as a result the furnishing may tip over on to the child.

▲ WARNING - Relocating audio and/or video equipment to furniture not specifically designed to support audio and/or video equipment may result in death or serious injury due to the furnishing collapsing or over turning onto the child.

Manufactured by RETURN GOLD INTERNATIONAL CO., LTD.

Address: HAMLET 3, KHANH BINH VILLAGE,
TAN UYEN DISTRICT, BINH DUONG PROVINCE,
VIET NAM.

▲ WARNING

- For use with televisions weighing 235lbs/106.6Kgs or less. Use with heavier televisions may result in instability causing tip over resulting in death or serious injury.

- Plasma/LCD-flat panel TV screen of various screen size to a maximum TV screen size 75 inches.

- Each shelf should not be loaded more than 25lbs/11.3Kgs.

- DO NOT EXCEED RECOMMENDED LOAD. Use with products heavier than the maximum sizes and weights indicated may result in instability causing possible injury.

- Do not allow children under 16 years to move unit.

- Always place TV no more than two inches from the back edge of the console.

Placing TV more than two inches from the back edge may increase the risk that the console will tip over.

DO NOT REMOVE THIS LABEL.

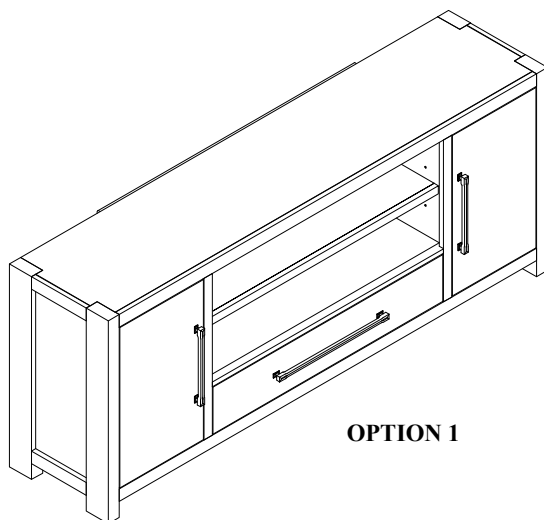

OPTION 1

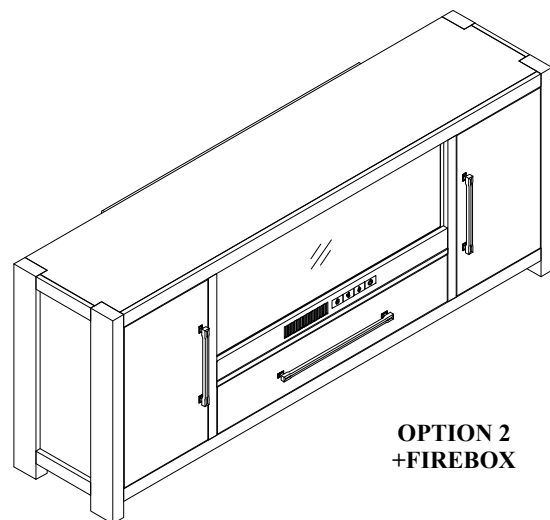

OPTION 2
+FIREBOX

Hardware Pack Location (s):

RETG 1420-06 80" CONSOLE - SKU# 24120230



Assembly Instructions

RETG 1420-06 80" CONSOLE - SKU# 24120230

Manufactured by RETG for Rooms To Go

Version#1 - 05/09/2024

*** **Caution :** Please read all instructions carefully before starting the assembly process. These parts are cumbersome and heavy. Therefore, two people are recommended in order to prevent personal injury and insure the parts are not damaged during the assemble.

OPTION 1

STEP 1: Position 80" Console in its desired location.
Refer to the assembly instructions of Anti tipping kits to fix 80" Console to the wall. See **Step 1**.

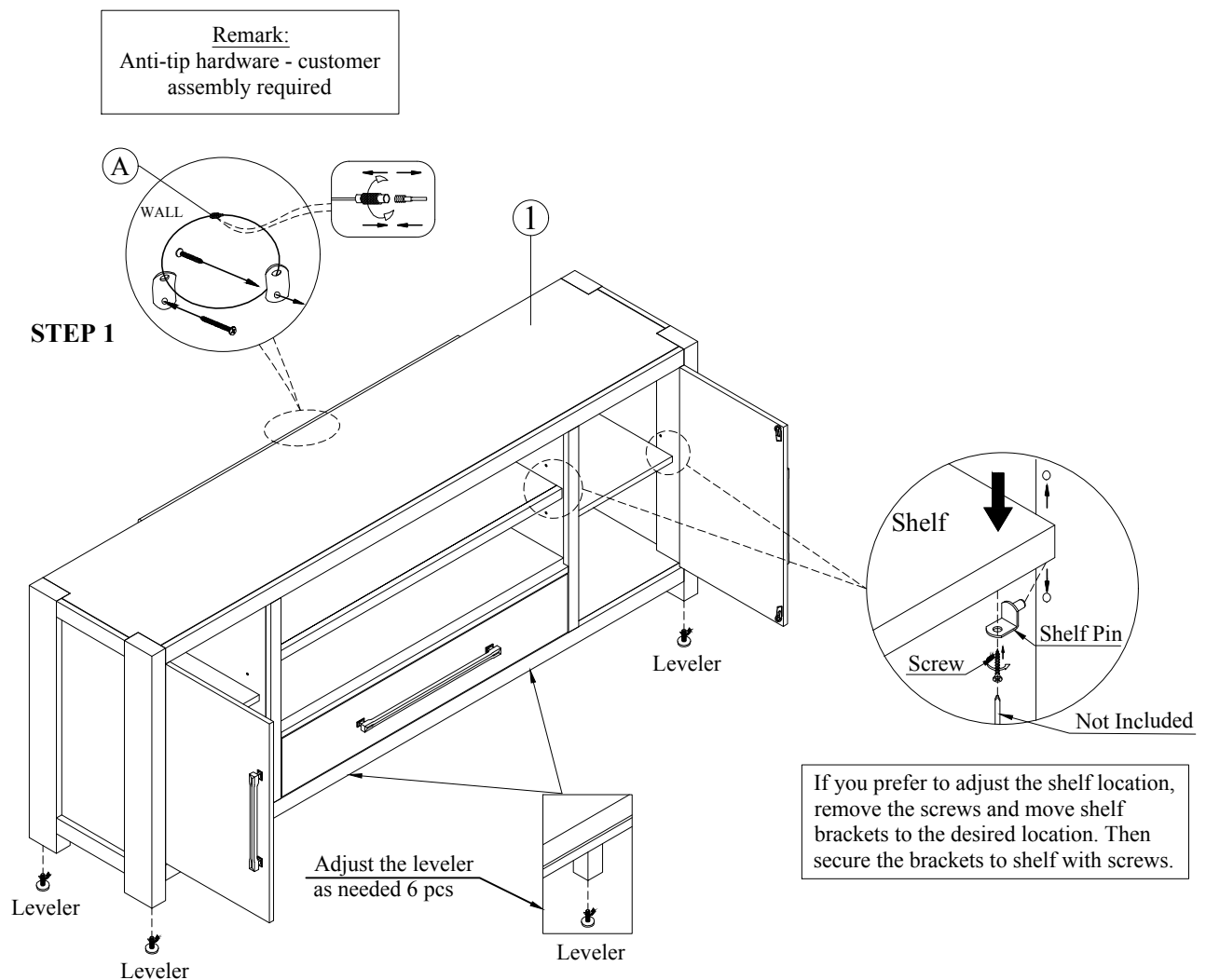

Hardware Pack Location (s):

RETG 1420-06 80" CONSOLE - SKU# 24120230



Assembly Instructions

RETG 1420-06 80" CONSOLE - SKU# 24120230

Manufactured by RETG for Rooms To Go

Version#1 - 05/09/2024

***** Caution : Please read all instructions carefully before starting the assembly process. These parts are cumbersome and heavy. Therefore, two people are recommended in order to prevent personal injury and insure the parts are not damaged during the assemble.**

OPTION 1

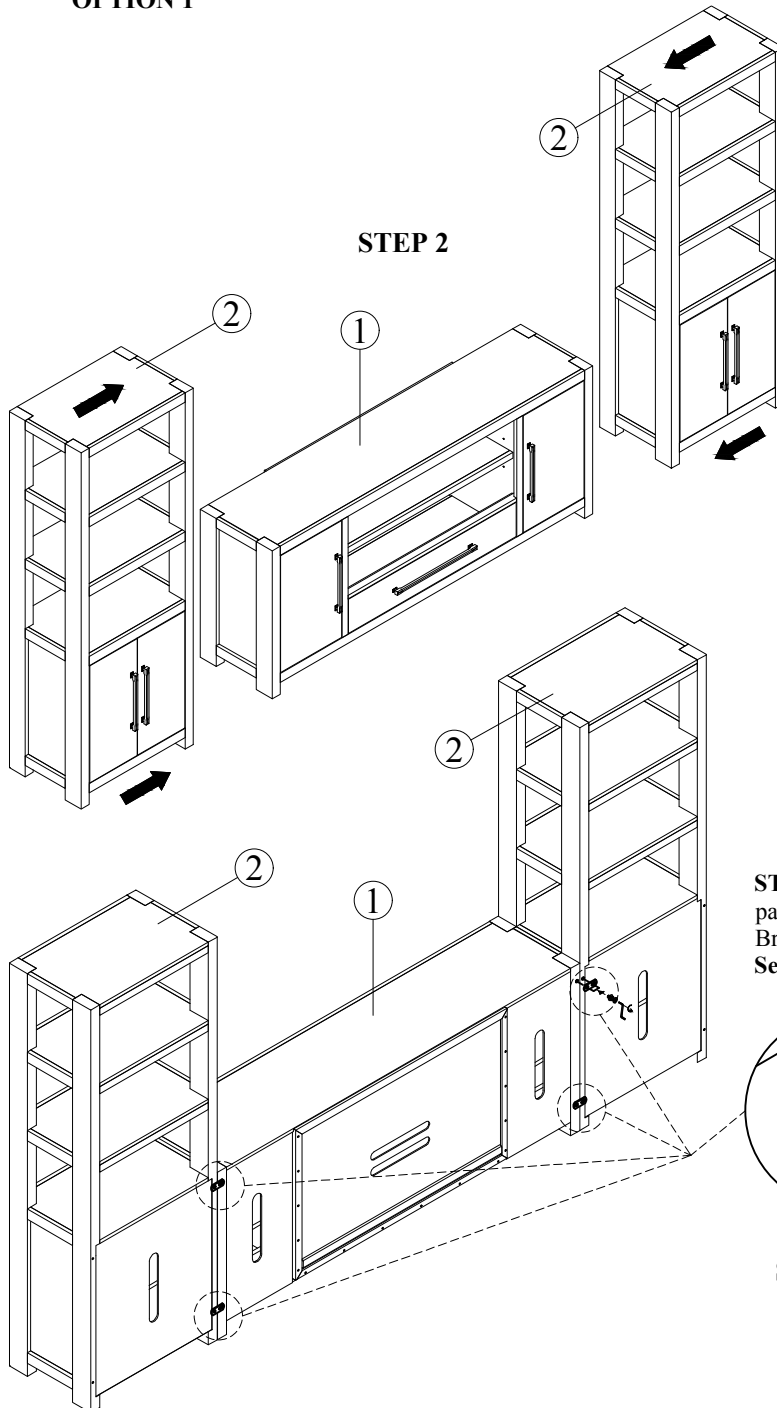

Remark:

+ Do not fully tighten all bolts until assembly is complete

STEP 2: Place the Media Pier (2) left and right sides of 80" Console (1). See Step 2.

STEP 3: So that it fits the predetermined pin holes in back panel of 80" Console (1) and Media Pier (2). Use metal Bracket (B) the Allen Key Z (D) to tighten Allen Bolt (C). See Step 3.

STEP 3

Hardware Pack Location (s):

RETG 1420-06 80" CONSOLE - SKU# 24120230



Assembly Instructions

RETG 1420-06 80" CONSOLE - SKU# 24120230

Manufactured by RETG for Rooms To Go

Version#1 - 05/09/2024

***** Caution : Please read all instructions carefully before starting the assembly process. These parts are cumbersome and heavy. Therefore, two people are recommended in order to prevent personal injury and insure the parts are not damaged during the assemble.**

OPTION 1

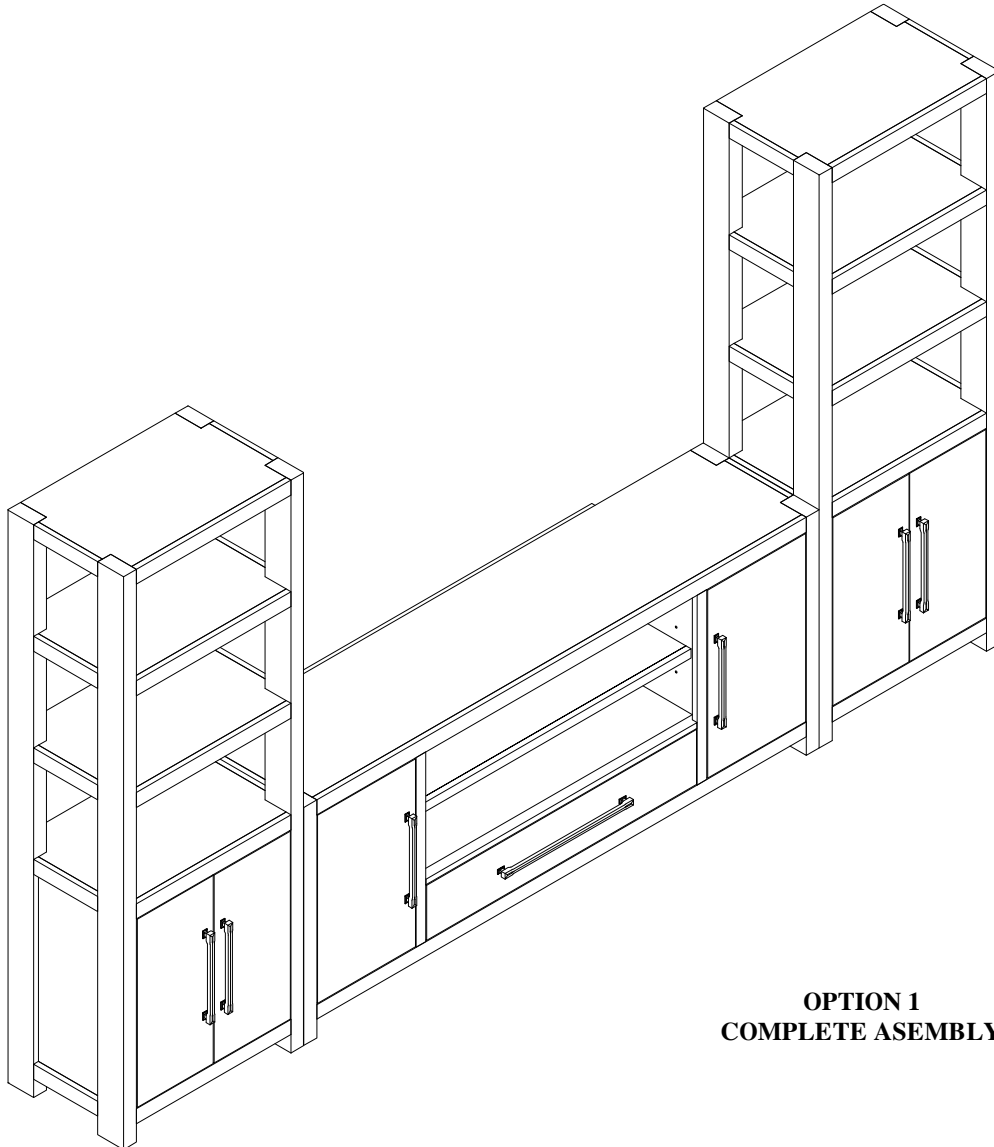

**OPTION 1
COMPLETE ASEMBLY**

Hardware Pack Location (s):

RETG 1420-06 80" CONSOLE - SKU# 24120230



Assembly Instructions

RETG 1420-06 80" CONSOLE - SKU# 24120230

Manufactured by RETG for Rooms To Go

Version#1 - 05/09/2024

*** **Caution :** Please read all instructions carefully before starting the assembly process. These parts are cumbersome and heavy. Therefore, two people are recommended in order to prevent personal injury and insure the parts are not damaged during the assemble.

OPTION 2

Using with Firebox Insert

STEP 1: Remove the screw that fixed the shelf pin. Take shelf pin out of the 80" Console (1). **See Step 1.**

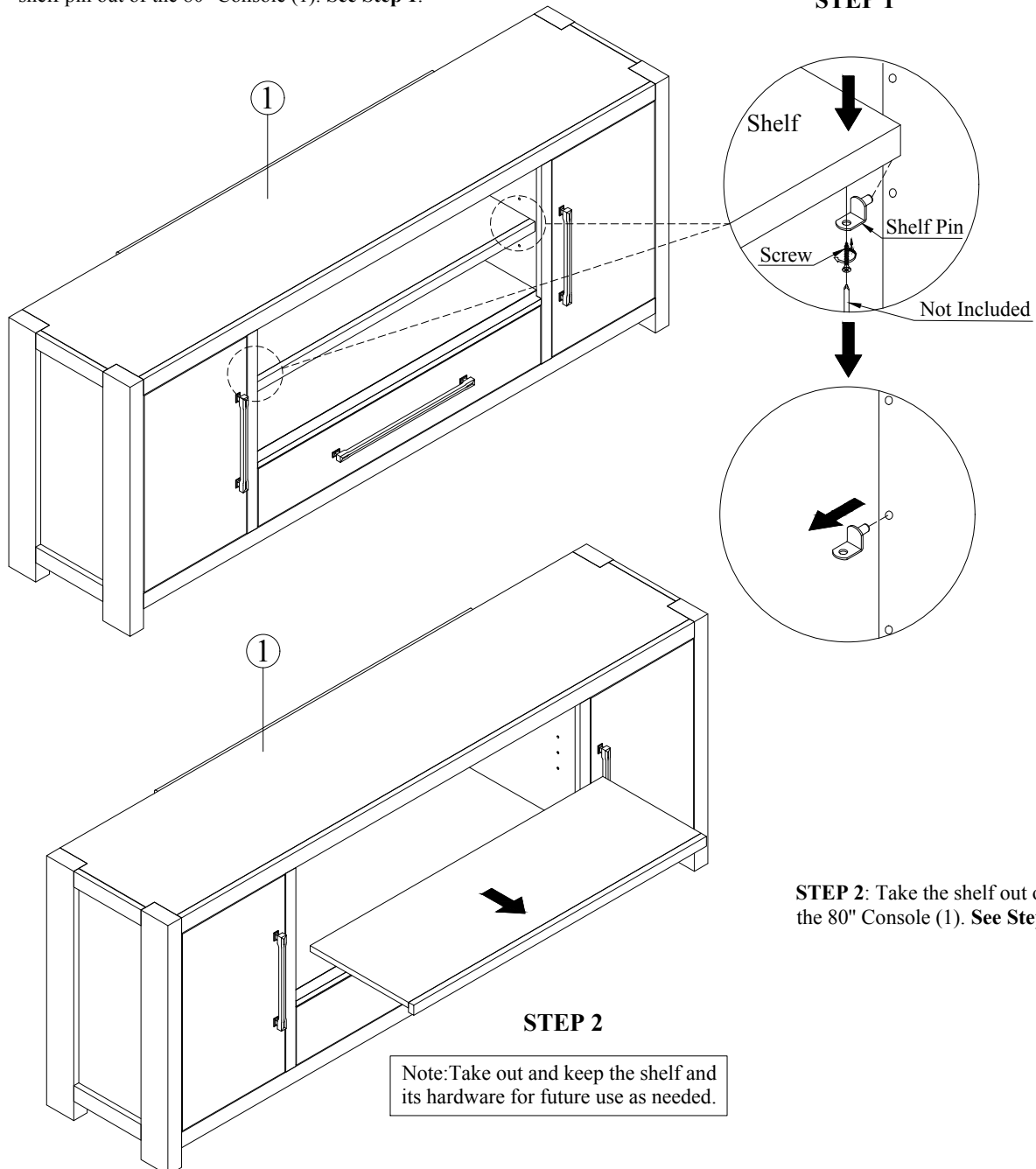

Hardware Pack Location (s):

RETG 1420-06 80" CONSOLE - SKU# 24120230



Assembly Instructions

RETG 1420-06 80" CONSOLE - SKU# 24120230

Manufactured by RETG for Rooms To Go

Version#1 - 05/09/2024

*** **Caution :** Please read all instructions carefully before starting the assembly process. These parts are cumbersome and heavy. Therefore, two people are recommended in order to prevent personal injury and insure the parts are not damaged during the assemble.

OPTION 2

Using with Firebox Insert

STEP 3: On the back, pull the console back panel upward to install the Firebox (3). See Step 3.

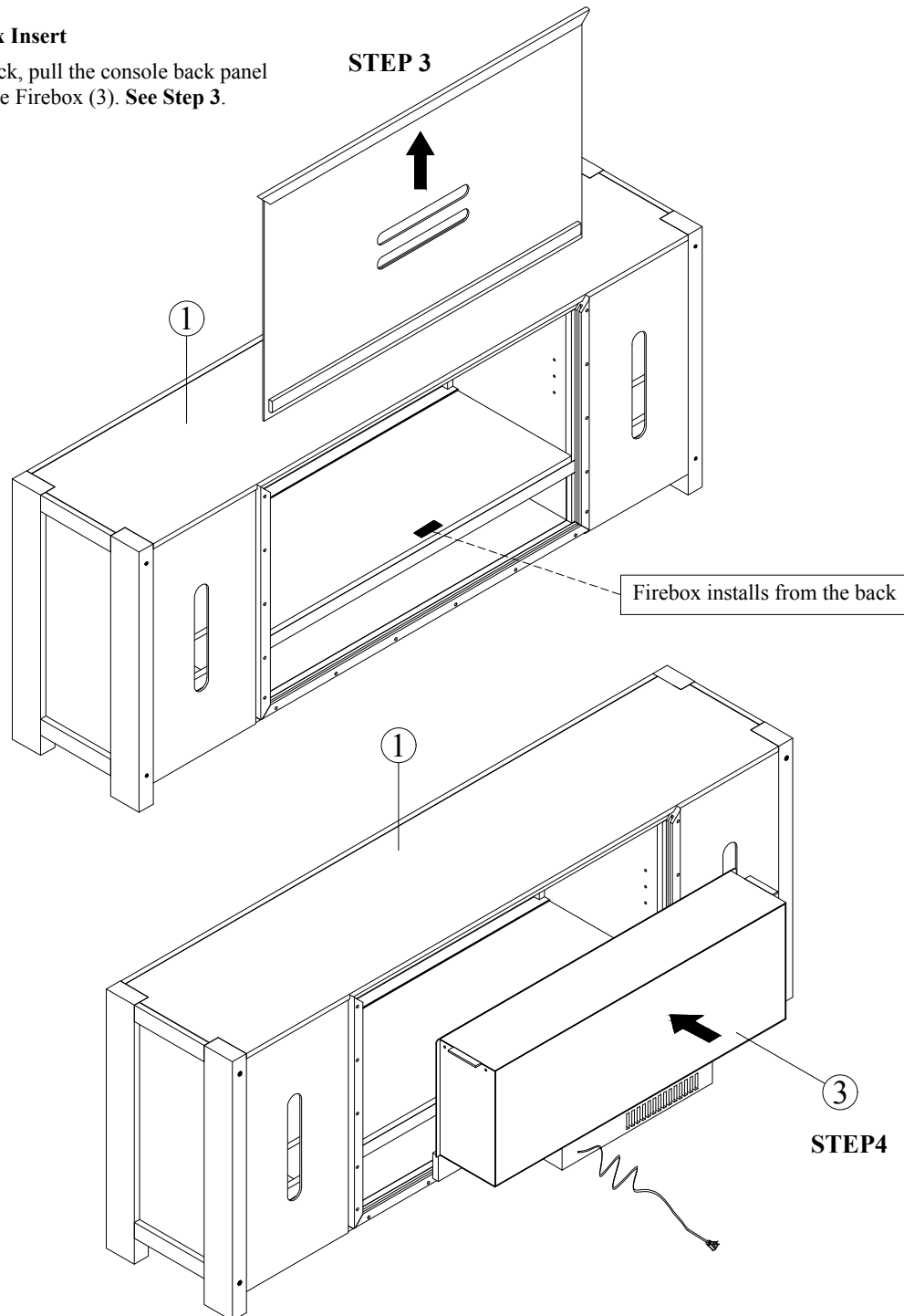

STEP 4: Install the Firebox (3) from the back. See Step 4.

Hardware Pack Location (s):

RETG 1420-06 80" CONSOLE - SKU# 24120230

Assembly Instructions

RETG 1420-06 80" CONSOLE - SKU# 24120230

Manufactured by RETG for Rooms To Go

Version#1 - 05/09/2024

***** Caution : Please read all instructions carefully before starting the assembly process. These parts are cumbersome and heavy. Therefore, two people are recommended in order to prevent personal injury and insure the parts are not damaged during the assemble.**

OPTION 2

Using with Firebox Insert

STEP 5 : Re-install the console pack panel from the top down until there is enough space, then use your hand to thread the wire through the rear panel hole. **See Step 5.**

STEP 6: Position 80" Console in its desired location. Refer to the assembly instructions of Anti tipping kits to fix 80" Console to the wall. **See Step 6.**

Remark:
Anti-tip hardware - customer
assembly required

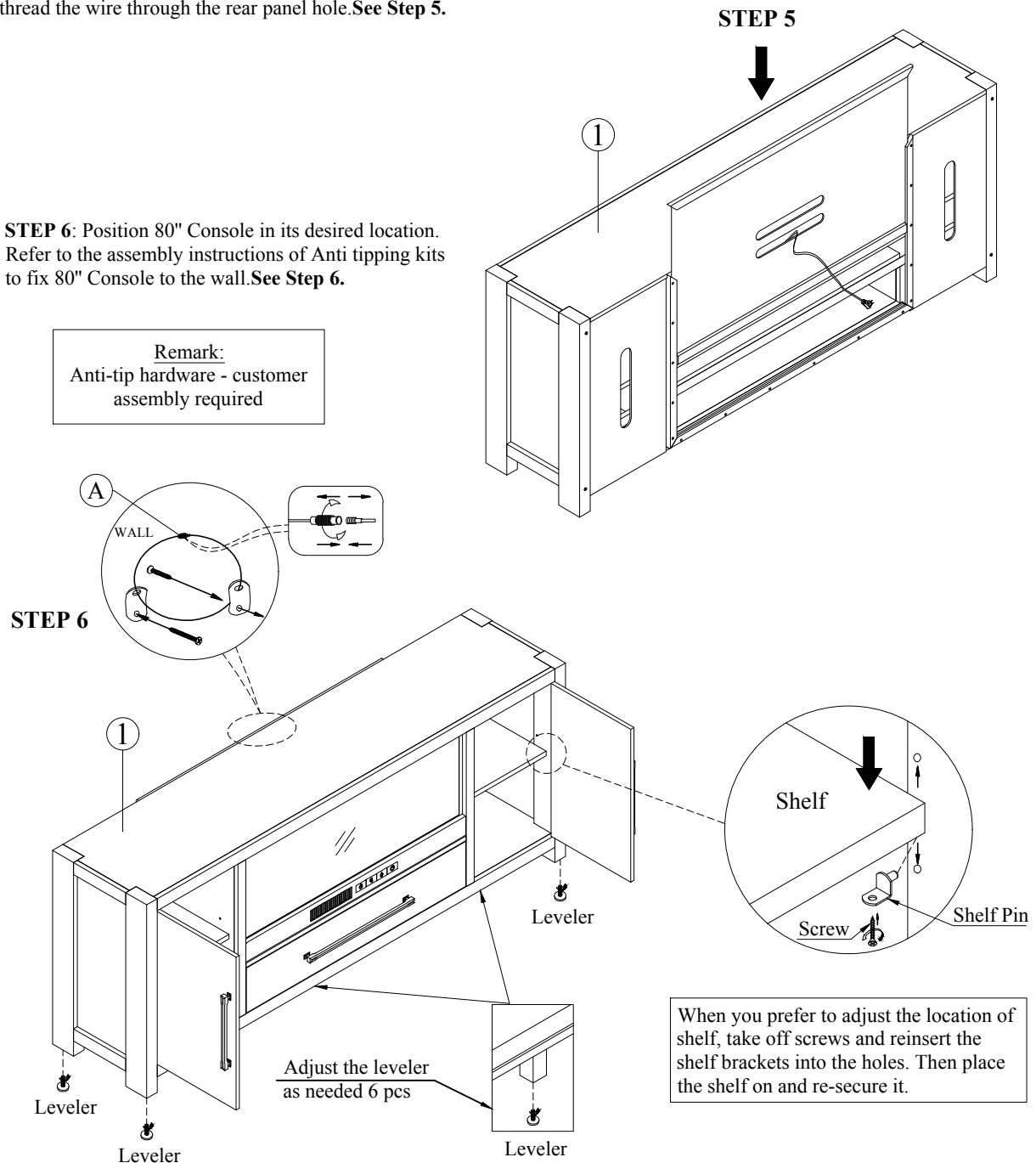

Hardware Pack Location (s):

RETG 1420-06 80" CONSOLE - SKU# 24120230



Assembly Instructions

RETG 1420-06 80" CONSOLE - SKU# 24120230

Manufactured by RETG for Rooms To Go

Version#1 - 05/09/2024

***** Caution : Please read all instructions carefully before starting the assembly process. These parts are cumbersome and heavy. Therefore, two people are recommended in order to prevent personal injury and insure the parts are not damaged during the assemble.**

OPTION 2

Using with Firebox Insert

STEP 7

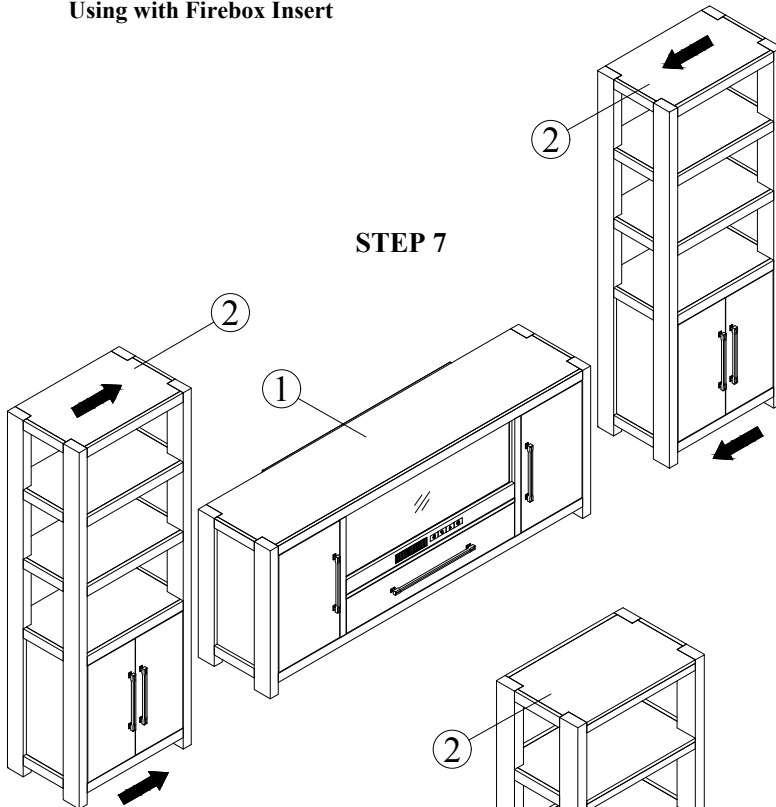

Remark:

+ Do not fully tighten all bolts until assembly is complete

STEP 7: Place the Media Pier (2) left and right sides of 80" Console (1). See Step 7.

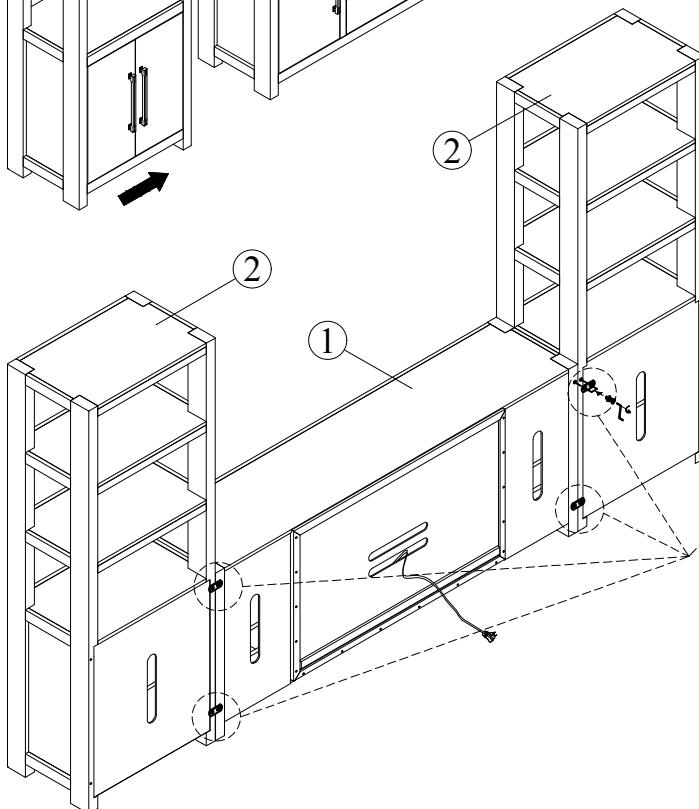

STEP 8: So that it fits the predetermined pin holes in back panel of 80" Console (1) and Media Pier (2). Use metal Bracket (B) the Allen Key Z (D) to tighten Allen Bolt (C). See Step 8.

STEP 8

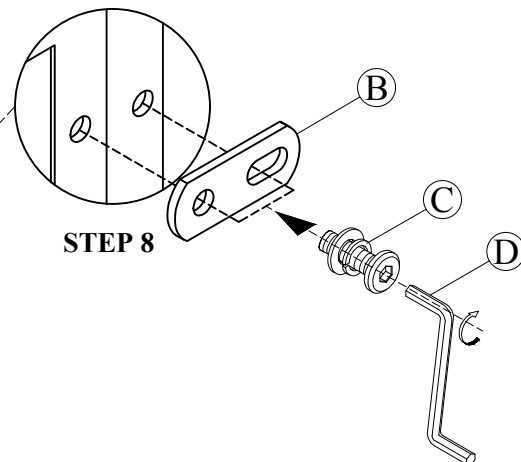

Hardware Pack Location (s):

RETG 1420-06 80" CONSOLE - SKU# 24120230



Assembly Instructions

RETG 1420-06 80" CONSOLE - SKU# 24120230

Manufactured by RETG for Rooms To Go

Version#1 - 05/09/2024

***** Caution : Please read all instructions carefully before starting the assembly process. These parts are cumbersome and heavy. Therefore, two people are recommended in order to prevent personal injury and insure the parts are not damaged during the assemble.**

OPTION 2

Using with Firebox Insert

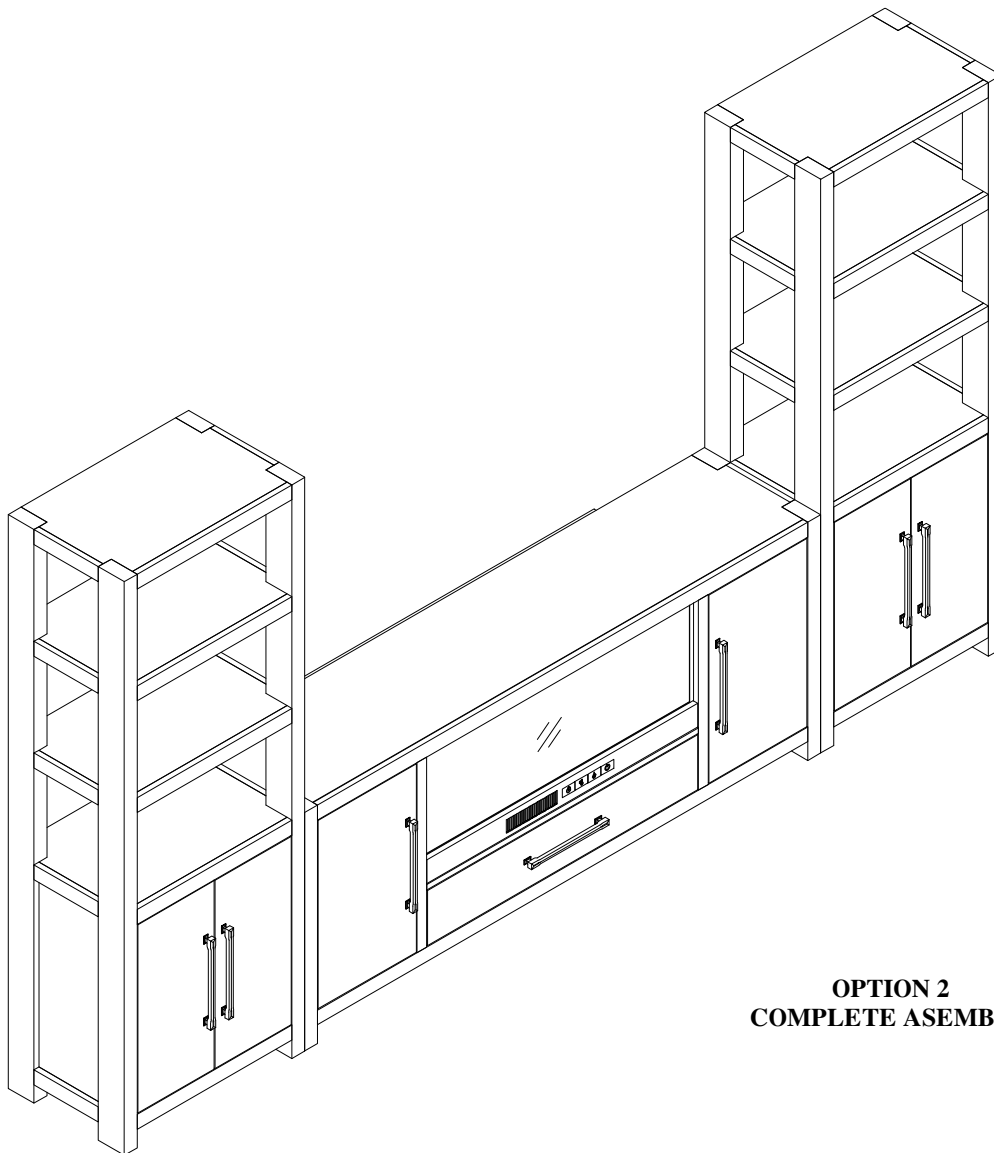

**OPTION 2
COMPLETE ASSEMBLY**

Hardware Pack Location (s):

RETG 1420-06 80" CONSOLE - SKU# 24120230