

54" TV Console

Model # RTGAVC54BRC

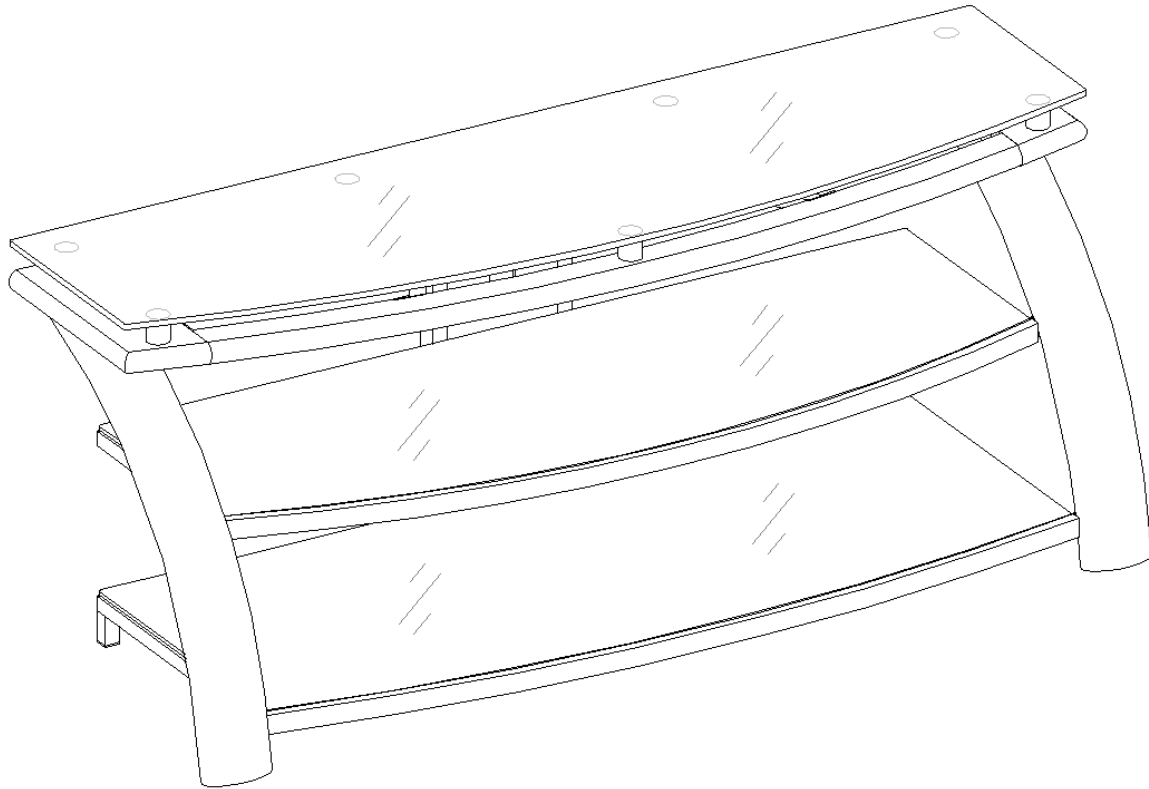

ADULT ASSEMBLY REQUIRED

If you have any questions regarding assembly or if parts are missing, DO NOT return this item to the store where it was purchased. Please call our toll-free customer service number and have your instructions and parts list ready to provide the model name, part name or factory number:

1-866-942-5362

Pacific Standard Time: 8:30 a.m. - 4:30 p.m., Monday to Friday

Or visit our website 24 hours a day, 7 days a week for product assistance at

www.whalenfurniture.com

Or e-mail your request to parts@whalenfurniture.com

**THIS INSTRUCTION BOOKLET CONTAINS IMPORTANT SAFETY INFORMATION.
PLEASE READ AND KEEP FOR FUTURE REFERENCE.**

MAXIMUM RECOMMENDED WEIGHT LOADS

MANUFACTURER: VAS Furniture
 CATALOG: 54" TV Console (RTGAVC54BRC)
 DATE OF MANUFACTURE: September, 2011
 MADE IN CHINA

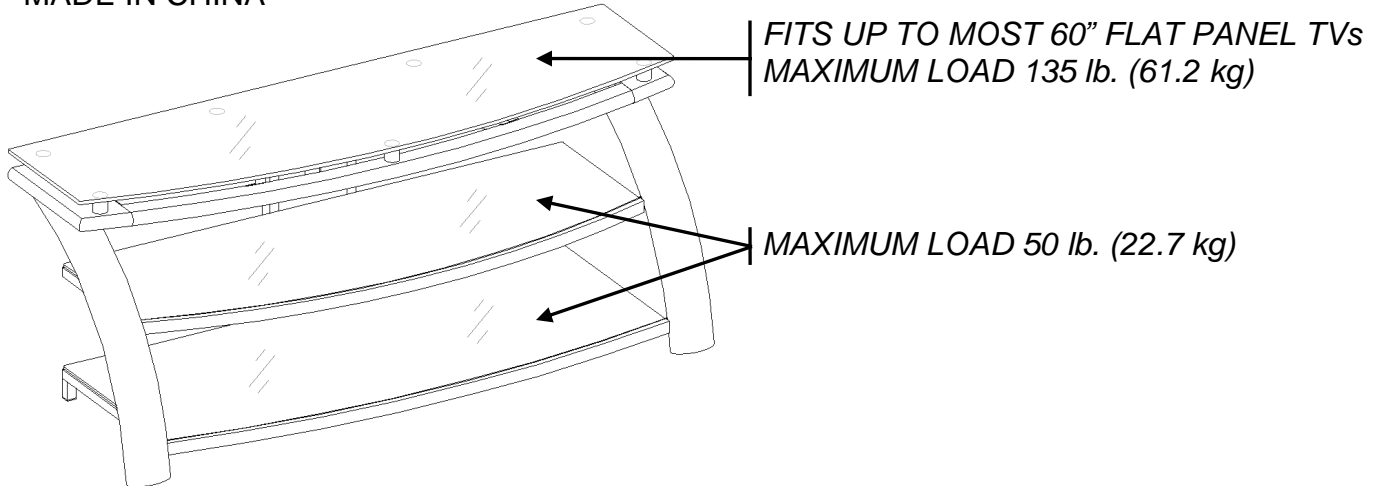

⚠ WARNING

THIS UNIT IS NOT INTENDED FOR USE WITH CRT TVS. USE ONLY WITH FLAT PANEL TVS AND AUDIO/VIDEO EQUIPMENT MEETING RECOMMENDED SIZE AND WEIGHT LIMITS. NEVER USE WITH LARGER/HEAVIER THAN RECOMMENDED FLAT PANEL TVS OR EQUIPMENT. TO AVOID INSTABILITY, PLACE FLAT PANEL TV IN CENTRE OF UNIT; CRT TVS, IMPROPERLY POSITIONED FLAT PANEL TVS, OR FLAT PANEL TVS OR OTHER EQUIPMENT THAT EXCEED RECOMMENDED SIZE AND WEIGHT LIMITS COULD FALL OFF OR BREAK THE UNIT, CAUSING POSSIBLE SERIOUS INJURY.

GENERAL INFORMATION, TIPS and TRICKS

1. Please read the Assembly Instructions prior to assembling this product.
2. Remove all hardware from box and sort by size.
3. Check to see that all hardware and parts are present BEFORE assembling.
4. Ask a friend to assist you with the assembly of this furniture.
5. To avoid damage, assemble the product on a sturdy, level and protective surface.
6. Please wait until all steps are completed before tightening bolts.
7. Make sure all bolts are tightly fastened before the unit is used.

This product is sold with Tip Restraint Hardware kit. You must install the Tipping Restraint Hardware between the wall and the TV stand to prevent any accidents or damages. When properly installed, this restraint can provide protection against the unexpected tipping of the unit due to small tremors, bumps or climbing. The restraint is only a deterrent and is not a substitute for proper adult supervision. Use of tip-over restraints may only reduce, but not eliminate, the risk of tip-over.

Please call for replacement parts or assistance: **1-866-942-5362**

Parts and Hardware List

Please read completely through the instructions and verify that all parts listed are present before beginning assembly.

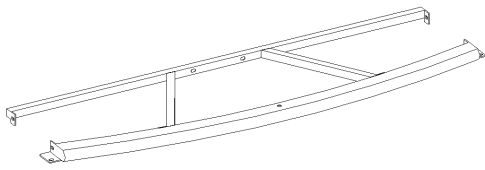

A- Top Shelf Frame (1)



B- Middle Shelf Frame (1)

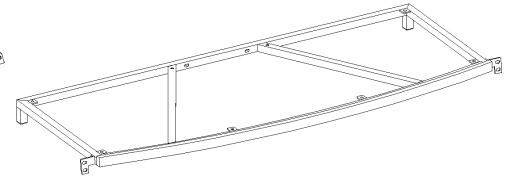

C- Bottom Shelf Frame (1)

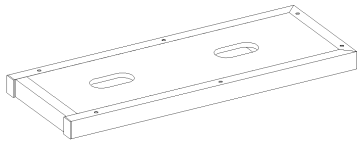

D- Back Frame (1)

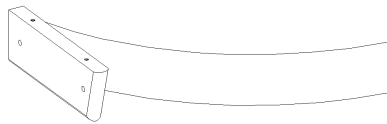

E- Left Leg (1)

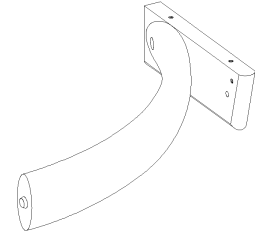

F- Right Leg (1)

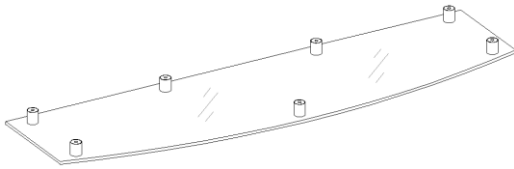

G- Top Glass (1)

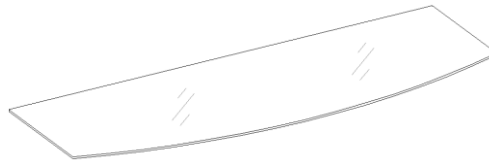

H- Middle Glass Shelf (1)

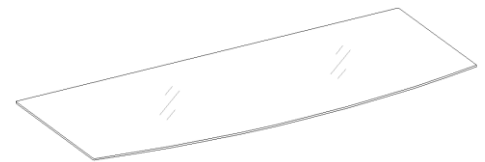

I- Bottom Glass Shelf (1)

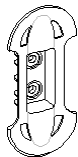

J- Cable Wheel
(2)



(1) Suction Cup
(16+1 extra)

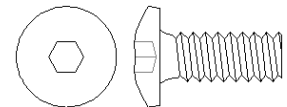

(2) 5/8" Bolt
(16+1 extra)

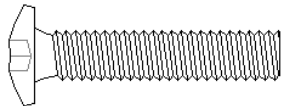

(3) 1-1/4" Bolt
(6+1 extra)

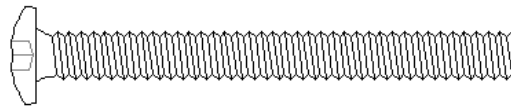

(4) 2-1/2" Bolt
(5+1 extra)



(5) Lock Washer
(23+1 extra)

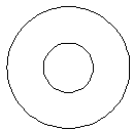

(6) Flat Washer
(23+1 extra)

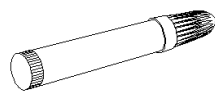

Touch-up Pen
(1)



Allen Wrench
(2)

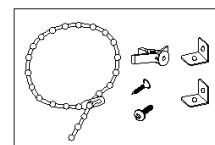

Tipping Restraint Hardware Kit (1)
(Inside Plastic Bag)

Tools required: Allen Wrench (provided) and Phillips Screwdriver (not provided).

Please call for replacement parts or assistance: 1-866-942-5362

VAS Furniture Mfg. Inc.

Assembly Instructions

Note: Please do not fully tighten all bolts until you finish assembling all parts. Once assembled, go back and fully tighten all bolts. This will make it easier during assembly of unit.

1. Unpack the unit and confirm that you have all the hardware and required parts listed.
2. Locate Back Frame (D) on a level and protective surface with the flush surfaces facing up.
3. Align and attach 3 Shelf Frames (A, B and C) to the Back Frame (D). Make sure the flush surfaces of Top Shelf Frame (A) and the metal tabs on the lower Shelf Frames (B and C) will face up after assembly.

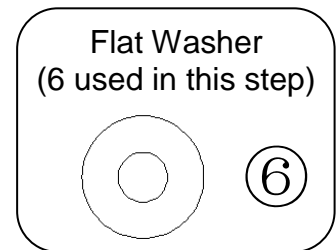
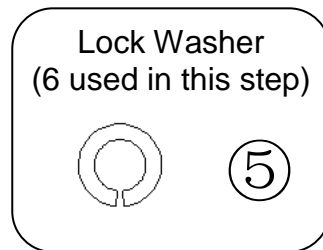
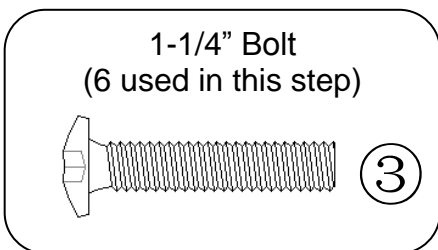
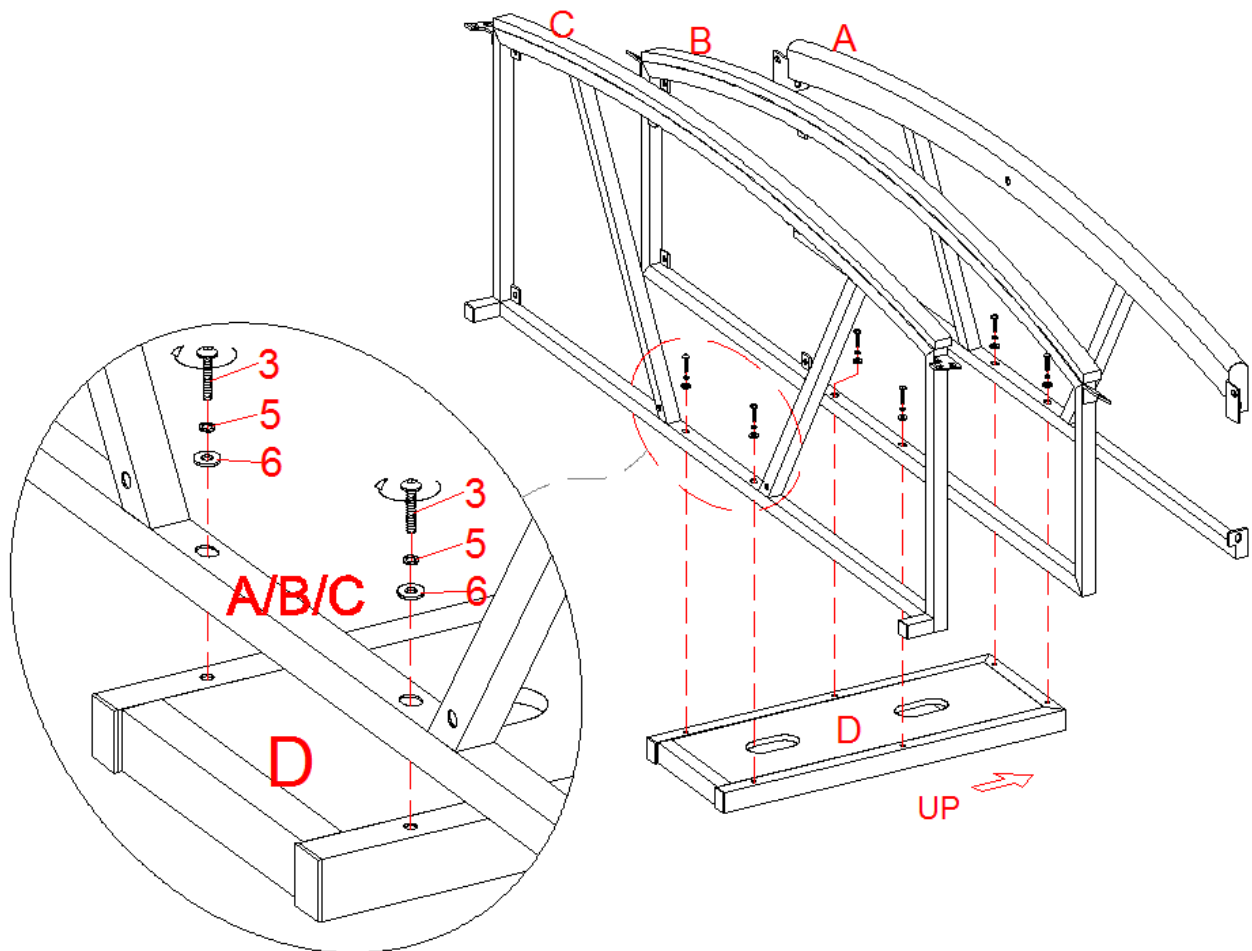

Assembly Instructions

4. Stand the unit upright.
5. Align and attach Left and Right Legs (E and F) to the Shelf Frames (A, B and C). **DO NOT tighten the bolts.** Make sure that the top edges are even with each other and that the gaps and offsets between the front rails and Legs are equal. Loosen the bolts and adjust if necessary.

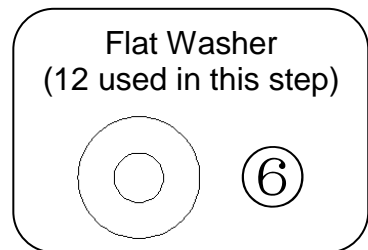
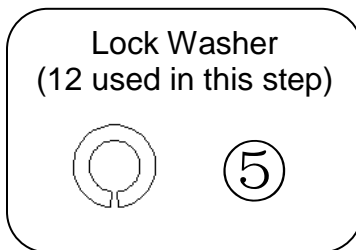
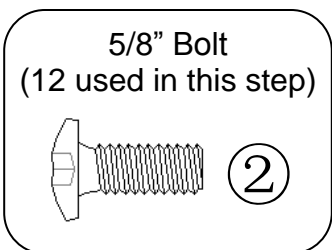
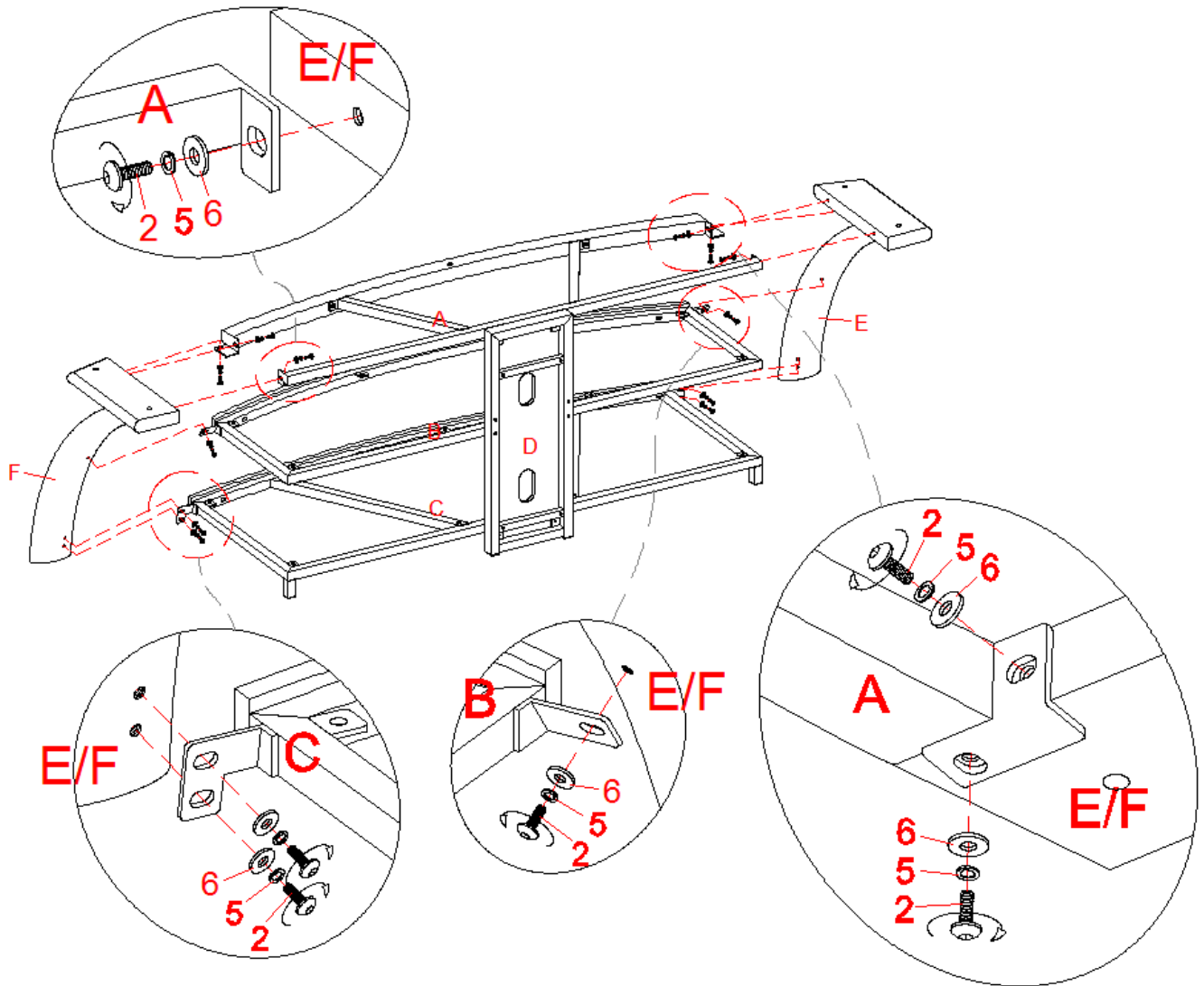

Assembly Instructions

- Go back and tighten all bolts with the Allen Wrench provided.
- Adjust the Floor Levelers pre-attached at the bottom of both Front Legs (E and F) to level the unit.

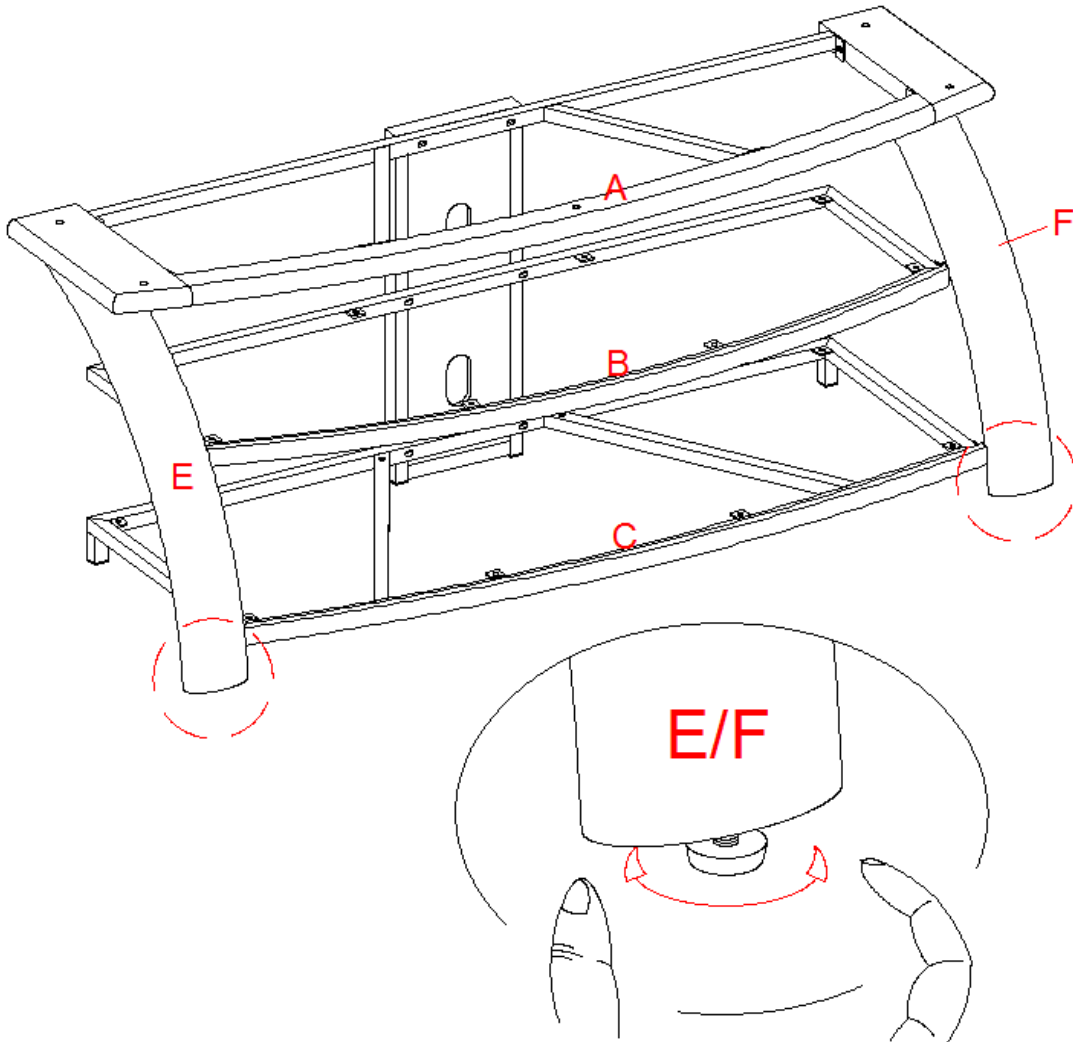

Hardware provided

Pre-attached Floor Leveler

Tools required

No tool required

Please call for replacement parts or assistance: 1-866-942-5362

VAS Furniture Mfg. Inc.

Page 6

Factory No. 55-12029

Assembly Instructions

- Attach 2 Cable Wheels (J) onto the backside of Back Frame (D) and tighten with enclosed Allen Wrench.
- The Cable Wheels allow you to organize, route and separate your component cords and cables to minimize tangling and signal interference.

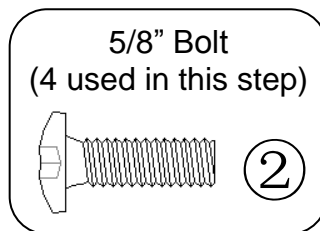
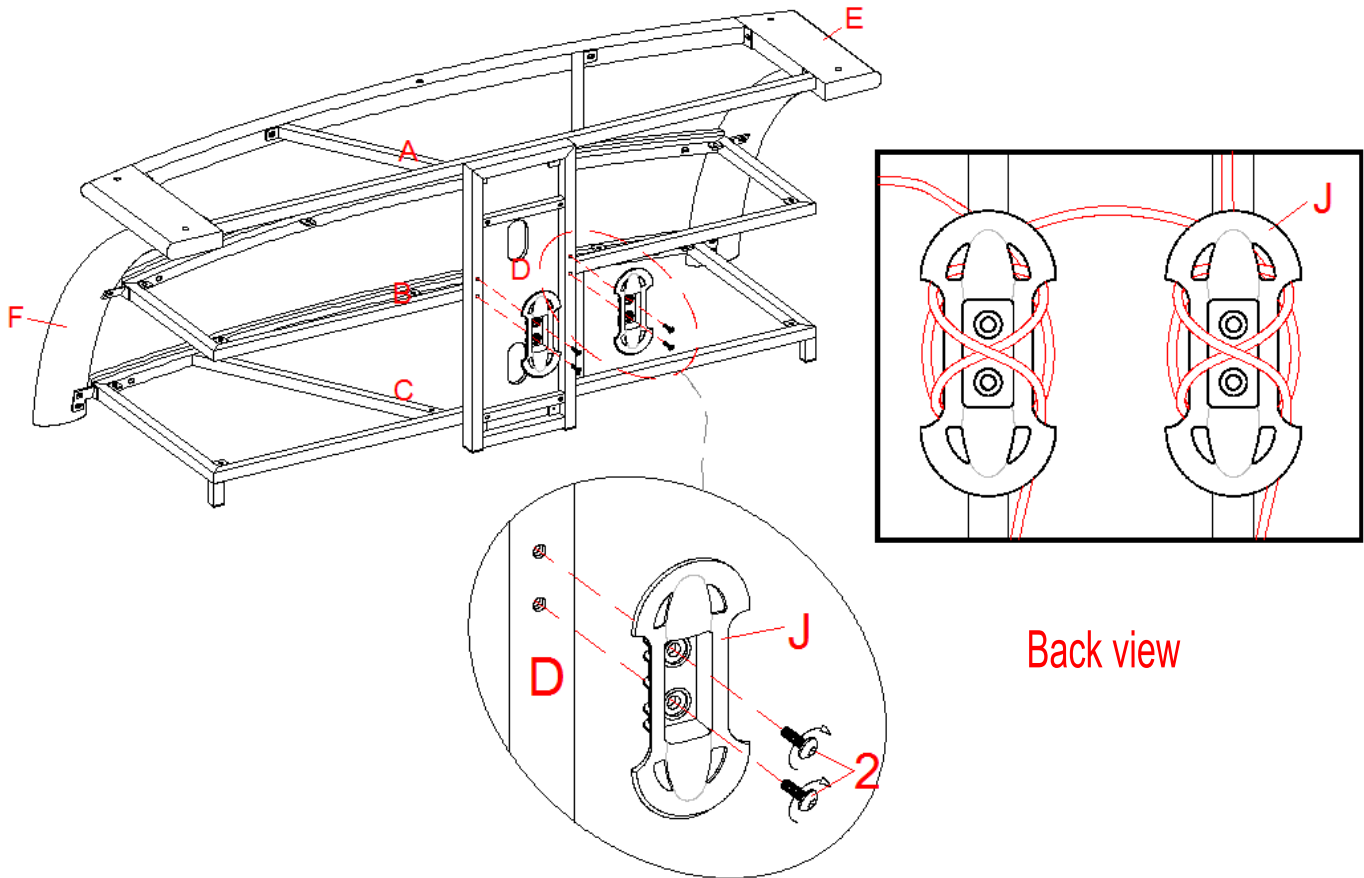

Assembly Instructions

10. Put Suction Cups (1) firmly into the top holes and metal tabs on Shelf Frames (B and C).
11. Place Glass Shelves (H and I) in place starting with Bottom Glass Shelf (I). Make sure the glass is properly centered and the black side of glass is down. Push each glass all the way back against the Back Frame.
12. Align and attach Top Glass (G) in place.

Note: If glass is scratched you can minimize the damage by using a BLACK marker and filling in scratched area from underneath.

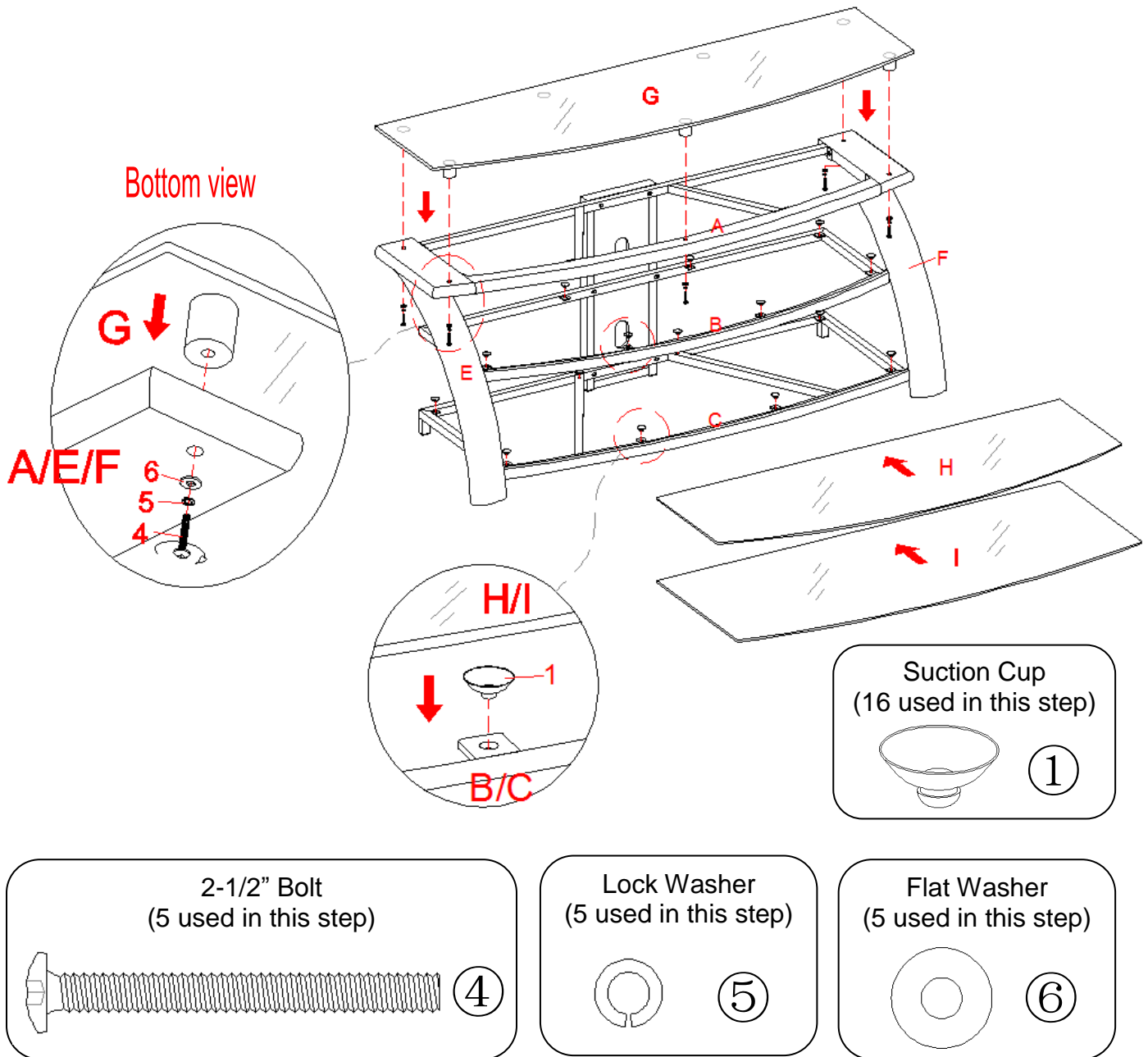

Option #1: AS A TV STAND

You can use this unit as a TV Stand to place your TV or Stereo components.

Option #2: TV STAND and SWINGING FLOATER

You can buy our Swinging Floater (sold separately) and combine with the TV Stand. So you can position your Flat Panel TV above the console and swivel left-or-right for optimum viewing control.

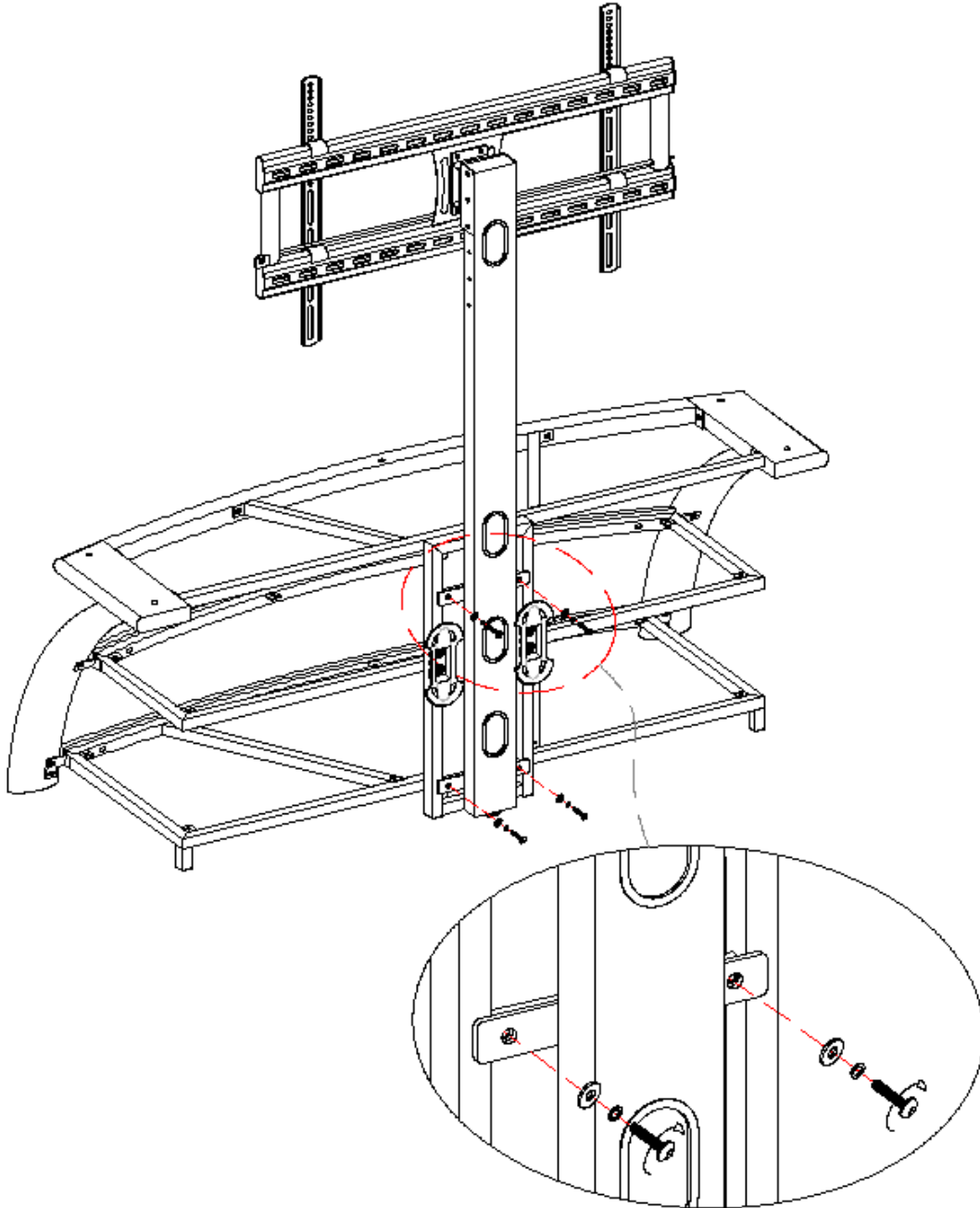

Please call for replacement parts or assistance: 1-866-942-5362

VAS Furniture Mfg. Inc.

Page 9

Factory No. 55-12029

TIPPING RESTRAINT HARDWARE

Note: We have included one Tipping Restraint Hardware bag for this unit.

When properly installed, this restraint can provide protection against the unexpected tipping of the unit due to small tremors, bumps or climbing. We strongly recommend mounting this hardware to a wall stud and your unit when installing.

Please carefully read the instructions printed on the plastic bag containing tipping restraint hardware.

Note: You must install the Tipping Restraint Hardware with the unit in use to prevent any accidents or damage to the unit.

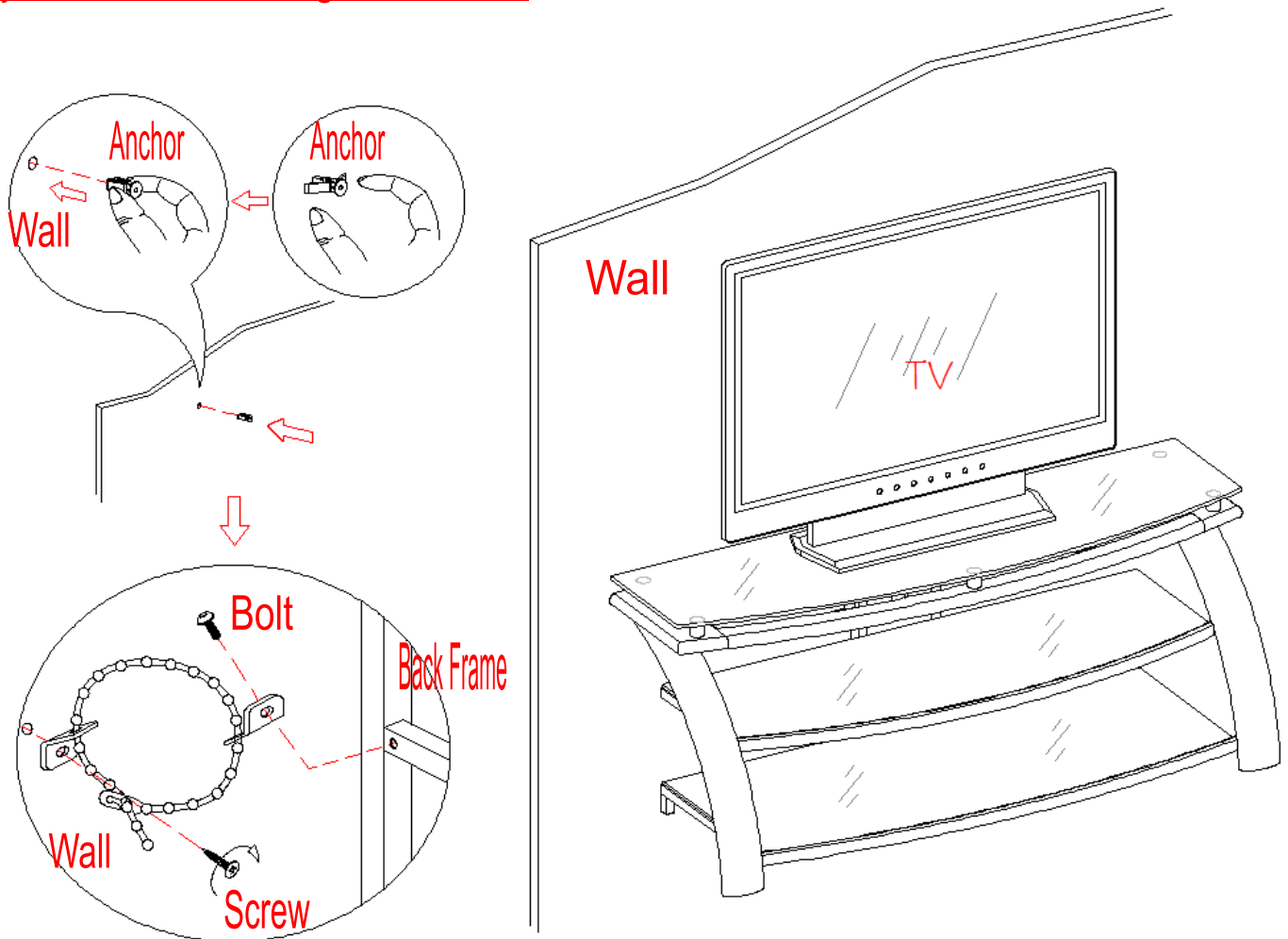

Tools required: Allen Wrench (provided), Phillips Screwdriver, Mallet, Power Drill, and 3/8" Drill Bit.

Please call for replacement parts or assistance: 1-866-942-5362

VAS Furniture Mfg. Inc.

Page 10

Factory No. 55-12029

Metal furniture care instructions

- For everyday cleaning, chrome, brass, aluminum, and painted metal surfaces can be kept looking their best by wiping with a slightly damp, soft cotton cloth, or vacuum cleaner brush.
- If soiled, wipe with clean sponge or cloth wrung out of water. Wipe dry with cloth or paper towel to avoid water spots.
- Do not use any harsh abrasives or chemicals to clean any metal surfaces as it may damage the protective coating.
- Metal will rust if the finish is scratched or if your furniture is exposed to excessive humidity, particularly in salt water locations.
- Most metal furniture has a protective coating to prevent rust, however rust may occur if the finish is marred or wears away over time.
- In the event that your furniture is stained or otherwise damaged during use, we recommend that you call a professional to repair your furniture.
- Check bolts/screws periodically and tighten them if necessary.

Further advice about metal furniture care

It is best to keep your furniture in a climate controlled environment. Continual exposure to damp and wet environment can cause corrosion. It is advised to keep furniture away from direct sunlight as it may damage the finish. Indoor furniture is not recommended for outdoor use.

We hope you enjoy your purchase for many years.
Thank you for your purchase!

QUALITY GUARANTEE

We are confident that you will be delighted with your VAS Furniture purchase.

Should this product be defective in workmanship or materials or fail under normal use, we will repair or replace it for up to one (1) year from date of purchase. Every VAS Furniture product is designed to meet your highest expectations. We guarantee that you will immediately see the value of our fine furniture.

This warranty gives you specific legal rights and you may also have other rights which vary from State to State.

Customer Service: 1-866-942-5362
8:30 a.m. - 4:30 p.m., PST, Monday to Friday

www.whalenfurniture.com



Please call for replacement parts or assistance: 1-866-942-5362

VAS Furniture Mfg. Inc.

Page 11

Factory No. 55-12029

**IF YOU NEED TO REQUEST ANY PARTS PLEASE USE THE LIST BELOW
54" TV Console (RTGAVC54BRC)**

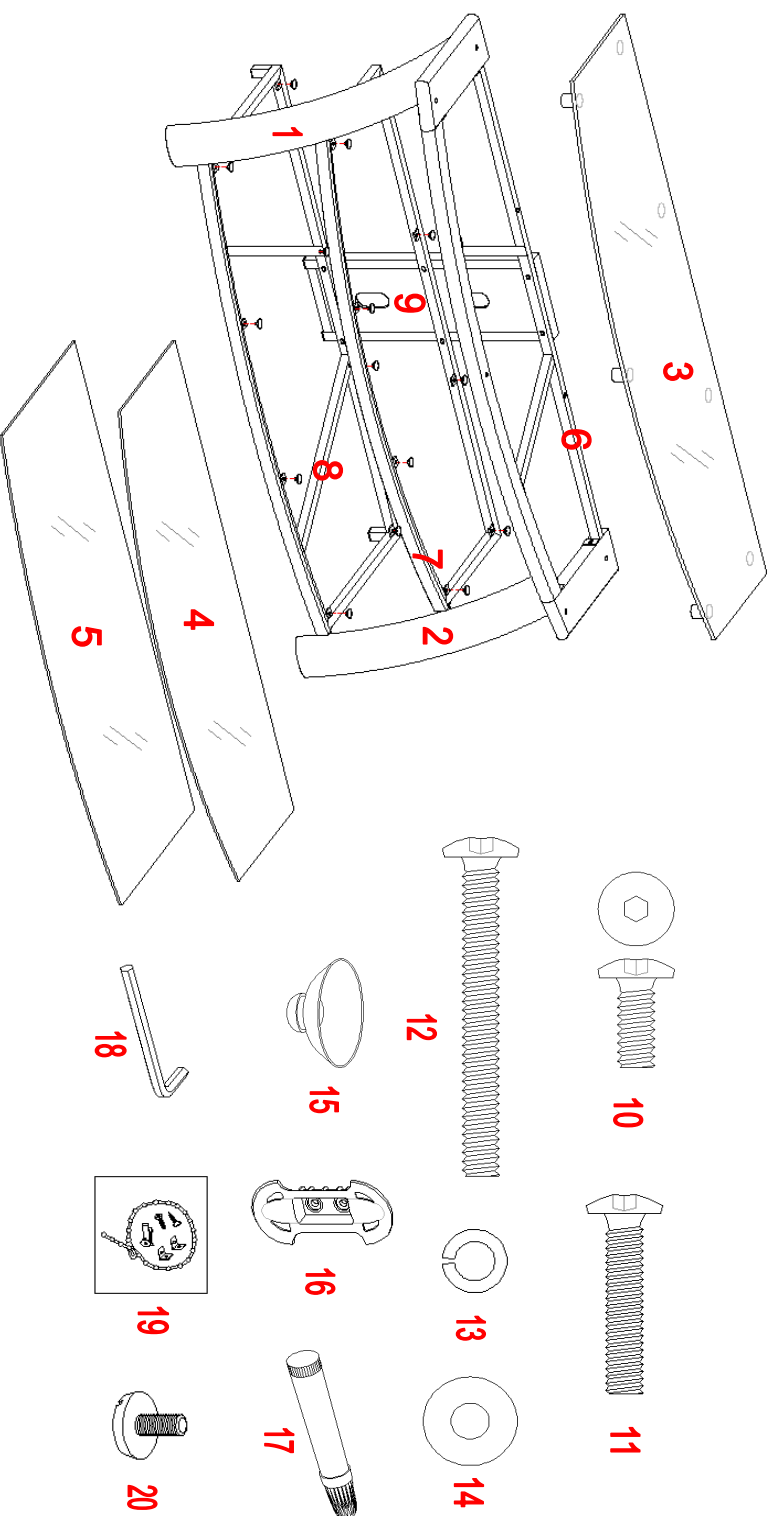

| | | | |
|------------------------|--------------------------------|------------------------|----------------------------------|
| *RTGAVC54BRC-1-LL | Left Leg | *RTGAVC54BRC-12-2 1/2B | 2-1/2" Bolt |
| *RTGAVC54BRC-2-RL | Right Leg | *RTGAVC54BRC-13-LW | Lock Washer |
| *RTGAVC54BRC-3-TG | Top Glass | *RTGAVC54BRC-14-FW | Flat Washer |
| *RTGAVC54BRC-4-MGS | Middle Glass Shelf | *RTGAVC54BRC-15-SC | Suction Cup |
| *RTGAVC54BRC-5-BGS | Bottom Glass Shelf | *RTGAVC54BRC-16-CW | Cable Wheel |
| *RTGAVC54BRC-6-TSF | Top Shelf Frame | *RTGAVC54BRC-17-TUP | Touch-up Pen |
| *RTGAVC54BRC-7-MSF | Middle Shelf Frame | *RTGAVC54BRC-18-AW | Allen Wrench |
| *RTGAVC54BRC-8-BSF | Bottom Shelf Frame | *RTGAVC54BRC-19-TRHK | Tipping Restraint Hardware Kit |
| *RTGAVC54BRC-9-BF | Back Frame | *RTGAVC54BRC-20-FL | Floor Leveler |
| *RTGAVC54BRC-9A-BFWPS | Back Frame Wood Panel w/Screws | *RTGAVC54BRC-21-PEC | Plastic End Cap (for Back Frame) |
| *RTGAVC54BRC-10-5/8B | 5/8" Bolt | *RTGAVC54BRC-CH | Complete Hardware |
| *RTGAVC54BRC-11-1 1/4B | 1-1/4" Bolt | | |