



LOT NUMBER: _____
DATE PURCHASED: __/__/__

Zeta Computer Desk

Model # ZTCD-B Black Finishing Wood

ZTCD-W White Finishing Wood

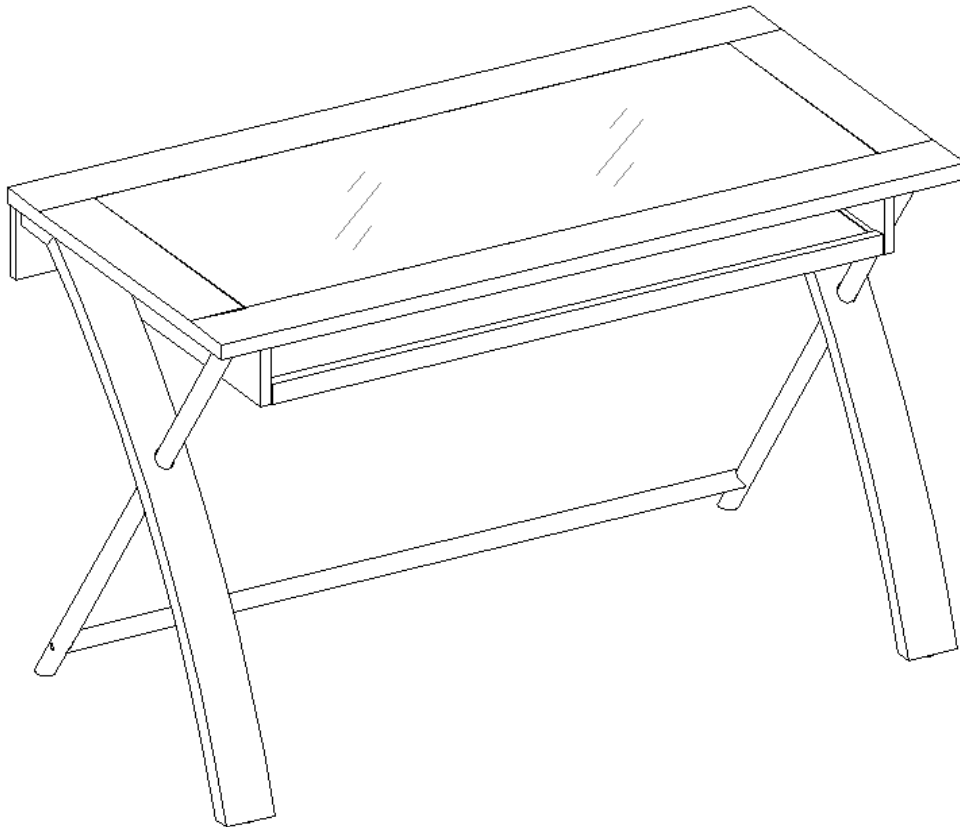

ADULT ASSEMBLY REQUIRED DUE TO THE PRESENCE OF SMALL PARTS, SHARP POINTS, SHARP EDGES AS RECEIVED

If you have any questions regarding assembly or parts are missing, DO NOT return this item to the store where it was purchased. Please call our toll-free customer service number and have your instructions and parts list ready to provide the model name, part name or factory number:

1-866-942-5362

Pacific Standard Time: 8:30 a.m. - 4:30 p.m., Monday to Friday

Or visit our web site www.goldenoak.com

Or e-mail your request to parts@whalenfurniture.com

**THIS INSTRUCTION BOOKLET CONTAINS IMPORTANT SAFETY INFORMATION.
PLEASE READ AND KEEP FOR FUTURE REFERENCE.**

QUALITY GUARANTEE

We are confident that you will be delighted with your Whalen Furniture purchase.

Should this product be defective in workmanship or materials or fail under normal use, we will repair or replace it for up to one (1) year from date of purchase. Every Whalen Furniture product is designed to meet your highest expectations. We guarantee that you will immediately see the value of our fine furniture.

This warranty gives you specific legal rights and you may also have other rights which vary from State to State.

Customer Service: 1-866-942-5362

8:30 a.m. - 4:30 p.m., PST, Monday to Friday

www.whalenfurniture.com

MAXIMUM RECOMMENDED WEIGHT LOADS

MANUFACTURER: Golden Oak®

CATALOG: Zeta Computer Desk

DATE OF MANUFACTURE: January 2014

MADE IN CHINA

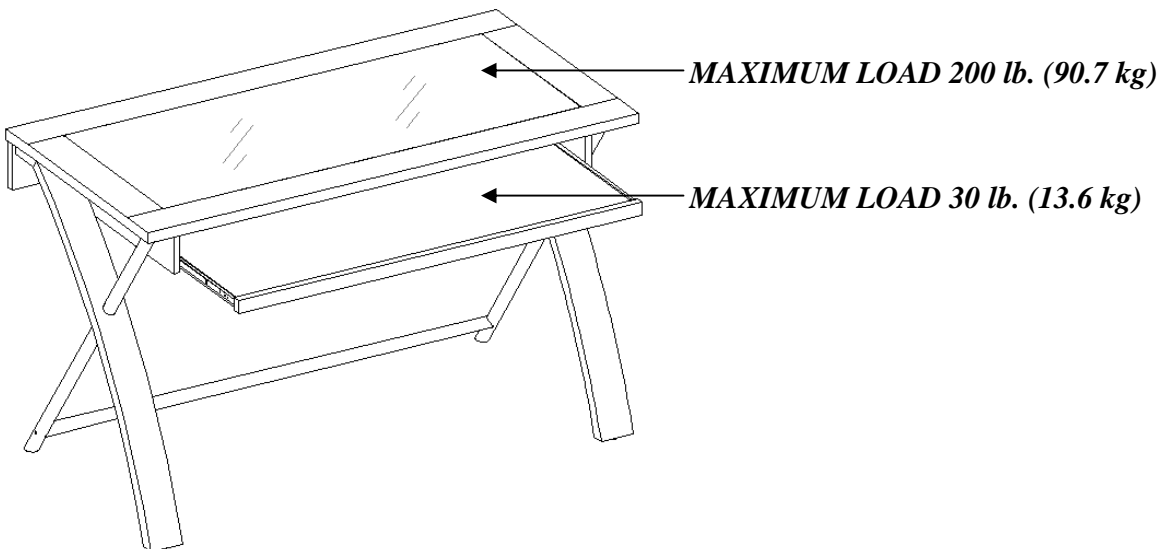

⚠ WARNING THIS UNIT IS INTENDED ONLY FOR USE WITHIN THE MAXIMUM WEIGHTS INDICATED. USE WITH LOAD HEAVIER THAN THE MAXIMUM WEIGHTS INDICATED MAY RESULT IN INSTABILITY, CAUSING POSSIBLE INJURY.

Please call for replacement parts or assistance: 1-866-942-5362

Golden Oak®

Page 2

Factory No. 16598

Parts and Hardware List

Please read completely through the instructions and verify that all listed parts and hardware are present before beginning assembly.

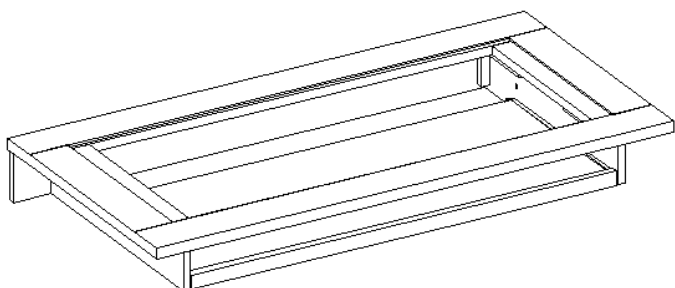

A- Wood Top Frame (1)

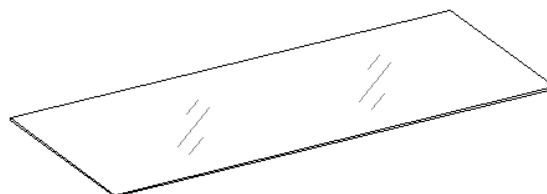

B- Glass Top (1)

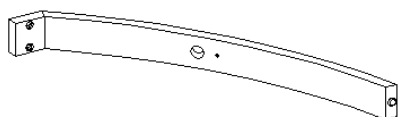

C- Left Wood Leg (1)

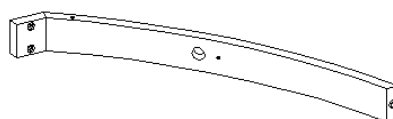

D- Right Wood Leg (1)

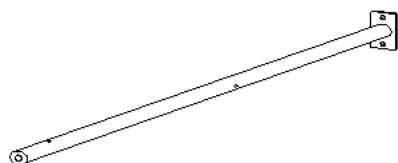

E- Metal Leg (2)

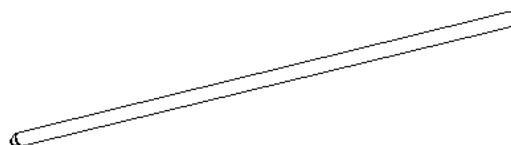

F- Bottom Stretcher (1)

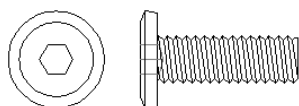

(1) 3/4" Bolt (8+1 extra)

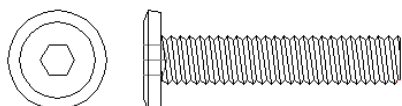

(2) 1-1/4" Bolt (6+1 extra)

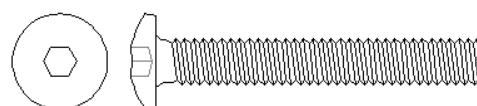

(3) 1-3/4" Bolt (2)



(4) Lock Washer (16+1 extra)

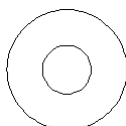

(5) Flat Washer (12+1 extra)

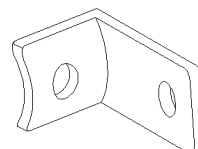

(6) Metal Bracket (2)



(7) Camber Washer (4+1 extra)



4 mm Allen Wrench (2)

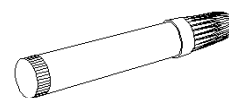

Touch-up Pen (1)
(Not included for item # ZTCD-W)

Tools required: Allen Wrench (provided).



Please call for replacement parts or assistance: 1-866-942-5362
Golden Oak®

Assembly Instructions

NOTE: Please do not fully tighten all bolts until you finish assembling all parts, then go back and fully tighten all bolts. This will make the assembly easier.

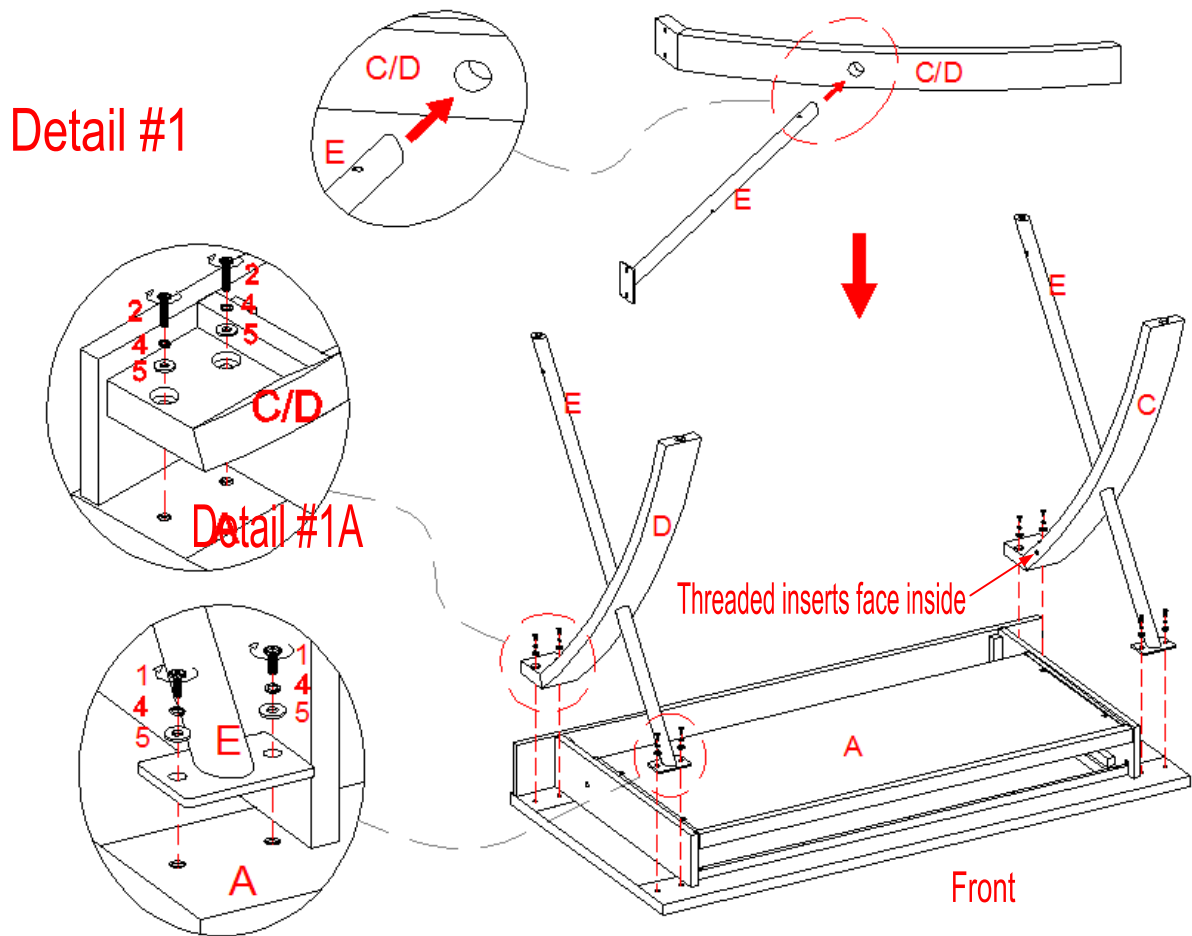
1. Unpack the unit and confirm that you have all the hardware and required parts.
2. Place the Wood Top Frame (A) upside down on a scratch free surface, as shown in detail #1.
3. Pick up one Metal Leg (E) and insert it through the middle hole of the Left Wood Leg (C). Be sure that the metal bracket on the top of Metal Leg will be flush with the flat rail of the Wood Leg. See detail #1.
4. Align and attach the leg assembly to the Wood Top Frame (A) making sure the threaded inserts on the side of Wood Leg faces inward. Insert two 3/4" Bolts (1) with the Lock Washers (4) and Flat Washers (5) through the metal bracket of Metal Leg (E) and insert two 1-1/4" Bolts (2) with the Washers (4 and 5) through the countersunk holes on the Wood Leg and screw into the threaded inserts on the Wood Top Frame. See detail #1A.
5. Repeat last two steps to attach the other Metal Leg (E) and the Right Wood Leg (D) at the other side.

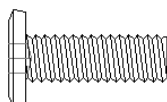
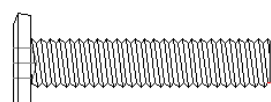

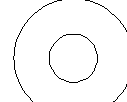
Required hardware in this step				
Description:	(1) 3/4" Bolt	(2) 1-1/4" Bolt	(4) Lock Washer	(5) Flat Washer
Sketch				
Qty.	(4 pcs)	(4 pcs)	(8 pcs)	(8 pcs)
Tools required: Allen Wrench				

Please call for replacement parts or assistance: 1-866-942-5362
Golden Oak®

Assembly Instructions

6. Pull out the Keyboard Tray and insert two 1-1/4" Bolts (2) with the Washers (4 and 5) from inside of the Wood Top Frame (A) through the drilled holes on the side rails and screw into the threaded inserts on both Wood Legs (C & D). Tighten the bolts with the provided Allen Wrench. See detail #2.
7. Now, align and attach two Metal Brackets (6) to the joints of Metal Leg (E) and Wood Legs (C & D) using the 3/4" Bolts (1) and the Washers, two bolts per metal bracket. As shown in detail #2.

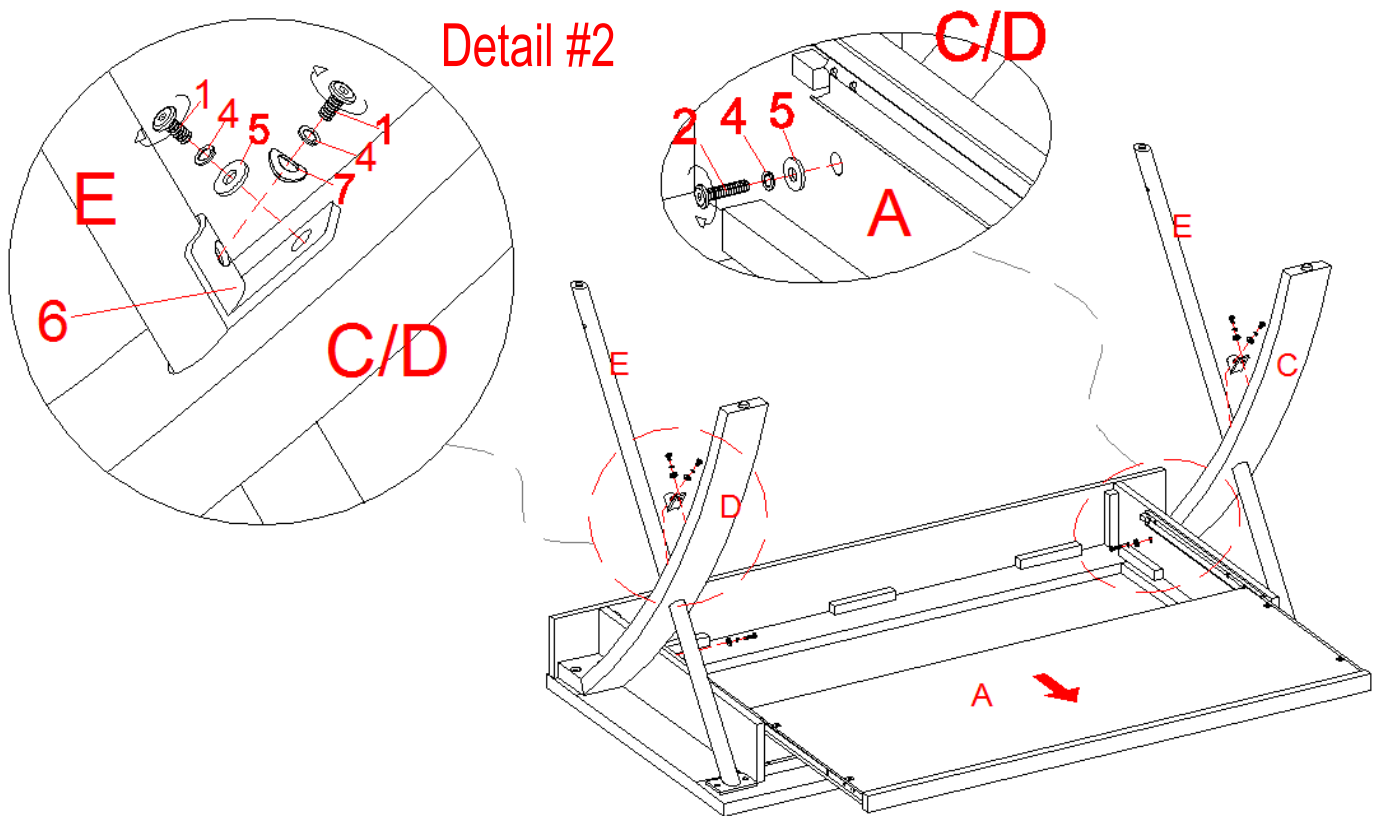

Required hardware in this step

Description:	(1) 3/4" Bolt	(2) 1-1/4" Bolt	(4) Lock Washer	(5) Flat Washer	(7) Camber Washer
Sketch					
Qty.	(4 pcs)	(2 pcs)	(6 pcs)	(4 pcs)	(2 pcs)
<u>Tools required:</u>	Allen Wrench				

Assembly Instructions

8. Snugly fit the Bottom Stretcher (F) between the drilled holes on the 2 Metal Legs (E). Apply pressure to the Metal Legs, if necessary. Insert one 1-3/4" Bolt (3) with the Lock Washer (4) and Camber Washer (7) through each Metal Leg (E) and screw into the inserted nut in the Bottom Stretcher (F). See detail #3.
9. Go back and securely tighten all bolts with the provided Allen Wrench. Push the keyboard tray in place, as shown in detail #3.

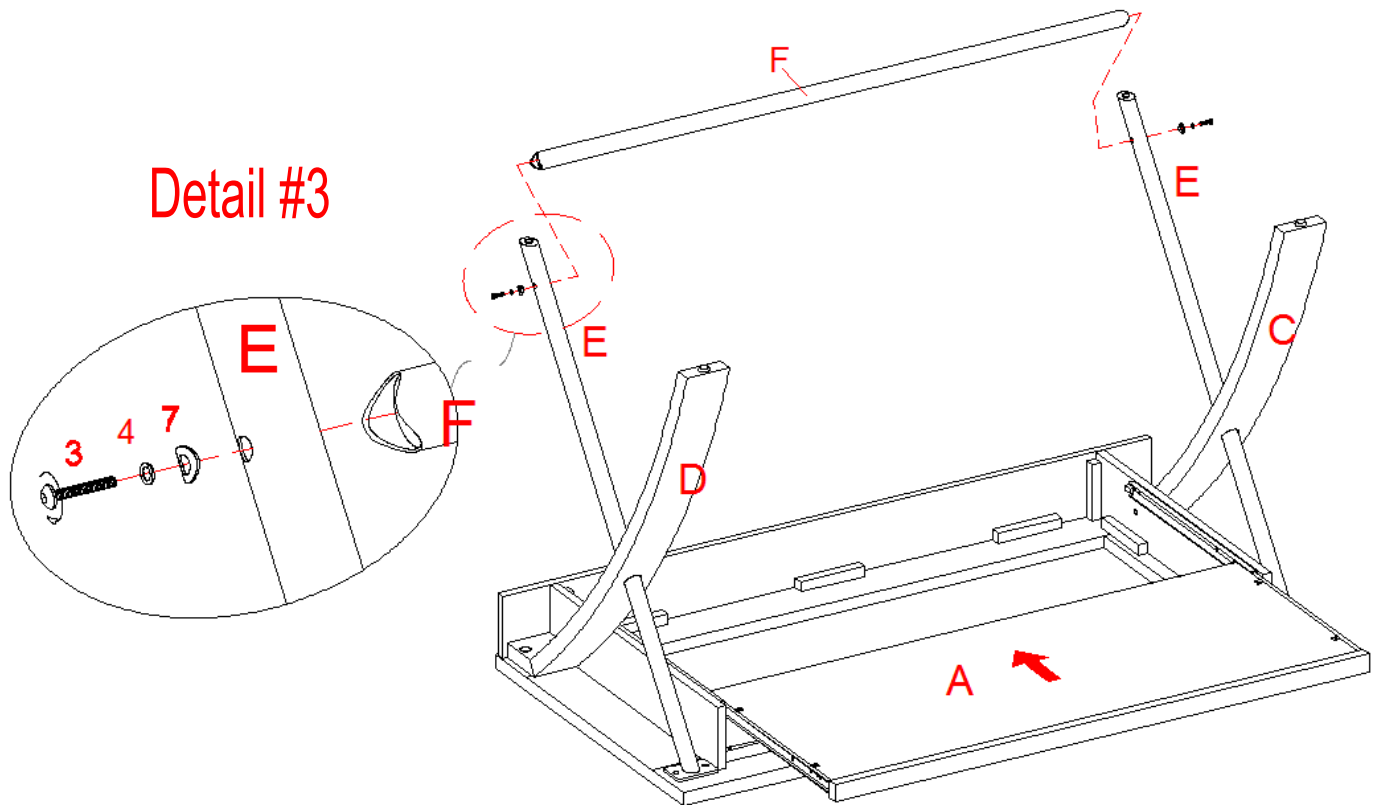

Required hardware in this step			
Description:	(3) 1-3/4" Bolt	(4) Lock Washer	(7) Camber Washer
Sketch			
Qty.	(2 pcs)	(2 pcs)	(2 pcs)
Tools required: Allen Wrench			

Assembly Instructions

10. Ask for assistance to stand the unit upright and position it at the desired location.

11. Position the Glass Top (B), with the black side of glass down, onto the Wood Top Frame (A).

NOTE: If the glass top is scratched, you can minimize the damage by using a **BLACK** marker and filling in scratched area from underneath.

12. In case of uneven floor, floor levelers are provided at the bottom of both Legs (C & D). To adjust unit in case of tilting, simply tilt the unit back and raise or lower floor leveler by hand to correct tilting. As shown in detail #4.

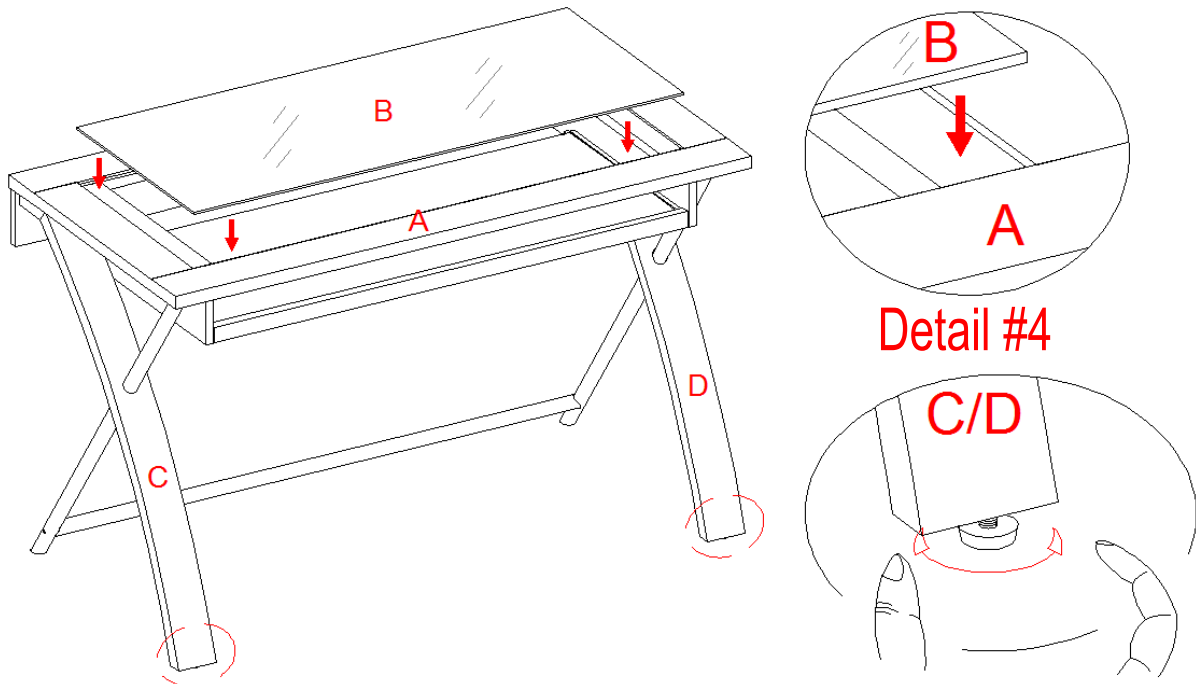

KEEP THESE INSTRUCTIONS FOR FUTURE REFERENCE

If the glass is chipped or broken, stop using the product and consult the manufacturer or supplier.

⚠ WARNING

- 1) Do not place very hot or very cold items on the glass surface(s) unless adequately thick tablemats are used to prevent such items from coming into contact with the glass.
- 2) Do not sit or stand upon the glass surface(s).
- 3) Do not use the glass as a chopping surface. Do not strike the glass with hard or pointed items.
- 4) When cleaning glass panels use a damp cloth or leather with washing up liquid or soft soap if necessary; do not use washing powders or any other substances containing abrasive since these substances scratch glass.

A Touch-up Pen (not included for item # ZTCD-W) has been provided to repair any small nicks or scratches that may occur during assembly or shipping.

Your assembly should now be complete.
Thank you for your purchase!

Please call for replacement parts or assistance: 1-866-942-5362
Golden Oak®

Page 7

Factory No. 16598

IF YOU NEED TO REQUEST ANY REPLACEMENT PARTS, PLEASE USE THE LIST BELOW

Zeta Computer Desk

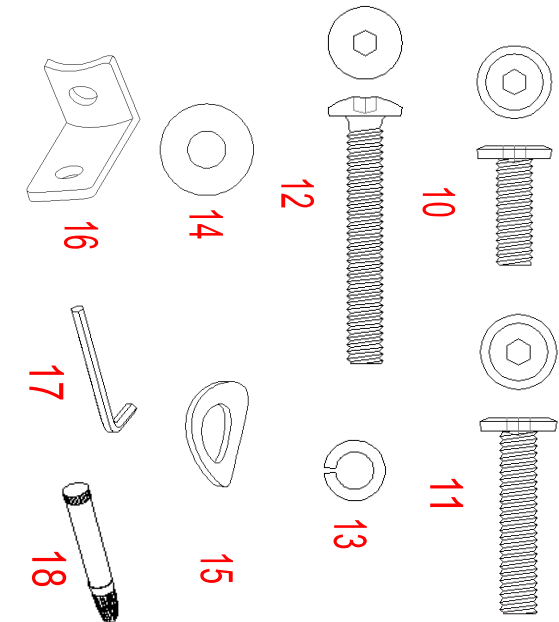
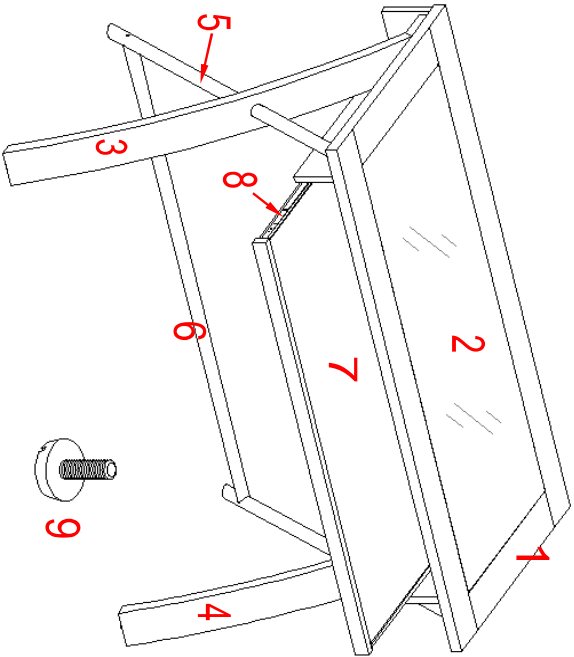

*ZTCD-B-1-WTF	Wood Top Frame
*ZTCD-B-2-GT	Glass Top
*ZTCD-B-3-LWL	Left Wood Leg
*ZTCD-B-4-RWL	Right Wood Leg
*ZTCD-B-5-ML	Metal Leg
*ZTCD-B-6-BS	Bottom Stretcher
*ZTCD-B-7-KT	Keyboard Tray
*ZTCD-B-8-KTS	Keyboard Tray Slides
*ZTCD-B-9-FL	Floor Leveler
*ZTCD-B-10-3/4B	3/4" Bolt
*ZTCD-B-11-1 1/4B	1 1/4" Bolt
*ZTCD-B-12-1 3/4B	1 3/4" Bolt
*ZTCD-B-13-LW	Lock Washer
*ZTCD-B-14-FW	Flat Washer
*ZTCD-B-15-CW	Camber Washer
*ZTCD-B-16-MB	Metal Bracket
*ZTCD-B-17-AW	Allen Wrench
*ZTCD-B-18-TUP	Touch Up Pen
*ZTCD-B-CH	Complete Hardware

*ZTCD-W-1-WTF	Wood Top Frame
*ZTCD-W-2-GT	Glass Top
*ZTCD-W-3-LWL	Left Wood Leg
*ZTCD-W-4-RWL	Right Wood Leg
*ZTCD-W-5-ML	Metal Leg
*ZTCD-W-6-BS	Bottom Stretcher
*ZTCD-W-7-KT	Keyboard Tray
*ZTCD-W-8-KTS	Keyboard Tray Slides
*ZTCD-W-9-FL	Floor Leveler
*ZTCD-W-10-3/4B	3/4" Bolt
*ZTCD-W-11-1 1/4B	1 1/4" Bolt
*ZTCD-W-12-1 3/4B	1 3/4" Bolt
*ZTCD-W-13-LW	Lock Washer
*ZTCD-W-14-FW	Flat Washer
*ZTCD-W-15-CW	Camber Washer
*ZTCD-W-16-MB	Metal Bracket
*ZTCD-W-17-AW	Allen Wrench
*ZTCD-W-CH	Complete Hardware