

Item # : BS64HPW

Assembly Instructions

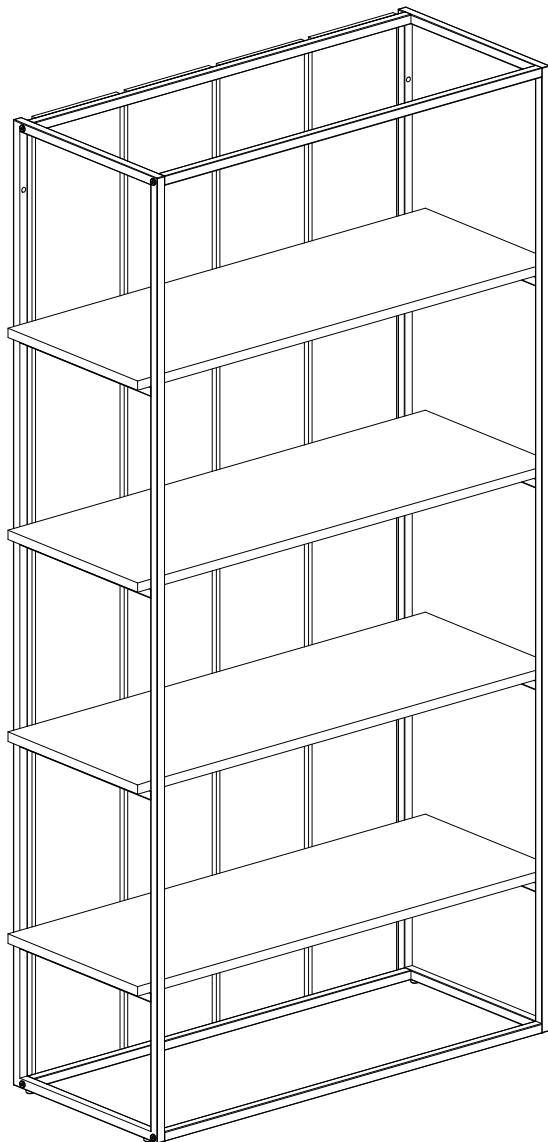

Walker Edison®

Please visit our website for the most current instructions, assembly tips, report damage, or request parts. www.walkerediton.com

Revised 22/10/2018

General Assembly Guidelines

- I. Ensure that all parts and hardware are available before beginning assembly.
- II. Follow each step carefully to ensure the proper assembly of this product.
- III. Two people are recommended for ease in the assembly of this product.
- IV. The main type of hardware used to assemble this product is: bolts.
- V. Power tools should not be used to assemble this product .

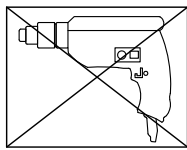

- VI. Drill may be needed for securing product to wall.

Parts List

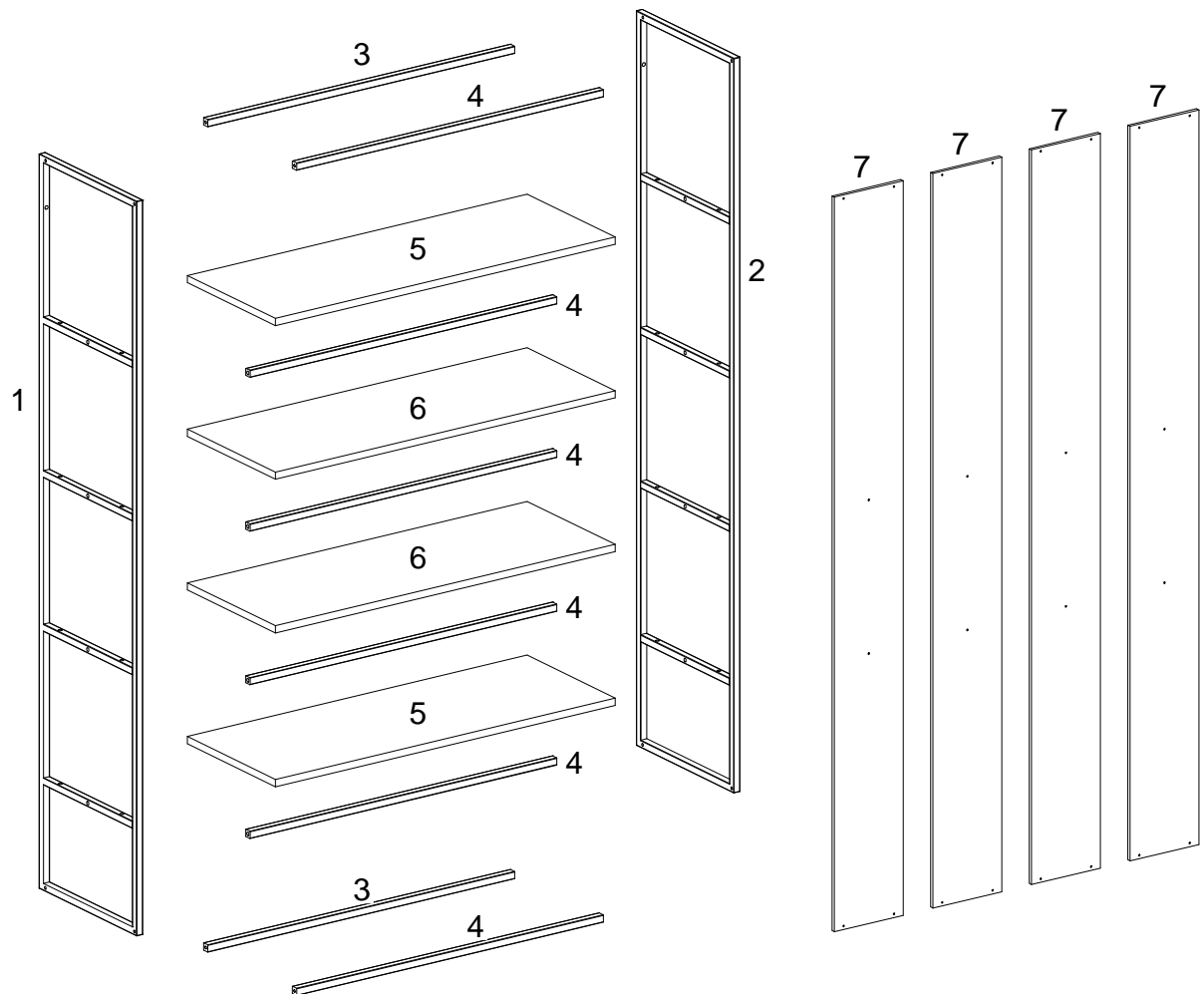

Hardware List

A		Ø1/4"x25mm	Bolt	32 pcs
B		Ø4x20mm	Screw	24 pcs
C		Ø1/4"x12mm	Adjustable foot	4 pcs
D		4mm	Hex Key	1 pcs
E			Anchor	2 pcs
F		Ø4x45mm	Screw	2 pcs
G		Ø16*6.5*1.0mm	Washer	2 pcs

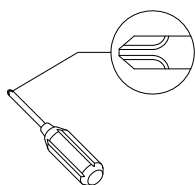

Philips head screwdriver required for assembly
(not included)

*The hardware quantities listed above are required for proper assembly.
Some extra hardware may also have been included.*

Step 1

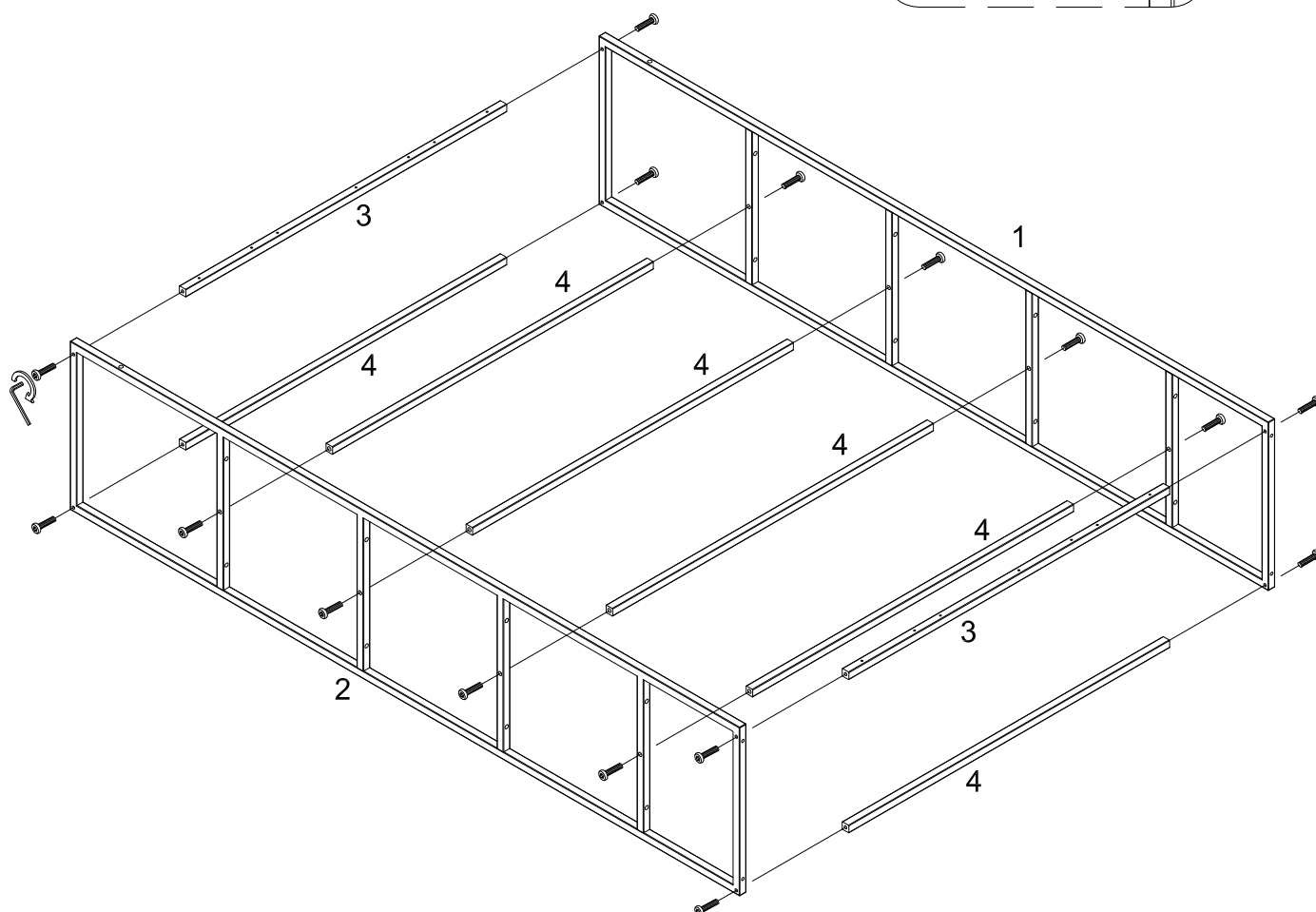
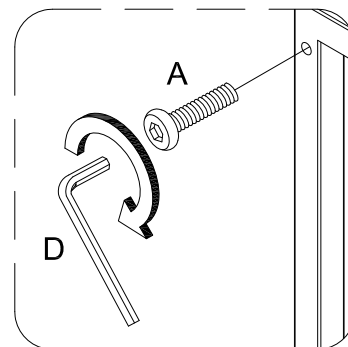

Attach part (3, 4) to part (1, 2) using bolt (A) with hex key (D).

Step 2

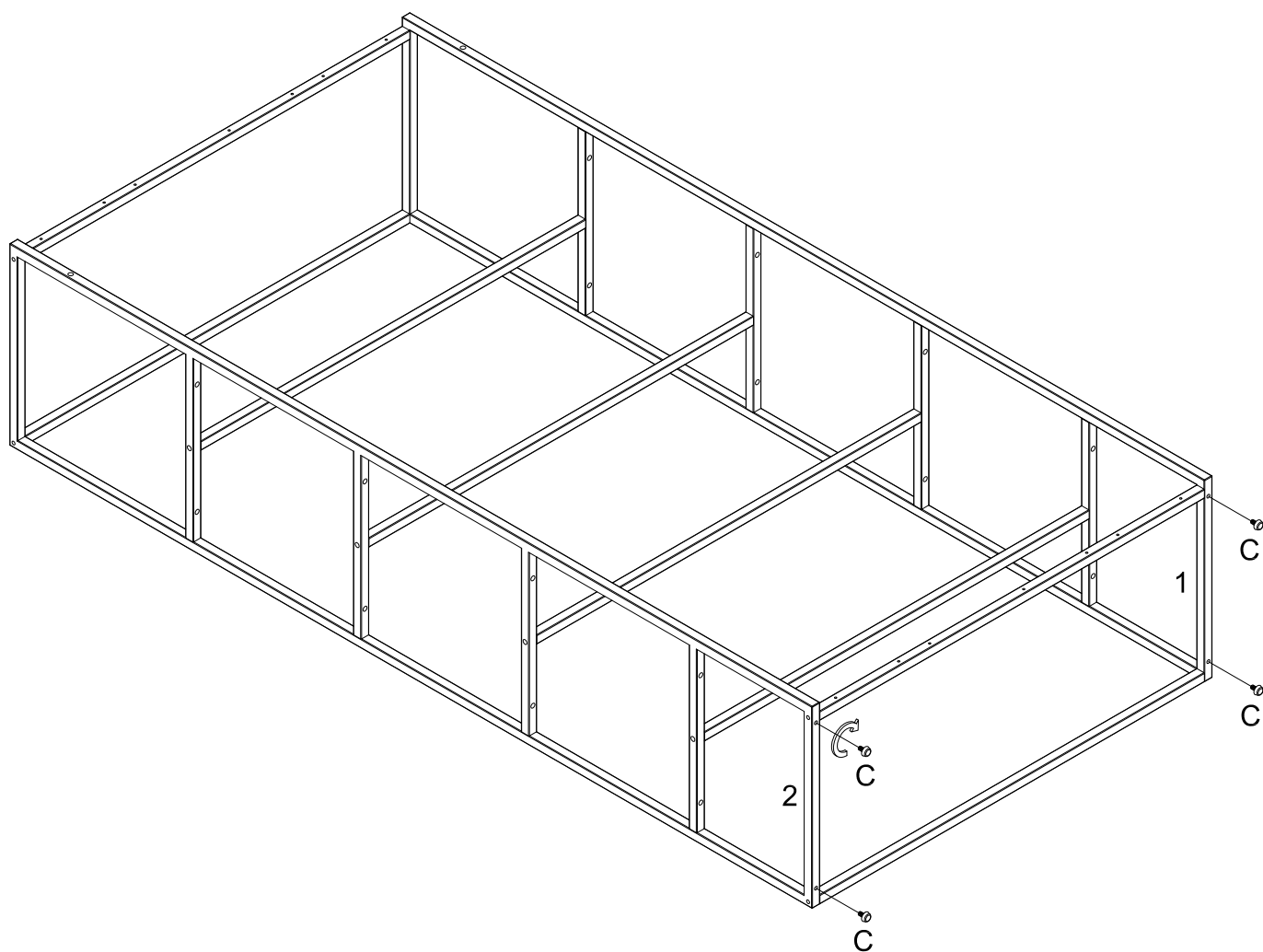

Screw adjustable foot (C) to part (2).

Step 3

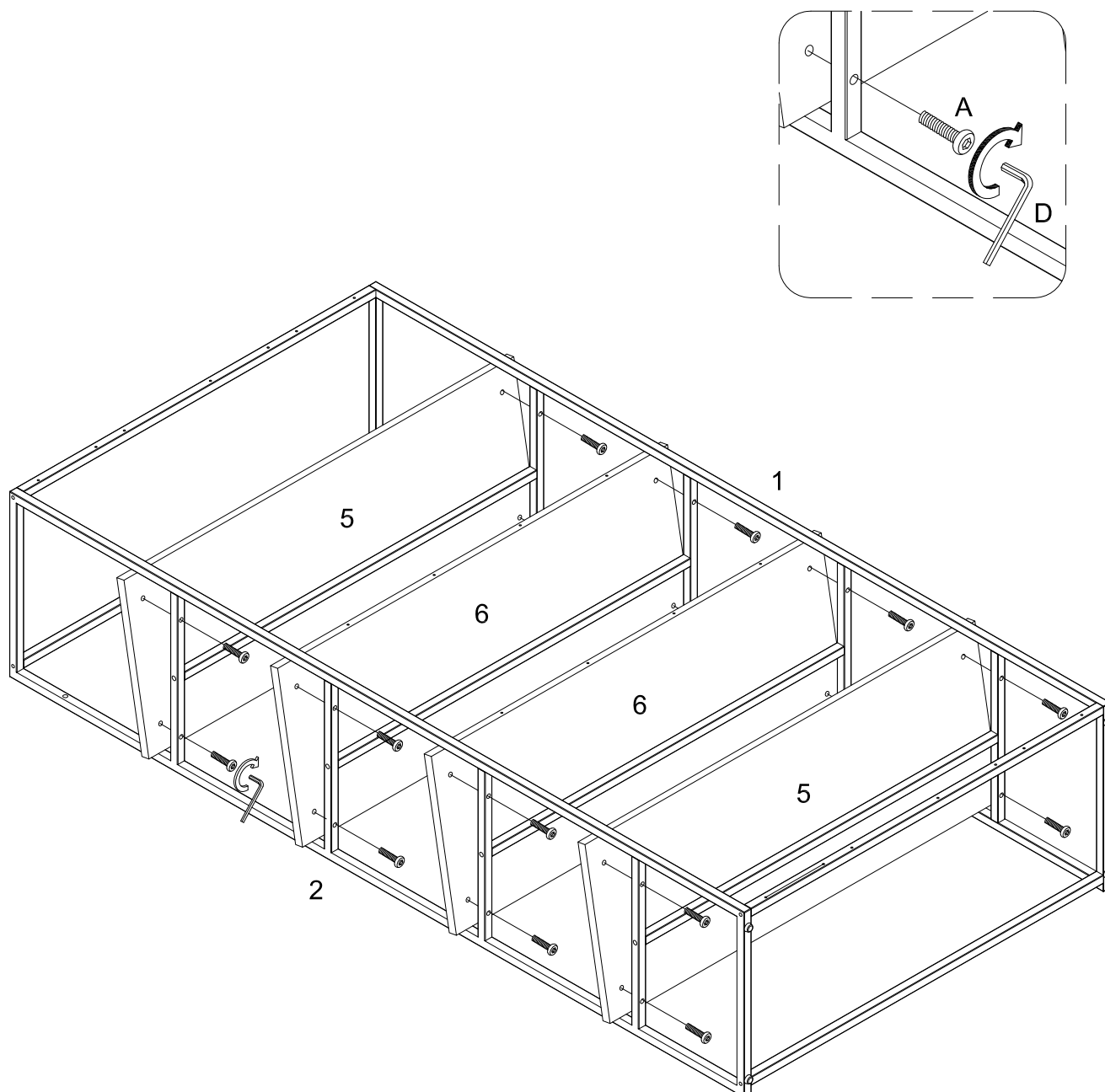

Attach part (5, 6) to part (1, 2) using bolt (A) with hex key (D) per diagram.

Step 4

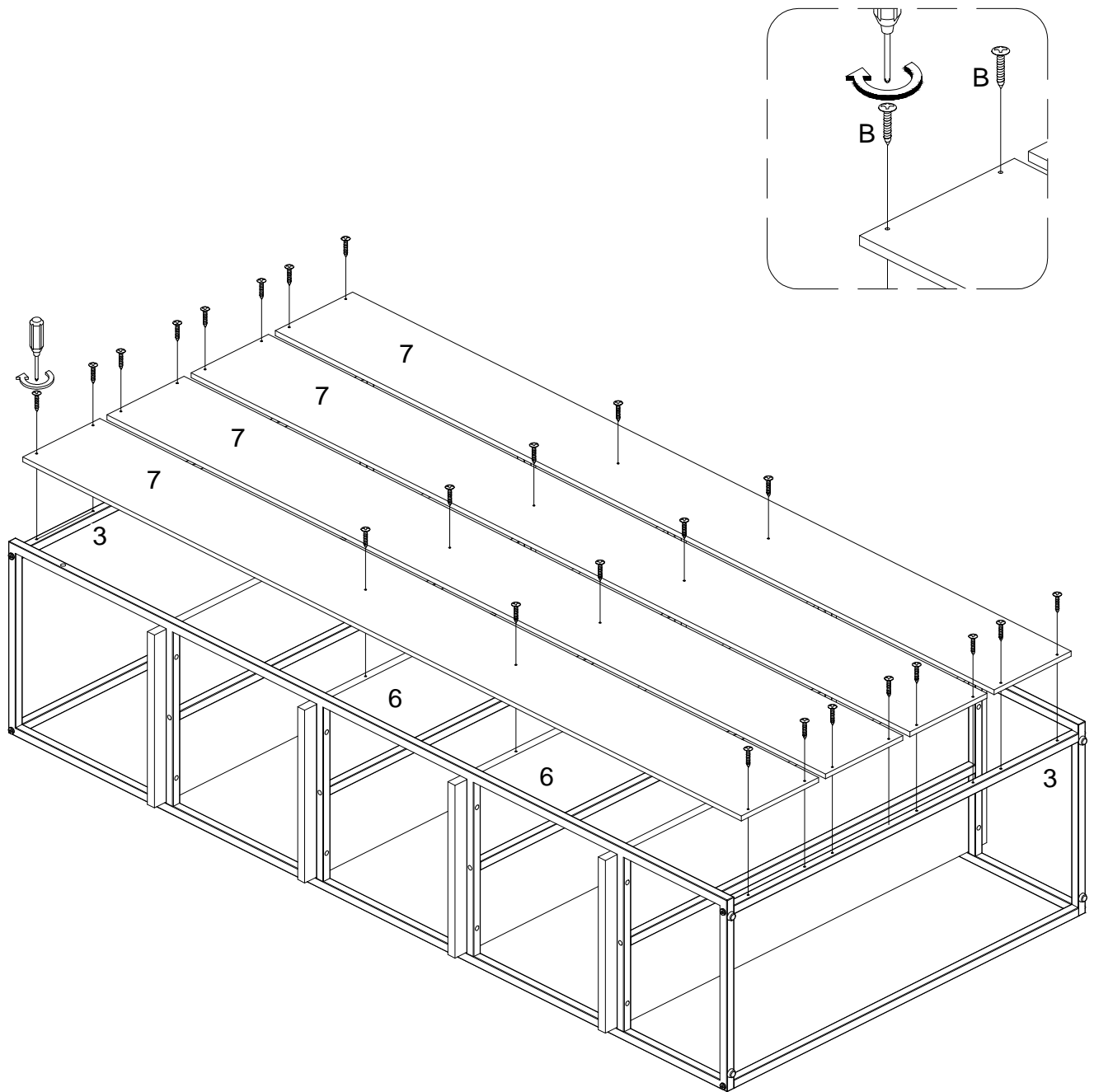

Attach part (7) to part (3, 6) using screw (B) with Philips head screwdriver.

Step 5

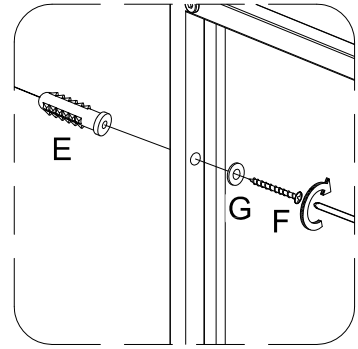
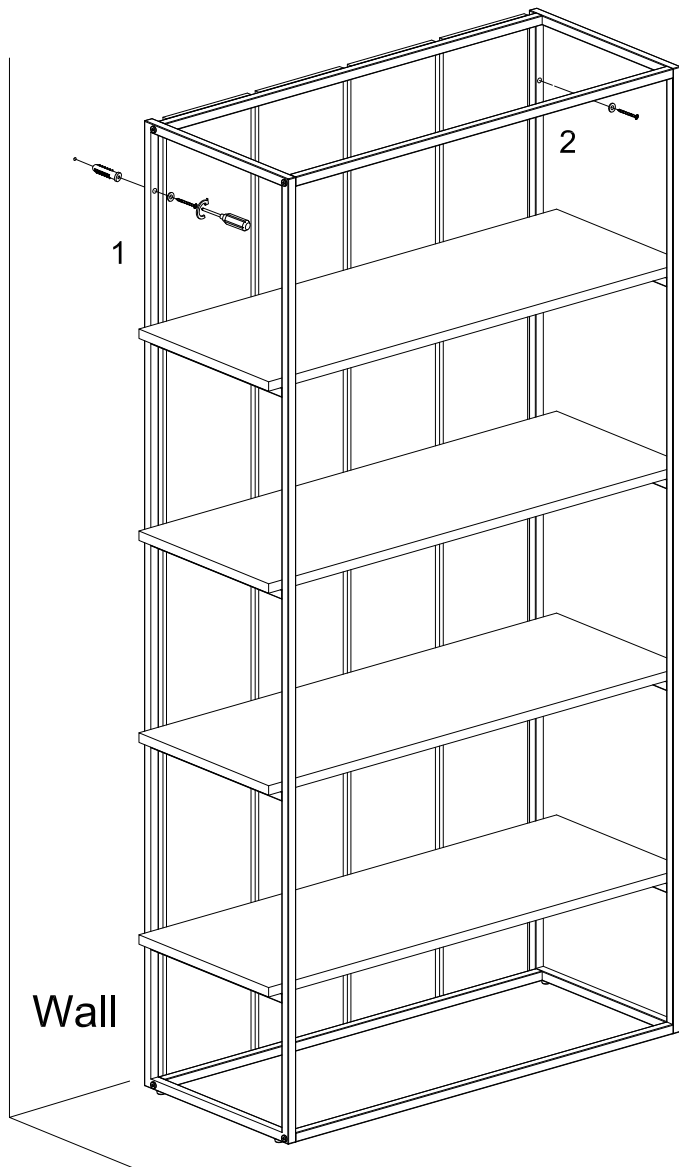

1. Place unit in desired location and mark the wall for anchor location, drill hole using 6mm size bit.
2. Insert anchor (E) into wall at desired location.
3. Secure furniture to wall using washer (G) and screw (F) per diagram.

* Wall anchor included for drywall mounting. Use correct anchor and hardware for your wall material.

Step 6

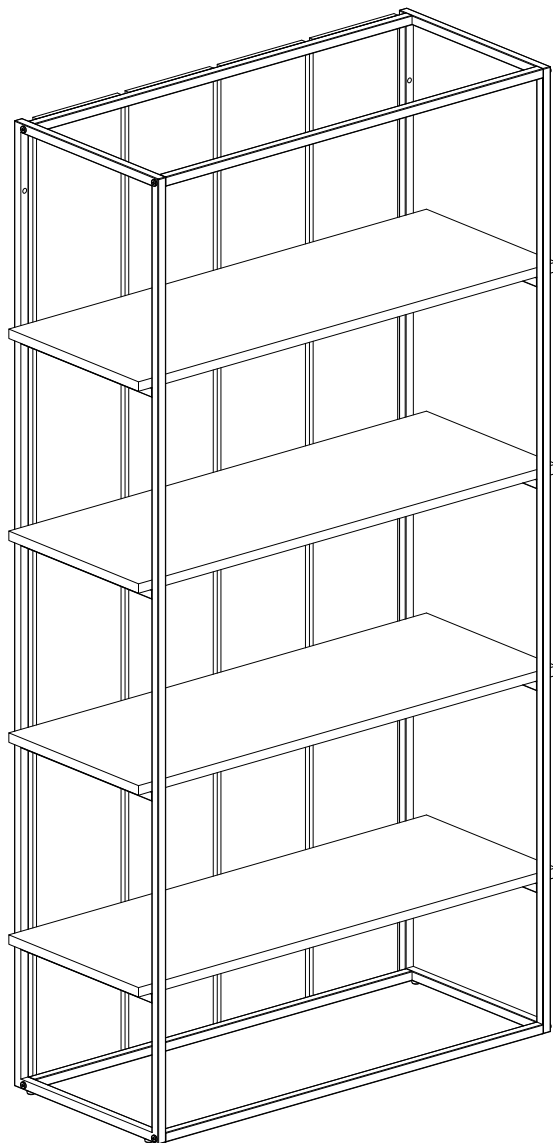

Final Assembly