

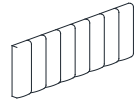

# PARTS LIST / LISTE DES PIÈCES / LISTA DE PIEZAS

ITEM NO. / ARTICLE NO. / ARTICULO NO :DS-D538-290-1

DESCRIPTION / LA DESCRIPTION / DESCRIPCIÓN : QUEEN BED/GRAND LIT/CAMA QUEEN

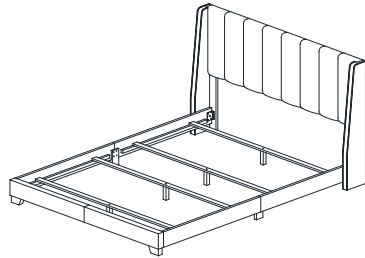

**A**

x1 Headboard Panel  
x1 Tête de lit  
x1 Panel de cabecera

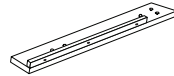

**B1**

x1 Left leg \*  
x1 Patte de gauche  
x1 Pata izquierda

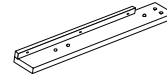

**B2**

x1 Right Leg \*  
x1 Patte de droite  
x1 Pata derecha

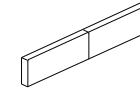

**C**

x1 Footboard Panel  
x1 Pied de lit  
x1 Tablero de pie de cama



**D**

x2 Footboard Leg \*  
x2 Pattes de pied de lit  
x2 Patas del pie de cama

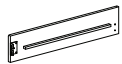

**E**

x2 Side Rail  
x2 Côtés de lit  
x2 Largueros laterales

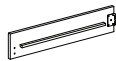

**F**

x2 Side Rail  
x2 Côtés de lit  
x2 Largueros laterales



**G**

x1 Headboard Left Wings  
x1 Panneaux latéraux de tête de lit gauche  
x1 Laterales de cabecera izquierda



**H**

x1 Headboard Right Wings  
x1 Panneaux latéraux de tête de lit droite  
x1 Laterales de cabecera derecha



**I**

x2 Center Leg \*  
x2 Pattes centrales  
x2 Patas centrales



**J**

x4 Slat \*  
x4 Lattes  
x4 Listones



**K**

x4 Support Leg \*  
x4 Pied  
x4 Pierna de soporte



**L**

x8 Allen Bolt M8 x 20 \*  
x8 Vis à tête creuse hexagonale  
M8 x 20  
x8 Perno Allen M8 x 20



**M**

x8 Allen Bolt M6 x 25 \*  
x8 Vis à tête creuse hexagonale  
M6 x 25  
x8 Perno Allen M6 x 25



**N**

x16 Allen Bolt M6 x 35 \*  
x16 Vis à tête creuse hexagonale  
M6 x 35  
x16 Perno Allen M6 x 35

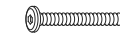

**O**

x2 Allen Bolt M6 x 70 \*  
x2 Vis à tête creuse hexagonale  
M6 x 70  
x2 Perno Allen M6 x 70



**P**

x2 Wood Dowel \*  
x2 Goujon en bois  
x2 Tarugo de madera



**Q**

x20 Spring Washer \*  
x20 Rondelle à ressort  
x20 Arandela auto-bloquante



**R**

x20 Flat Washer \*  
x20 Rondelle plate  
x20 Arandela plana



**S**

x8 Screw M4 x 32 \*  
x8 Vis M4 x 32  
x8 Tornillo M4 x 32



**T**

x6 Screw M4 x 38 \*  
x6 Vis M4 x 38  
x6 Tornillo M4 x 38



**U**

x1 Allen Wrench M5 x 65 \*  
x1 Clé hexagonale M5 x 65  
x1 Llave Allen M5 x 65



**V**

x1 Allen Wrench M4 x 100 \*  
x1 Clé hexagonale M4 x 100  
x1 Llave Allen M4 x 100

\* Replaceable Part



**ASSEMBLY INSTRUCTIONS / NOTICE DE MONTAGE / INSTRUCCIONES DE MONTAJE**

ITEM NO. / ARTICLE NO. / ARTICULO NO :DS-D538-290-1

DESCRIPTION / LA DESCRIPTION / DESCRIPCIÓN : QUEEN BED/GRAND LIT/CAMA QUEEN

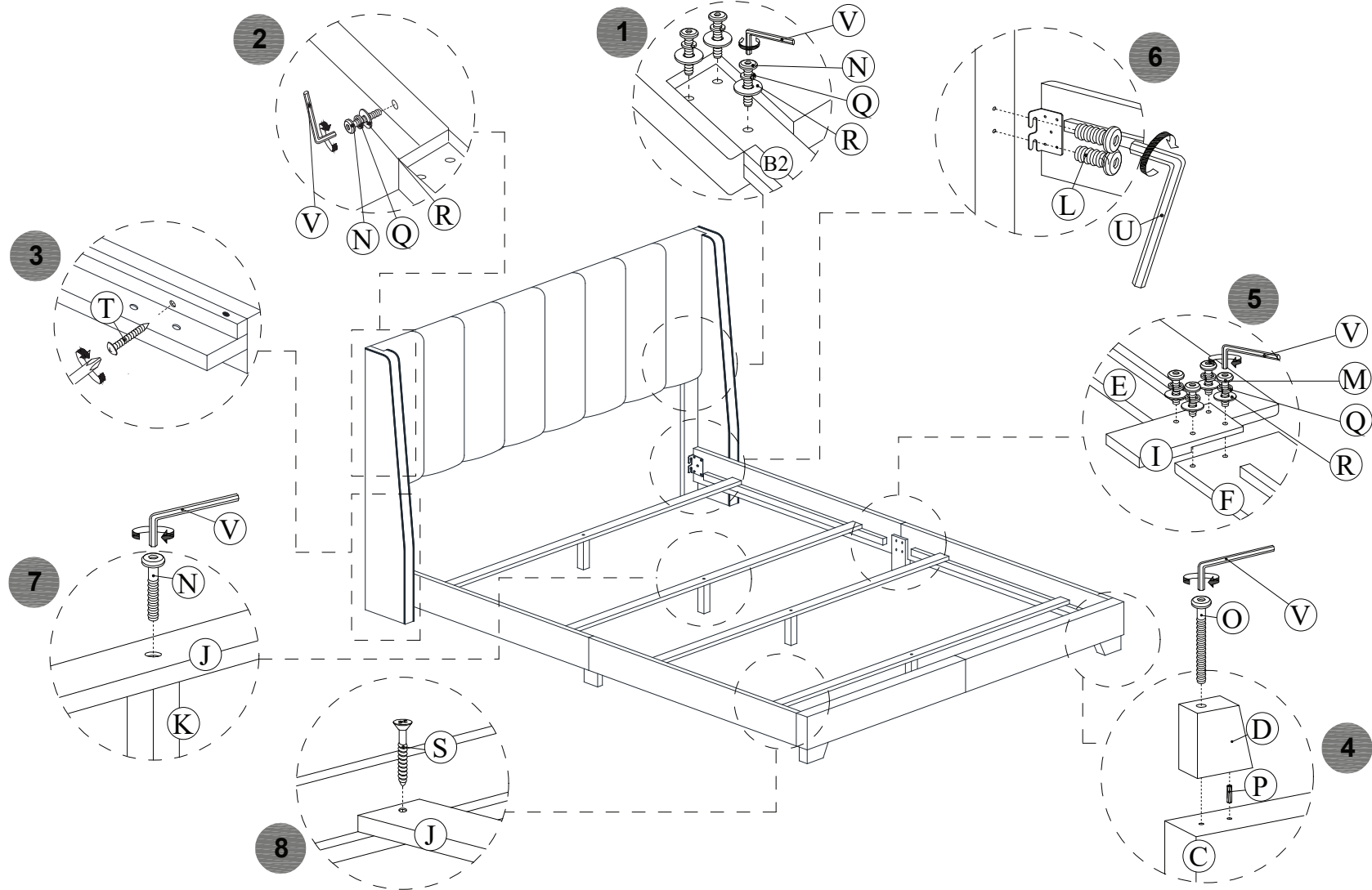



**REPLACEABLE PART / PARTIE REMPLACABLE / PARTE REEMPLAZABLE**

ITEM NO. / ARTICLE NO. / ARTICULO NO :DS-D538-290-1

DESCRIPTION / LA DESCRIPTION / DESCRIPCIÓN : QUEEN BED/GRAND LIT/CAMA QUEEN

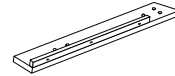

x1 RD538-290-LEGL-Headboard Left Leg \*  
Patte de gauche  
Pata izquierda

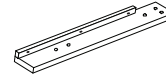

x1 RD538-290-LEGR-Headboard Right Leg \*  
Patte de droite  
Pata derecha



x2 RD538-290-FOOT-Foot \*  
Pattes de pied de lit  
Patatas del pie de cama



x2 RD538-290-CELEG-Center Leg \*  
Pattes centrales  
Patatas centrales



x4 RD538-290-SLAT-Slat \*  
Lattes  
Listones

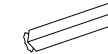

x4 RD538-290-SULEG-Slat Support Leg \*  
Pied  
Pierna de soporte

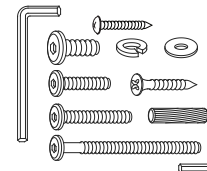
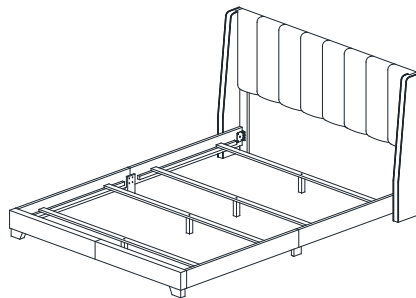

x1 RD538-288-HWKIT-Hardware kit \*  
Liste des pièces de quincaillerie  
Lista del kit de materiales

\* Replaceable Part

## **Protect Your Wood or Laminate Flooring**

\*This statement applies to any floor without carpet.

If not careful, all furniture including upholstery and case pieces can scratch, scuff and even gouge floors. The recommendation is to have felt, rubber pads or area rugs under furniture on flooring without carpet.

### **Moving your furniture**

Pushing and dragging furniture over floors without carpet can lead to scratches and scuffs. Have someone help when moving the larger pieces of furniture by lifting, try using a dolly or moving pads.

### **Felt and rubber pads**

Applying furniture pads to the feet of furniture helps cushion contact points. Furniture pads can be found at local hardware stores. Felt pads slide easily across the floor, making them ideal for dining chairs and other pieces that move with use. Rubber pads will help furniture stay in place and are perfect for larger pieces, like sofas and loveseats.

### **Area rugs and rug pads**

Using an area rug under furniture is another way to protect your floor from scratches and scuff marks. A rug pad under the area rug will provide extra cushion and added protection.