

ROOMS TO GO KIDS

Manufactured for Rooms to Go

SUGAR HOLLOW COLLECTION

THANK YOU FOR YOUR PURCHASE

- Read all the instructions, identify all components, and be sure you have all parts prior to assembly
- DO NOT Use substitute parts. Contact your local Rooms To Go or visit www.ROOMSTOGO.COM for replacement parts and instructional literature if needed.

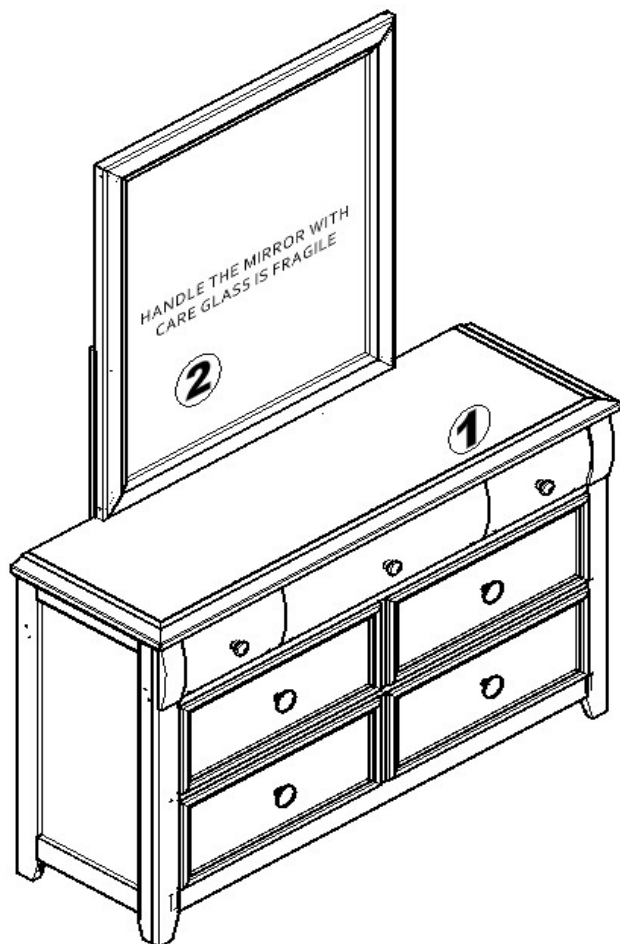

7 DRW DRESSER&LANDSCAPE MIRROR BLACK

RTG SKU #	STYLE #	ITEM DESCRIPTION
34118097	18B-207	7 DRAWER DRESSER
34018071	18C-300	LANDSCAPE MIRROR

7 DRW DRESSER&LANDSCAPE MIRROR WHITE

RTG SKU #	STYLE #	ITEM DESCRIPTION
34118073	18W-207	7 DRAWER DRESSER
34018071	18C-300	LANDSCAPE MIRROR

PARTS LIST

QTY

1

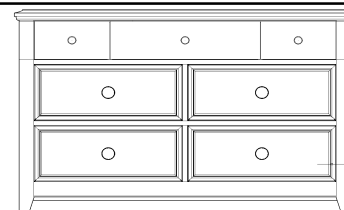

7 DRAWER DRESSER

1 PCS

2

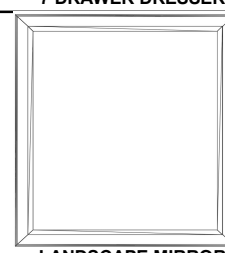

LANDSCAPE MIRROR

1 PCS

HARDWARE LIST [HPK00185-0]

QTY

A



WOOD SUPPORT

2 PCS

B

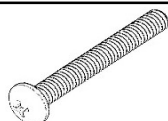

1 3/8" SCREW

8 PCS

C



1" WASHER #10 ZINC

8 PCS

TOOLS NEEDED

PHILLIPS SCREWDRIVER [NOT INCLUDED]

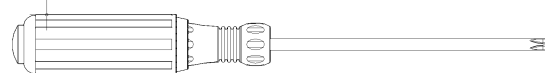

**TWO PEOPLE ARE NEEDED TO ASSEMBLE
DO NOT TIGHTEN COMPLETELY UNTIL ALL PIECES
ARE CONNECTED TOGETHER**

ASSEMBLY INSTRUCTIONS

STEP #1

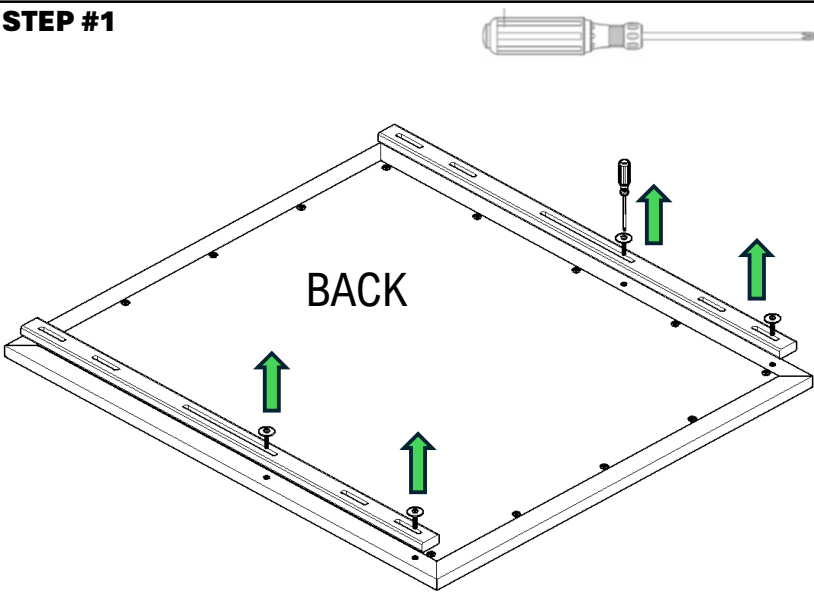

Place mirror on a flat surface front down, then remove all four screws and washers.

STEP #2

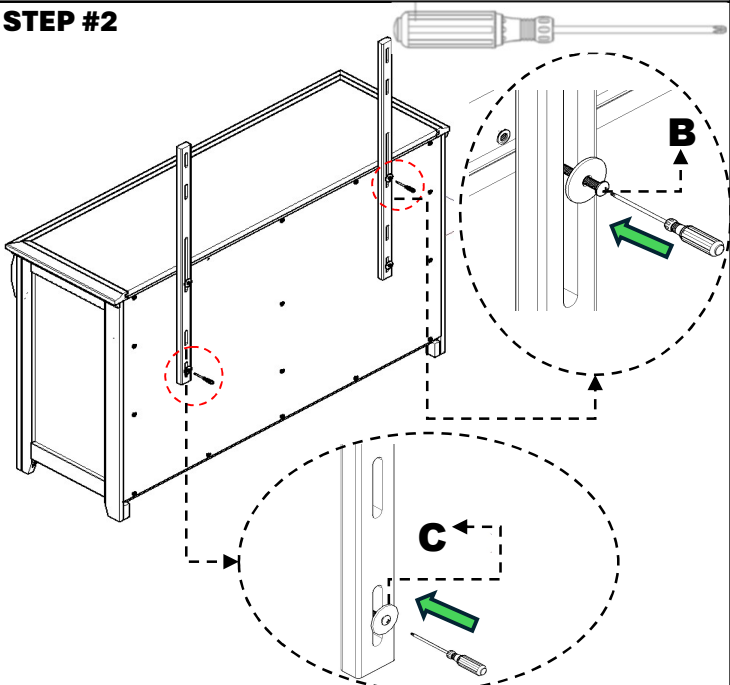

Assemble wood supports on the back of dresser

STEP #3

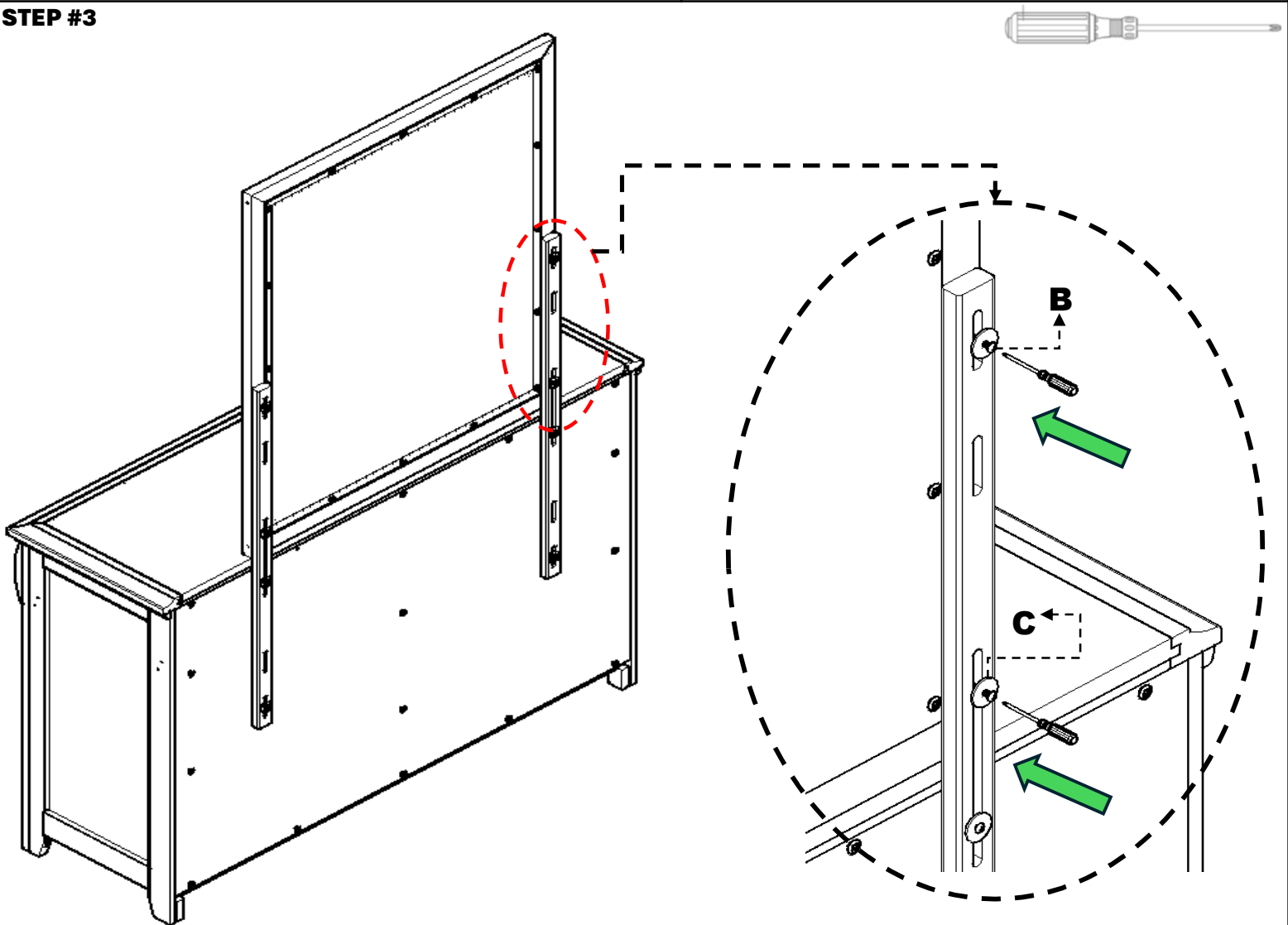

Attach mirror to dresser **MAKE SURE ALL SCREWS ARE TIGHTENED COMPLETELY** (Do not over tighten)