

# ALYSSA

## 7591 - 160 TWIN STORAGE TRUNDLE

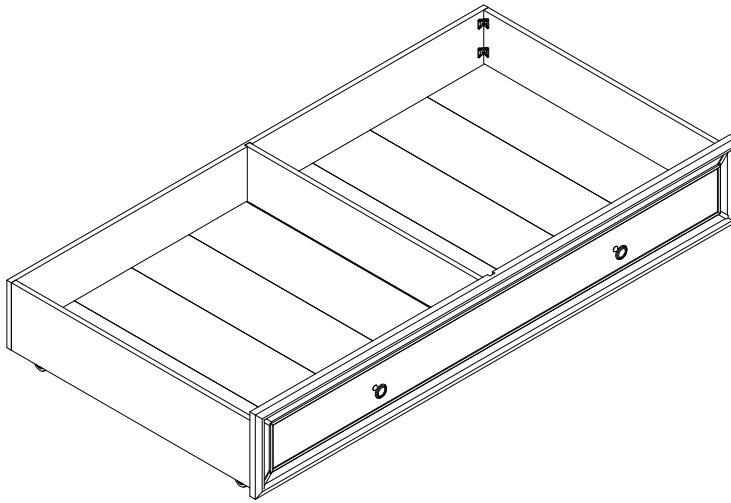

Package No.:		FULL BED	
SKU#	STYLE	COLOR	ITEM DESCRIPTION
35775913	7591-160	WHITE	TRUNDLE

### HARDWARE PACK LOCATION

SKU#	STYLE	COLOR	ITEM DESCRIPTION
35775913	7591-160	WHITE	TRUNDLE

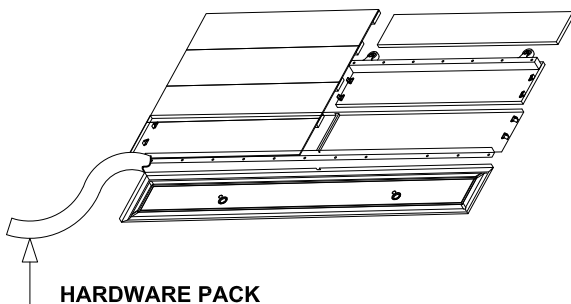

TRUNDLE PARTS LIST			
	ITEM DESCRIPTION	IMAGE	Q'TY
A	TRUNDLE FRONT		1 PC
B	TRUNDLE SIDE		2 PCS
C	TRUNDLE BACK		1 PC
D	TRUNDLE MIDDLE PARTITION		1 PC
E	TRUNDLE BOTTOM PANEL		2 PCS
F	METAL BAR		1 PC

HARDWARE LIST			
	ITEM DESCRIPTION	IMAGE	Q'TY
1	"L" PLASTIC PLATE		2 PCS
2	4*5/8MM SCREW		6 PCS
3	PHILIPS SCREWDRIVER (NOT PROVIDED)		
4	(L57x4MM) ALLEN KEY		1 PC

DO NOT USE SUBSTITUTE PARTS. PLEASE CONTACT YOUR RETAIL STORE OR [WWW.ROOMSTOGO.COM](http://WWW.ROOMSTOGO.COM) WITH SERVICE OR PARTS REPLACEMENT REQUEST.

This product is manufactured by RIEE for **ROOMS TO GO® | KIDS**

# ALYSSA

## 7591 - 160 TWIN STORAGE TRUNDLE

Thank you for purchasing this quality product. Be sure to check all packing material carefully for small parts which may have come loose inside the carton during shipment. Identify and count all parts and compare with the parts list below. Read all instructions before assembling bed and keep these instructions for future reference.

### Assembly instructions:

#### STEP 1

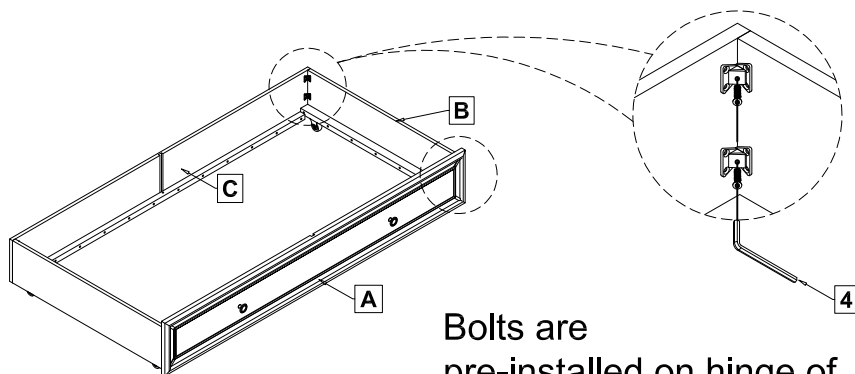

Bolts are pre-installed on hinge of Trundle front and Trundle back .

**Attach the Trundle Side (B) to the Trundle front (A) and Trundle Back (C). Tighten with Allen Bolts with Allen Key provided (4) by screwing them into place.**

#### STEP 2

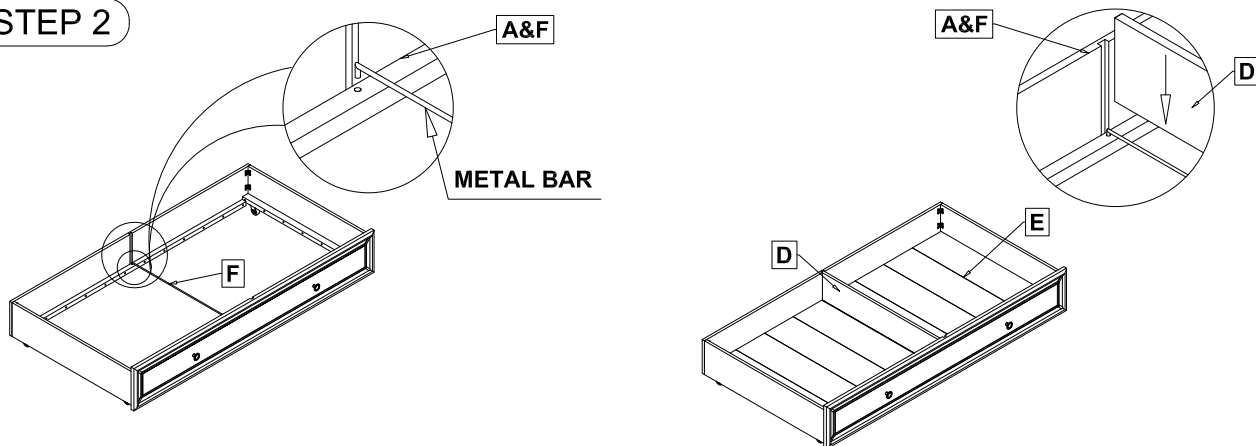

**Attach the Metal Bar (F) and Partition(D) to the Trundle front (A) and Trundle back(C).**

DO NOT USE SUBSTITUTE PARTS. PLEASE CONTACT YOUR RETAIL STORE OR [WWW.ROOMSTOGO.COM](http://WWW.ROOMSTOGO.COM) WITH SERVICE OR PARTS REPLACEMENT REQUEST.

This product is manufactured by RIEE for **ROOMS TO GO® | KIDS**

# ALYSSA

## 7591 - 160 TWIN STORAGE TRUNDLE

Thank you for purchasing this quality product. Be sure to check all packing material carefully for small parts which may have come loose inside the carton during shipment. Identify and count all parts and compare with the parts list below. Read all instructions before assembling bed and keep these instructions for future reference.

### Assembly instructions:

#### STEP 3

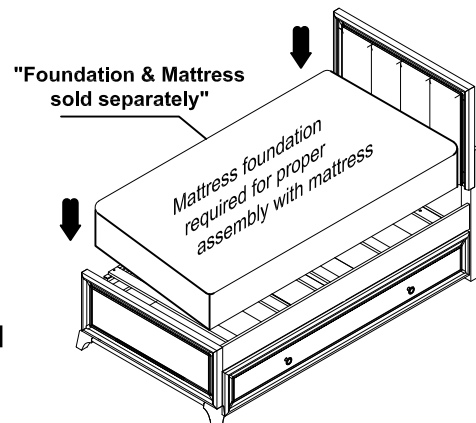
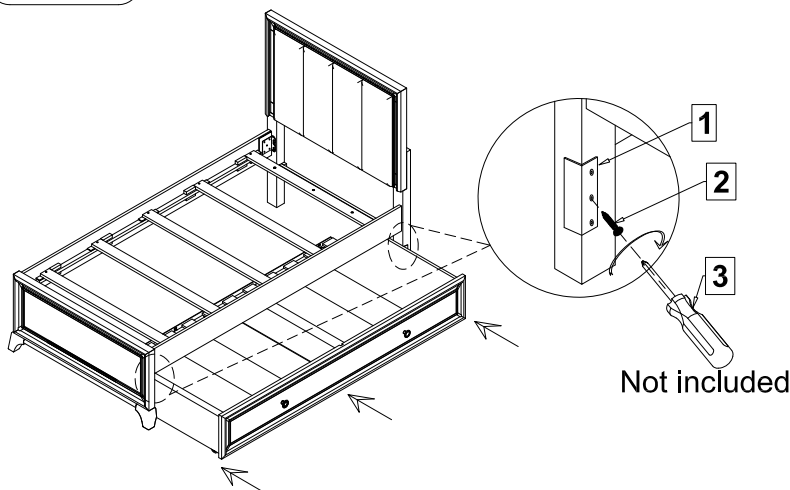

**TWIN BED TRUNDLE**

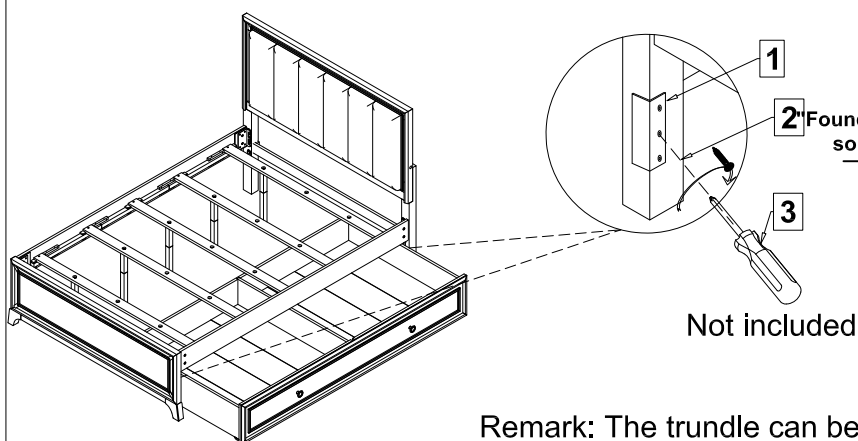

Remark: The trundle can be sliding from left or Right side of Full bed.

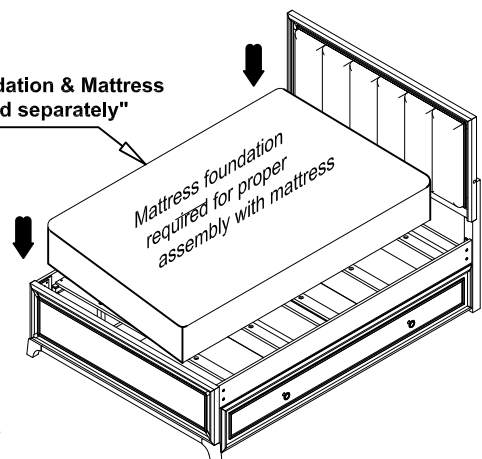

**FULL BED TRUNDLE**

Attach "L" PLASTIC PLATE (1) to the Headboard legs and Footboard legs. Tighten Screws(2) with PhilipsScrewdriver (3) (not provided) by screwing into place.

NOTE:When using a storage trundle for Full Bed, Please attach support leg on the left or right sides of the Slat.

DO NOT USE SUBSTITUTE PARTS. PLEASE CONTACT YOUR RETAIL STORE OR [WWW.ROOMSTOGO.COM](http://WWW.ROOMSTOGO.COM) WITH SERVICE OR PARTS REPLACEMENT REQUEST.

This product is manufactured by RIEE for **ROOMS TO GO® | KIDS**