

Additional Tools Required: Allen Wrench

ASSEMBLY INSTRUCTIONS

1. Using the diagram included, identify all parts.
2. Use pliers to remove plastic hardware packet and staples from the wood frame.
3. Sort and pair all bolts, locking washers, washers and screws. Pair all bolts with locking washers and washers using the diagram, the locking washer always goes on the bolt first.
4. Lay chair back assembly on a clean protected surface, face side up.
5. Attach the seat assembly to the back assembly by aligning holes on seat and back. The holes should align. **Using parts E,B and A insert bolt** with washers in the center hole, hand tighten.
6. **Using parts G,B and A insert bolts** into the left and right corner blocks on each side of the back of the seat assembly, hand tighten. (bolts should tighten easily, if needed adjust the angle of the seat to help with clearance.)
7. Attach front legs into front of the seat assembly Using parts A,B and F. Hand tighten only.
8. Set chair upright.
9. Identify left and right arms. Attach by **inserting the parts F,B and A** into the bottom of the arm under the seat assembly. Hand tighten only. Align the back of the arm with the chair back assembly, from the backside attach by using **part H**.. Hand Tighten Only.
10. Tighten all bolts ¼ turn beyond hand tightened using the tools provided, inset **wooden cover(I)** into holes on the outside of back assembly. Your chair is now complete – Enjoy!!

CHAIR

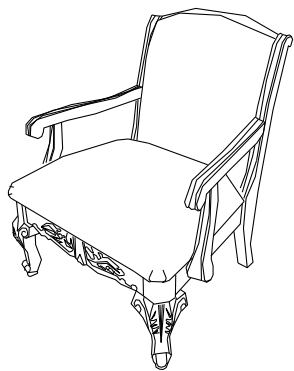
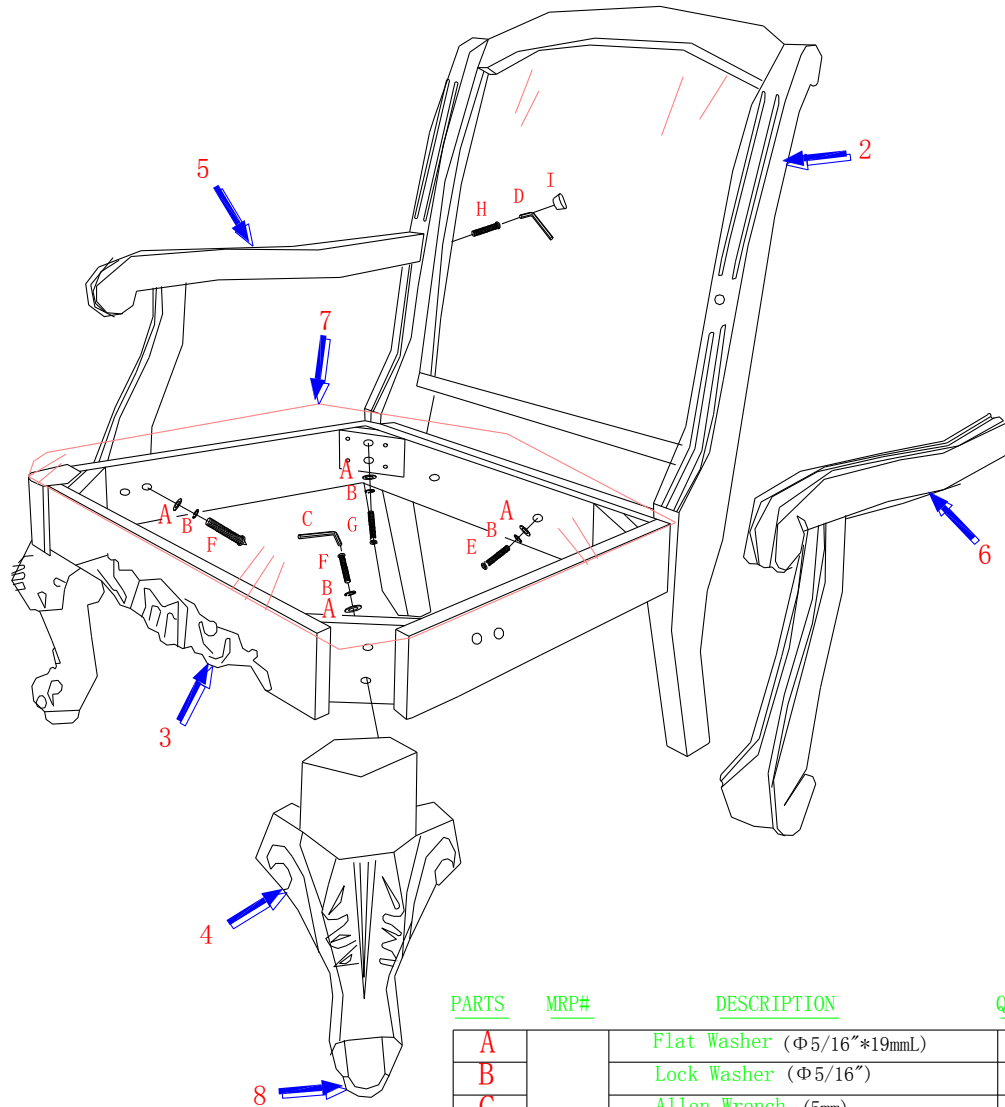

PARTS	MRP#	DESCRIPTION	Q' TY
A	1	Flat Washer (Φ5/16"*19mmL)	14
B		Lock Washer (Φ5/16")	14
C		Allen Wrench (5mm)	1
D		Allen Wrench (4mm)	1
E		Bolts (Φ5/16"*1-1/2"L)	6
F		Bolts (Φ5/16"*2-1/4"L)	4
G		Bolts (Φ5/16"*3"L)	4
H		Bolts (Φ1/4"*1-3/4"L)	2
I		Wood Plug (Φ14mm)	2
2	2	Chair Back	1
3	3	Seat Frame	1
4	4	Front Leg	2
5	5	Left Arm	1
6	6	Right Arm	1
7	7	Seat Cushion(Pre-assembled)	1
8	8	Floor Glide(Pre-assembled)	4