

**STEP 1 :** Turn over the Server, attached the Tipping Restraint (1) to the wall as diagram below :

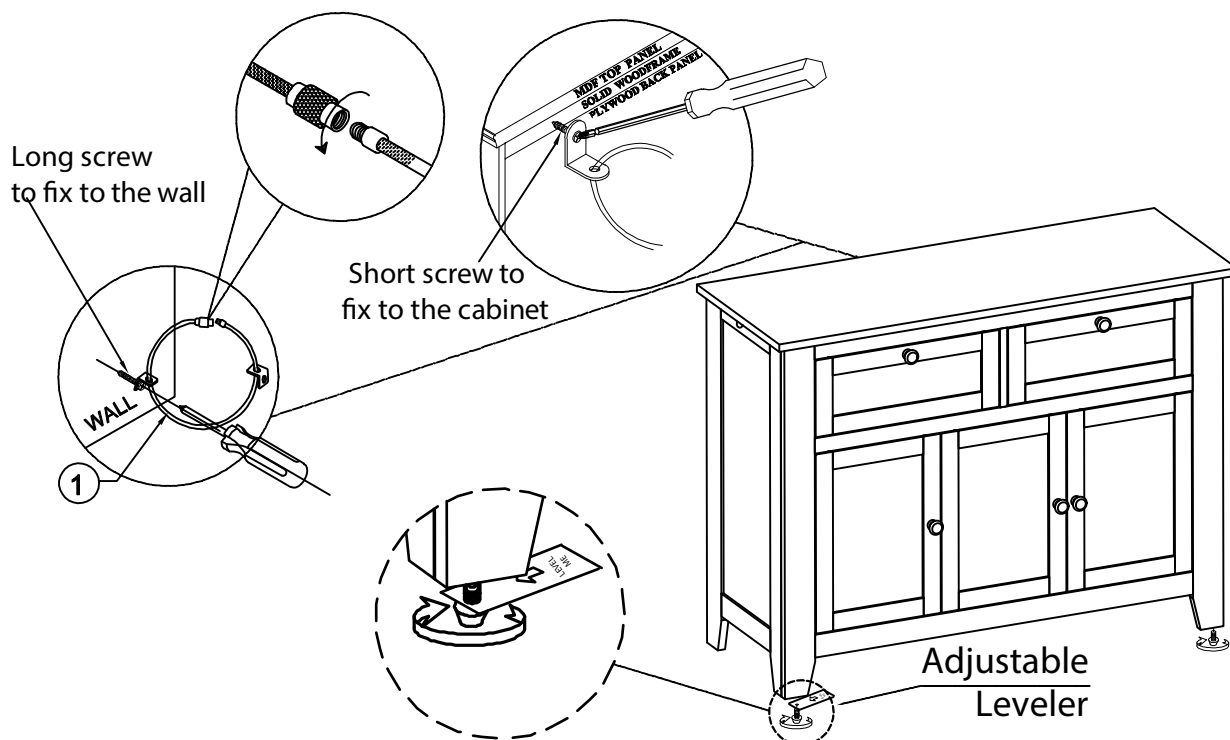

**STEP 2 :**

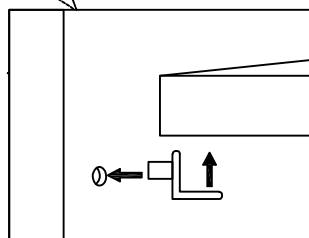
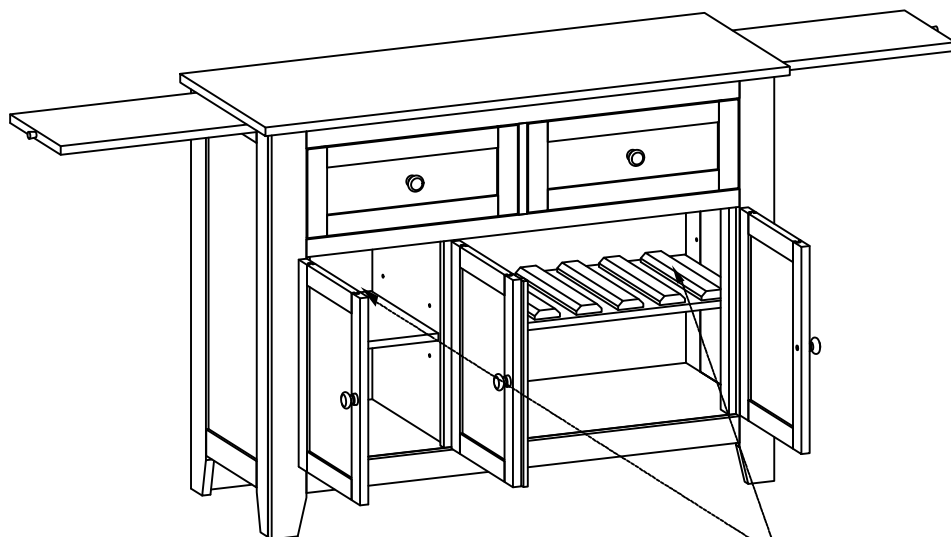

**Remarks :**

The unit includes an adjustable shelf that had been secured prior to shipping. If you wish to change the position of the shelf, you must first remove the set screw from the bottom of the shelf with a small screwdriver. This is a very simple process that does not require any technical knowledge. Upon screw removal, you may place the shelf and support bracket in the new position holes, align the shelf and replace the set screw, if so desired. Set screws do not need to be in every bracket.

**Hardware Pack Location (s) :**

620-01 Server, SKU #42906202