

OWNER'S MANUAL

XFB/XSF/SFL Low-profile Bed

With Motion Sensor And Audio System

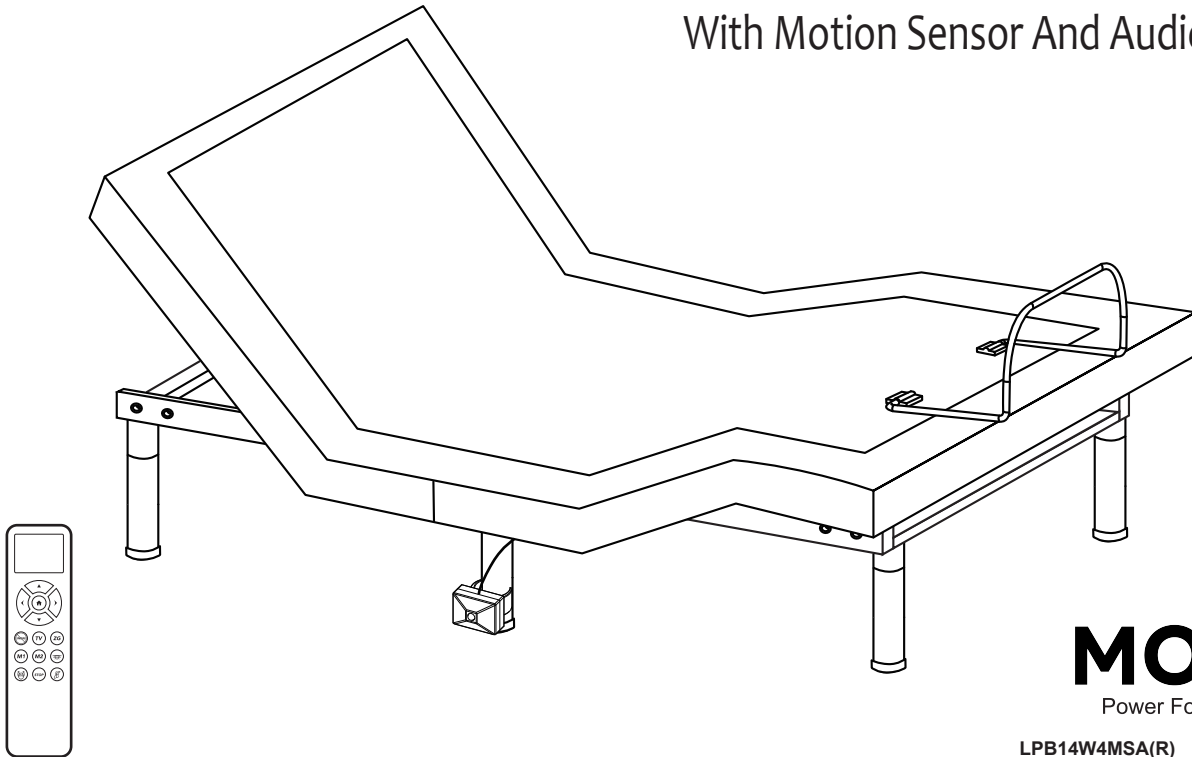

MOTO

Power Foundations

LPB14W4MSA(R) Rev 3.0 09/2025

Setup the power foundation without the bed frame.

1 Open the box lid.

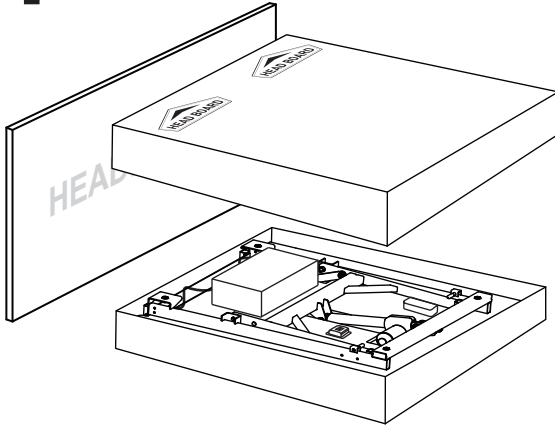

2 Take out all the accessories from the packaging and put them aside. All electronics and components that need to be installed are located in boxes under the foundation or attached to the frame. Before discarding the packing materials, ensure that all the parts are accounted for.

Mattress Retainer Bar



×1(2 for K/CK)

Accessory Box



3 Install 4 legs, make sure the legs are tight.

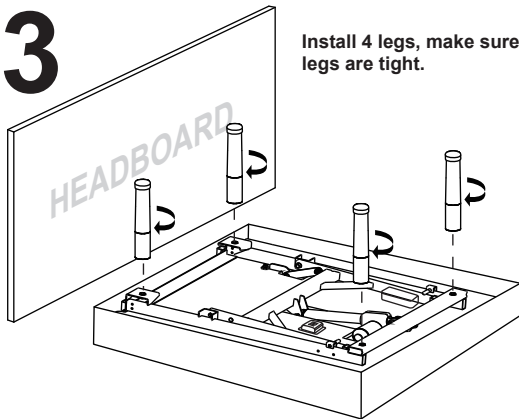

ACCESSORY BOX:

Adjustable Legs



×6

Remote Control



×1

Power Supply with Battery Backup Box

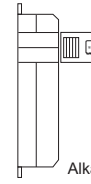

6LR61 Alkaline Batteries (Optional)

×1

AC Power Cord

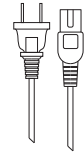

×1

Sync Cord (TXL /TWIN /CKS Only)



×1

AAA Batteries



×3

Mounting Bracket



×2

Motion Sensor

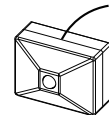

×2

4

Keep the bed folded. Flip over the bed with the bottom box on and let the bed stand on the 4 legs. Move the box away.

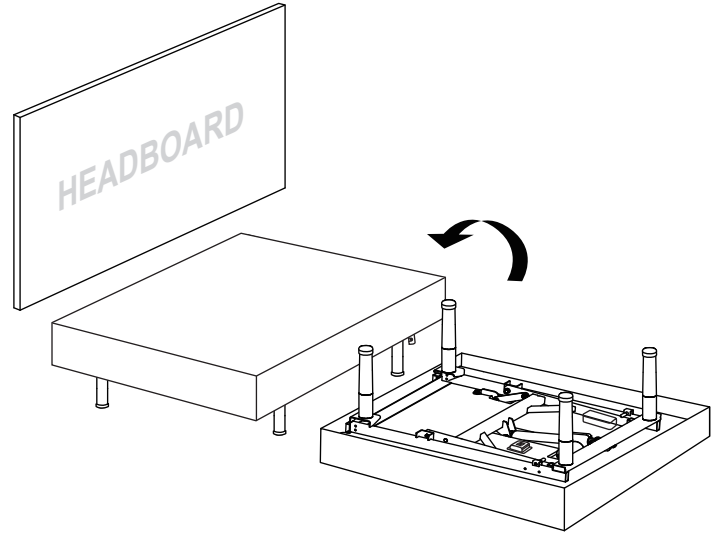

5

Install the remaining 2 legs on the foot end of the bed, make sure the legs are tight. Uncoil the DC power cord (connected to the control box) and put it to the side of the bed.

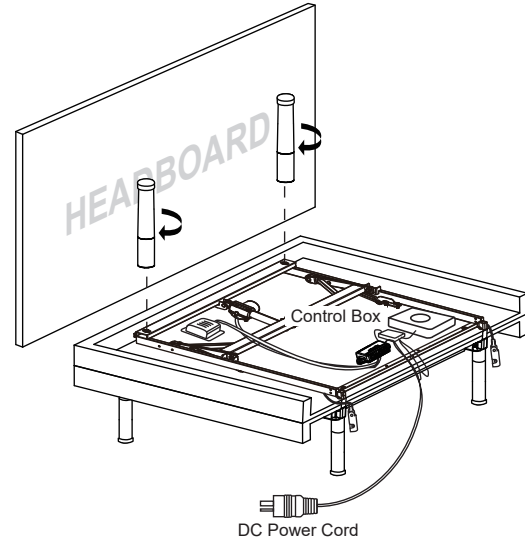

⚠ WARNING!

PLEASE MAKE SURE TO FOLLOW ALL THE STEPS IN 6/1 AND 6/2(REMOVE THE TRANSPORT LIMIT WRENCH) , OR IT WILL DAMAGE TO YOUR POWER FOUNDATION.PLEASE MAKE SURE YOU FOLLOW THE INSTRUCTIONS CAREFULLY BEFORE UNFOLDING YOUR POWER FOUNDATION.

6_{/1}

Please tear off the reminder card and red ribbon and read the information on the reminder card carefully.

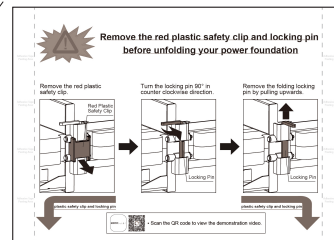
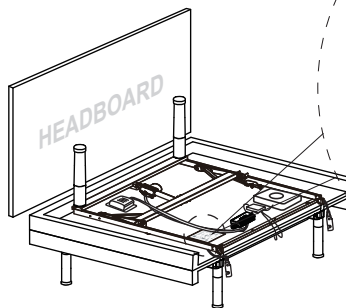

6_{/2}

Remove the red plastic safety clip and transport limit wrench before unfolding your power foundation.

Remove the red plastic safety clip.

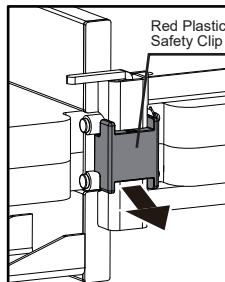

Turn the locking pin 90° in counter clockwise direction.

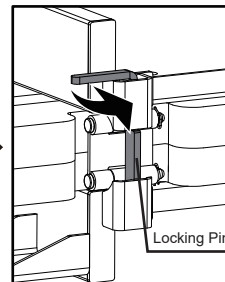

Remove the folding locking pin by pulling upwards.

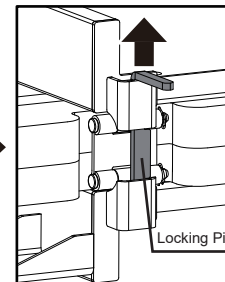

7

Install the motion sensor.

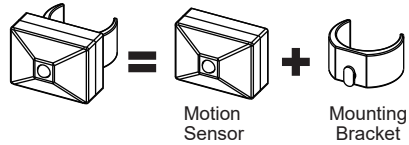

Prepare the motion sensor hardware.

STEP 1: Connect the motion sensor to the mounting bracket.

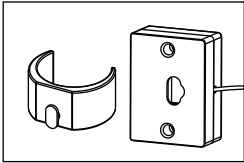

STEP 2: Rotate the mounting bracket 90 degrees clockwise.

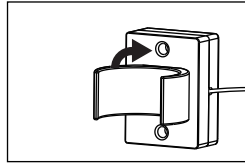

STEP 3: Done!

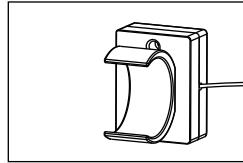

Connect the motion sensor connectors.

STEP 1: Clip the mounting bracket onto the center adjustable legs as illustrated.

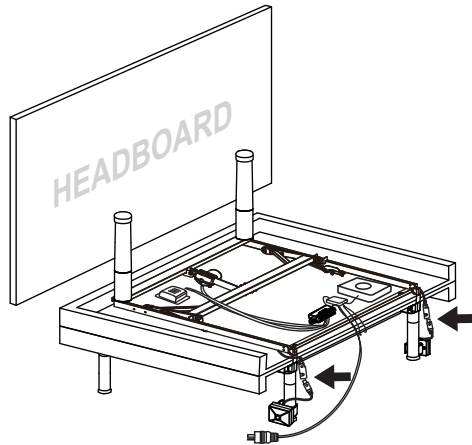

STEP 2: Connect the motion sensor connectors as illustrated. Note there are two connectors, one on each side of the bed.

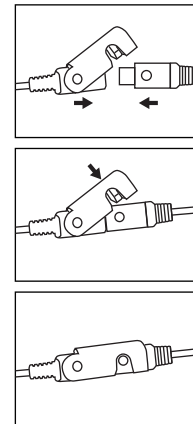

8

Make the bed completely flat.

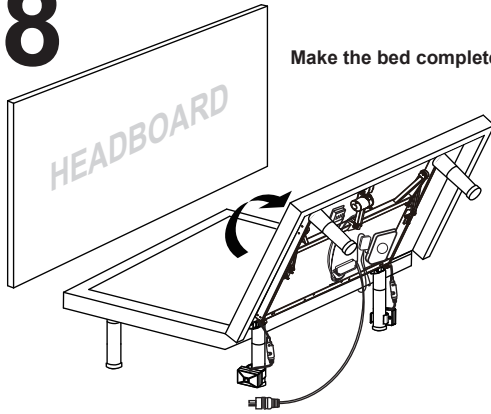

9

Install the mattress retainer bar one side after another.

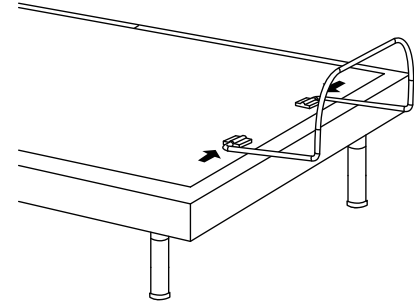

10

Make sure the AC power cord is not connected to the AC power source. Please connect the DC power cord to the power supply, and connect the AC power cord, then last but not least uncoil the AC power cord to connect the power source.

Insert the batteries into the remote control.

AC Power Source

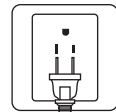

AC Power Cord



Power Supply



DC Power Cord



DONE!

Setup the power foundation with the bed frame and slat base.

1

Take the bed out of the box, put it on the slat base, do not install any legs. Keep the bed folded.

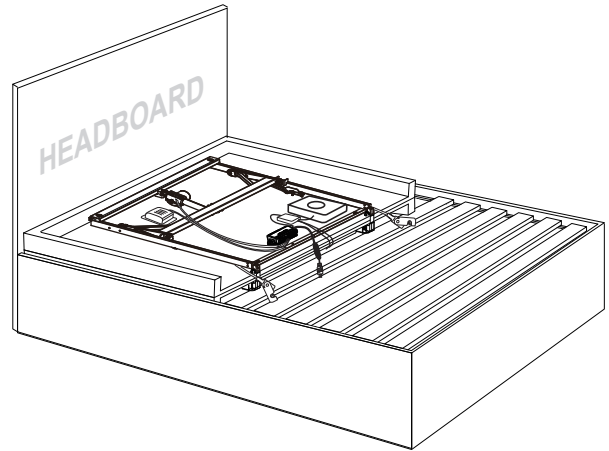

2

Uncoil the DC power cord.

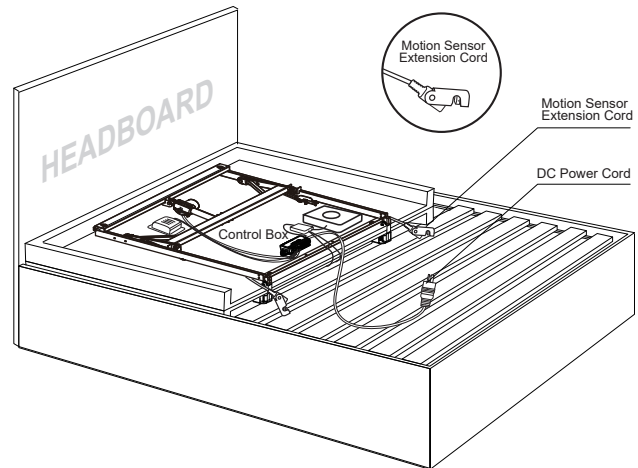



WARNING!

PLEASE MAKE SURE TO FOLLOW ALL THE STEPS IN 3/1 AND 3/2(REMOVE THE TRANSPORT LIMIT WRENCH) , OR IT WILL DAMAGE TO YOUR POWER FOUNDATION.PLEASE MAKE SURE YOU FOLLOW THE INSTRUCTIONS CAREFULLY BEFORE UNFOLDING YOUR POWER FOUNDATION.

3
/1

Please take the reminder card and red ribbon privately and read the information on the reminder card carefully.

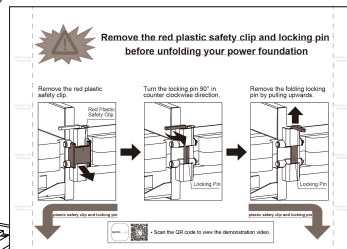
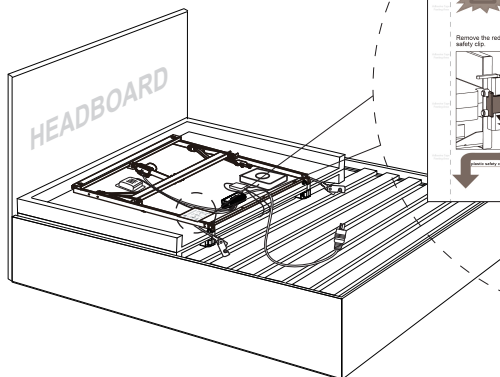

3
/2

Remove the red plastic safety clip and transport limit wrench before unfolding your power foundation.

Remove the red plastic safety clip.

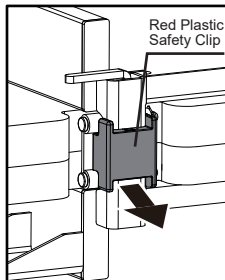

Turn the locking pin 90° in counter clockwise direction.

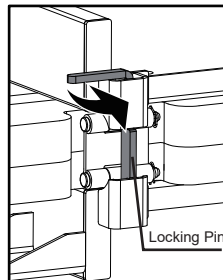

Remove the folding locking pin by pulling upwards.

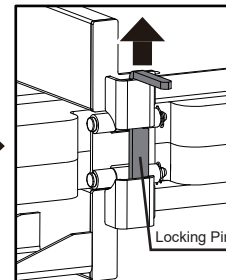

4

Install the motion sensor.

STEP 1: Connect the motion sensor connectors as illustrated.

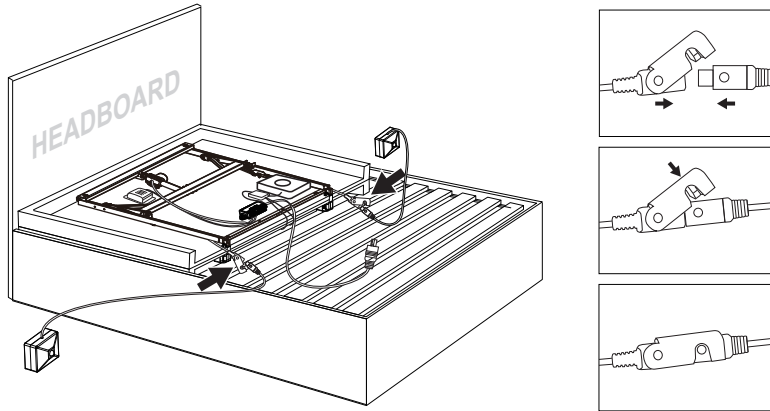

STEP 2: Use the double-side tape to secure the motion sensor when necessary.

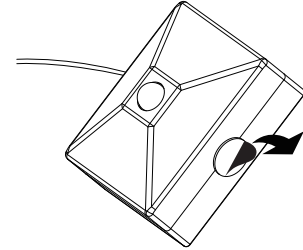

5

Pull the DC power cord towards the direction of the AC power source through either the bottom or the side of the bed frame. Pull the two motion sensors to the two sides of the bed frame. Make the bed completely flat with a flipping motion.

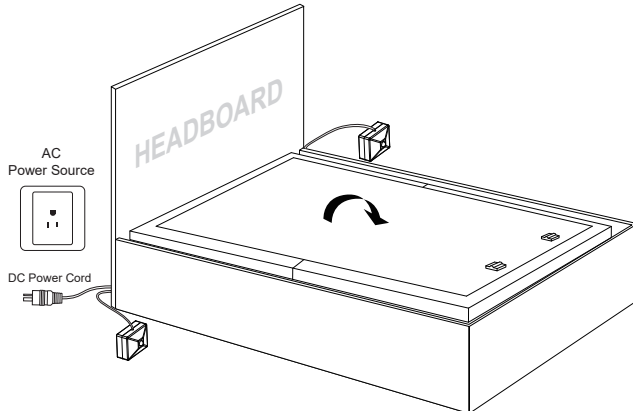

6

Install the mattress retainer bar one side after another.

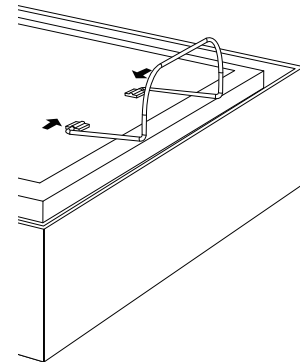

7

Make sure the AC power cord is not connected to the AC power source.
Please connect the DC power cord to the power supply, and connect the AC power cord, then last but not least uncoil the AC power cord to connect the power source.

Insert the batteries into the remote control.

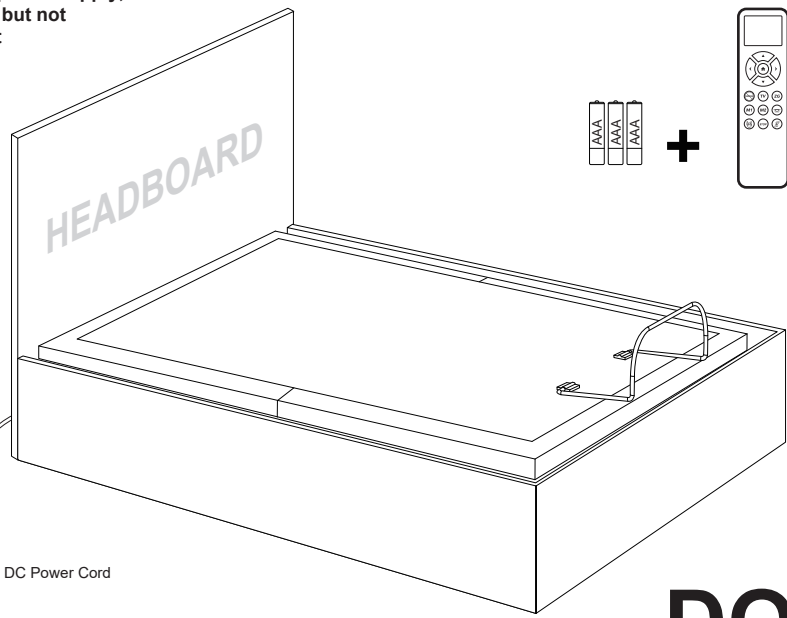
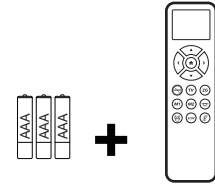
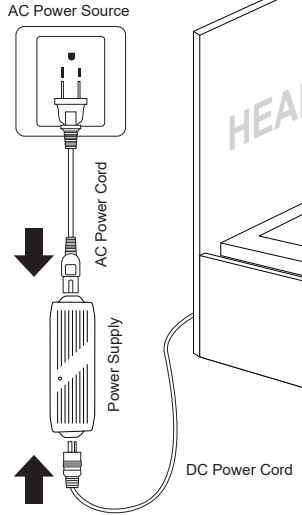

DONE!

Remote Control Instructions

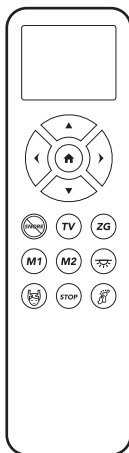

SELECT BUTTON



Press these two buttons to select Head/Foot/Neck/Lumbar section.

ADJUST



This button lifts the Head/Foot/Neck/Lumbar section of the foundation.



This button lowers the Head/Foot/Neck/Lumbar section of the foundation.

MESSAGE FEATURE



Turn on the head massage. Cycle through 3 intensity levels.



Turn on the foot massage. Cycle through 3 intensity levels.

STOP Turn off the head/foot massage.

PROGRAMMABLE POSITION

M1
M2

One-touch programmable positions.

UNDERBED LIGHTING



Underbed LED lighting on/off.

ONE-TOUCH BUTTON



One-touch ANTI-SNOORE preset position.



One-touch HOME (flat) position.

TV

One-touch TV preset position.

ZG

One-touch Z-G (Zero Gravity) preset position. Zero Gravity adjusts your legs to a higher level than your heart, helping to relieve pressure of the lower back and promote circulation.

Pairing Remote

The original remote that comes in the box is already paired to the foundation. No further action is required.

In the event when the remote is not paired with the foundation, follow the pairing instructions below.

STEP 1: Make sure the batteries are working. Replace them when needed.

STEP 2: Unplug the AC power cord from the power source. If 9V backup batteries (6LR61 alkaline batteries) were installed in the power supply, remove them.

STEP 3: Press and hold select buttons (◀ and ▶) until the LCD screen of the remote control shows PAIR.

STEP 4: Plug the AC power cord back into the power source. The LCD screen on the remote control shows PASS, and you will hear an activation sound in 2 seconds, indicating the remote is paired to the power foundation.

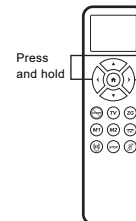

Setting Programmable Position

STEP 1: Adjust the head, foot, neck and lumbar to your desired position.

STEP 2: Press and hold the LED button (light icon) for about 5 seconds until the screen shows SAVE, then press programmable buttons **M1** or **M2**, until you hear a beep sound.

STEP 3: To adjust a saved position, repeat step 1 and 2 and the new position will be remember.

BATTERY LEVEL



The battery icon in the upper-right corner shows the battery level. Replace the batteries when the battery level is low.

CHILD LOCK

LOCK

Press and hold (HOME) and (STOP) buttons simultaneously for about 5 seconds until the LCD screen shows **LOCK**.

UNLOCK

Press and hold (HOME) and (STOP) buttons simultaneously for about 5 seconds until the LCD screen **LOCK** disappear.

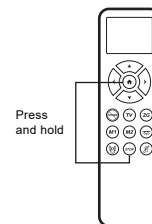

Electronics Quick Reference Guide

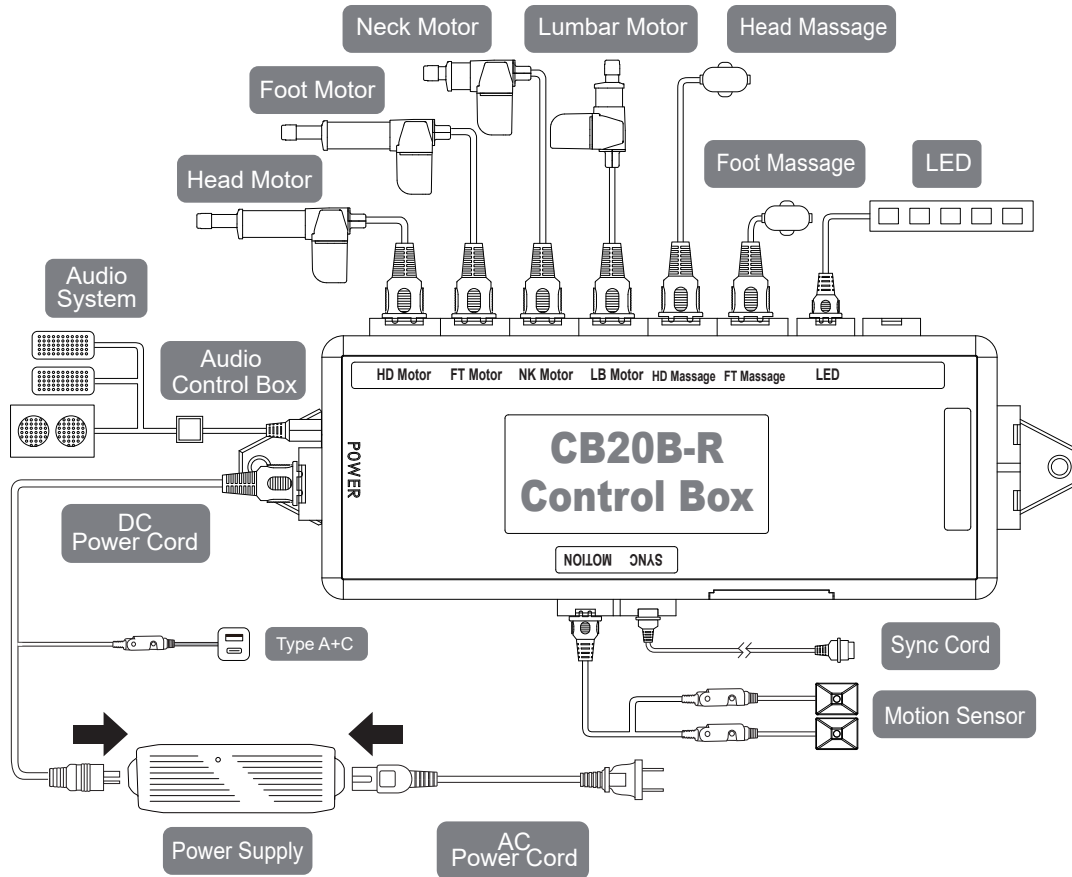

Synchronizing Two Foundations

If simultaneous operation of two foundations is desired, please follow the steps listed below.

Note the sync cord is needed to control two foundations with mobile APP, follow the "Synchronizing Two Foundations with Sync Cord" instruction to install the sync cord or follow the "Wireless Syncing Instruction".

Instructions for Synchronization Using The Sync Cord

- STEP 1: Unplug foundations from the power source.
- STEP 2: Connect the male ends of the sync cord to the female sync plugs of the control boxes (Refer to below illustration).
- STEP 3: Plug foundations back into the power source.
- STEP 4: Check to ensure all cords are securely attached. Either remote will operate both foundations simultaneously.

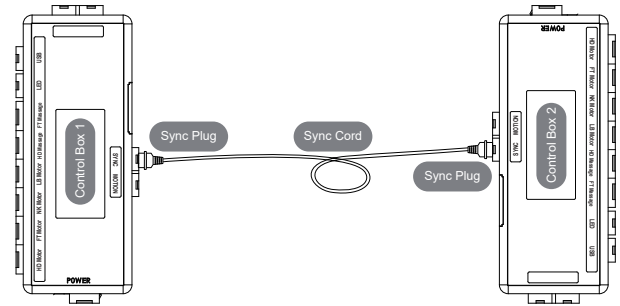

MotoSleep Mobile App (Optional)

General Information

MotoSleep Mobile App is a mobile application to control the MotoSleep Power Foundation with mobile devices. The application is available for both iOS and Android based smart devices.

The MotoSleep Mobile App uses the latest technology to communicate with your MotoSleep Power Foundation. Make sure your mobile devices has the pairing function for the app to work correctly.

Install the MotoSleep App

iOS



- Open App Store on your iOS device.
- Tap the Magnify Glass Icon and search with the keyword **MOTOSLEEP**.
- Tap on **GET** and **INSTALL** to install the app.

Android



- Open Google Play on your Android device.
- Tap the Magnify Glass Icon and search with the keyword **MOTOSLEEP**.
- Tap on **GET** and **INSTALL** to install the app.

The Built-in Owner's Manual at Your Fingertip

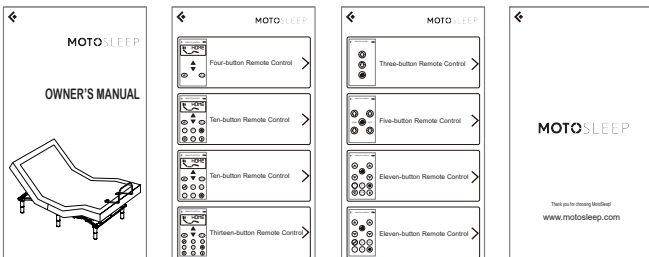

Device Pairing

Before you start, switch on the pairing function on your mobile device. Make sure your MotoSleep Power Foundation is correctly connected and is power-on.

The MotoSleep App will automatically pair your MotoSleep Power Foundation once you start the app and does not require additional settings.

MotoSleep App Home Screen

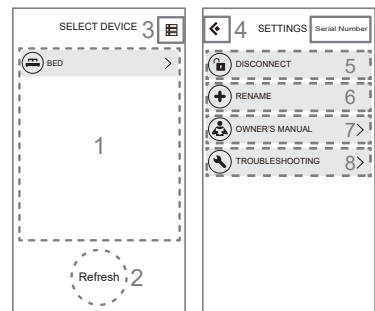

Home Screen

Settings Page

Home Screen	
1	List of MotoSleep Products within the connection range*
2	Tap the Refresh Button to refresh the MotoSleep Products List
3	Enter the Settings Page
Settings Page	
4	Back to the Home Screen
5	Disconnect from the paired MotoSleep Product
6	Rename your MotoSleep Power Foundation of your choice
7	Owner's Manual Page
8	Troubleshooting
9	Serial Number of the control box

* The effective connection range is ± 32ft.

MotoSleep App Remote Control

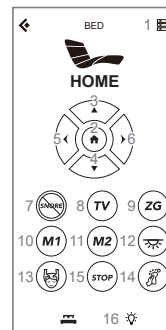







* Remote interface varies in between different MotoSleep Adjustable Base models. If you wish to disconnect from the current paired Adjustable Base, enter the Settings Page and tap the Disconnect button.

Remote Control	
1	Enter the Settings Page
2	One-touch Flat Position
3	Lifting Function
4	Lowering Function
5	Select HEAD, FOOT, NECK or LUMBAR Section
6	Select HEAD, FOOT, NECK or LUMBAR Section
7	Anti-Shore Position
8	TV Position
9	Zero Gravity Position
10	M1-Programmable Position 1
11	M2-Programmable Position 2
12	Underbed LED Lighting
13	HEAD MASSAGE (3 Intensity Levels)
14	FOOT MASSAGE (3 Intensity Levels)
15	STOP MASSAGE
16	Mood Light Setting

Headboard Bracket Installation Guide (Optional)

Headboard brackets are optional and not included. A 1/2" (13mm) socket wrench and 1/2" (13mm) wrench are required to complete the installation.

HEADBOARD BRACKET COMPONENTS				
(2) Headboard Brackets	(2) T-Brackets	(8) M8×16 Bolts	(4) M8 Nuts	(4) 8mm ID Washers
				
OPTIONAL EQUIPMENT/EQUIPMENT (NOT INCLUDED)				
 1/2" (13mm) Socket Wrench / Wrench				

STEP 1

a) Align the headboard bracket slot with the mounting holes on the bed frame. **DO NOT OVERTIGHTEN.** Too much force may damage the thread.

b) The headboard bracket has 2 adjustable slots to accommodate any frame type. Use the (2) M8×16 bolts and (2) 8mm ID washers to secure the bracket. Make sure the bolts are tight.

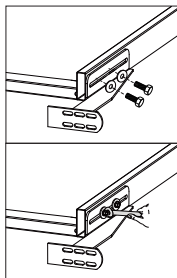

STEP 2

a) To put the T-Bracket and headboard bracket together, you will need (2) M8×16 bolts and (2) M8 nuts. Slip the bolts through the holes from T-Bracket to headboard bracket with the head of bolt facing outward. Use the 1/2" (13mm) socket wrench and 1/2" (13mm) wrench to tighten the bolts.

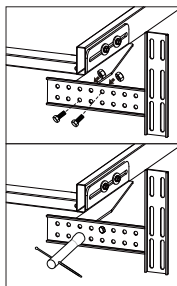





STEP 3

Repeat Step 1 to 2 to install the other headboard bracket on the other side of the bed.

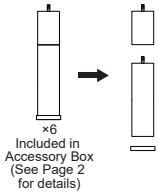
• **“Available for Purchase”. Contact store for details.**

Legs Installation Guide



Leg Configuration Table			
Leg Configuration			
Leg Height	4 "	7 7/8 "	11 3/8 "

Support leg may be needed on some slat/platform bed frames, refer to the leg configuration table for height adjustment.

* Make sure the adjustable legs are properly tight, and the plastic caps have been placed at the bottom of the legs. Incorrect installation might cause the part to fail or damage the floor.

Product Serial Number (Figure B)

Each power foundation has its unique serial number. The serial number can be found on the metal frame near the legs at the foot area.

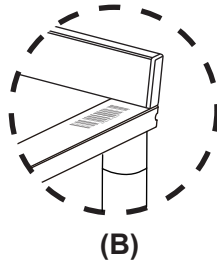

Audio System

Pairing Instruction

Before you start. Switch on the pairing function on your mobile device. Make sure your power foundation is correctly connected and is power-on.

1. Pair with Audio System: Search for the audio device named "Moto Audio" on your device and establish a connection.
2. Music Playback: Once your devices are successfully connected, you can begin playing music through the audio system integrated into the power foundation.
3. Connection Range: Keep in mind that the effective range between the power foundation and your device is approximately 26 ft.

Troubleshooting

SYMPTOMS	SOLUTIONS
No sound	The volume is on minimum. Audio system is not paired properly. Please contact the store or customer service.
Audio system cannot be paired	Restart your power foundation. Do not attempt to pair the device behind a wall. Make sure you are pairing the devices within the connection range (26 ft).

PRODUCT PROTECTED BY FOLLOWING PATENTS:

- US PATENT: 11, 013, 330
- US PATENT: 10, 306, 994
- US PATENT: 12, 116, 818
- CN PATENT: 2, 017, 212, 139, 372
- CN PATENT: 2, 017, 212, 138, 628
- CN PATENT: 2, 018, 209, 869, 548

Customer Service Toll Free: 1-844-696-6886

Email: motoservice@motomotion.com