

# HARDWIRING ASSEMBLY INSTRUCTIONS FOR Ashton Wall Lamp

3434-01 2.0

ITEM# 3434-01

**BEFORE STARTING- SHUT OFF BREAKER AT MAIN DISCONNECT**

Make sure all power is disconnected at existing fixture and that there are no live wires in the junction box.

Not all junction boxes include simple wiring .If you are unsure or have doubts of electrical connection,call an electrician for assembly .

Remove all items from the packaging.

## Step 1.

If you would like for this lamp to be hardwired into your wall, remove 2 screws (C) from the canopy (B) and bracket (A) as shown. Then carefully unscrew 2 wire nuts and remove the main black cord from canopy (B).

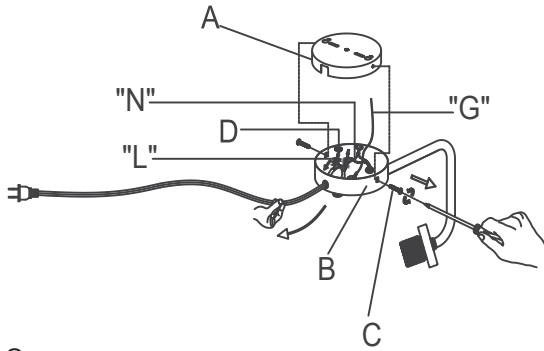

## Step 2.

Find your ground wire, hot wire and neutral wire in your junction box and pull them through the central round hole of bracket.

Fasten Bracket (A) into junction box with 2 screws (E) to tighten.

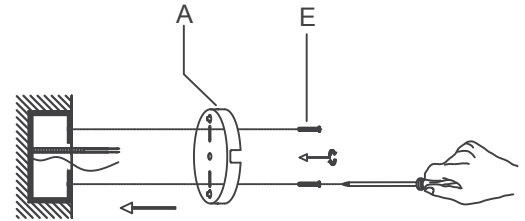

## Step 3.

(1) Attach the neutral fixture wire (N) from the canopy (B) to the neutral wire in junction box (usually white).

(2) Attach the hot fixture wire (L) from the canopy (B) to the hot wire in junction box (usually black).

(3) Twist both ground wire ("G") in your home and in canopy.

Cover the connected wires with wire nut (G) - tighten each connection by turning clockwise.

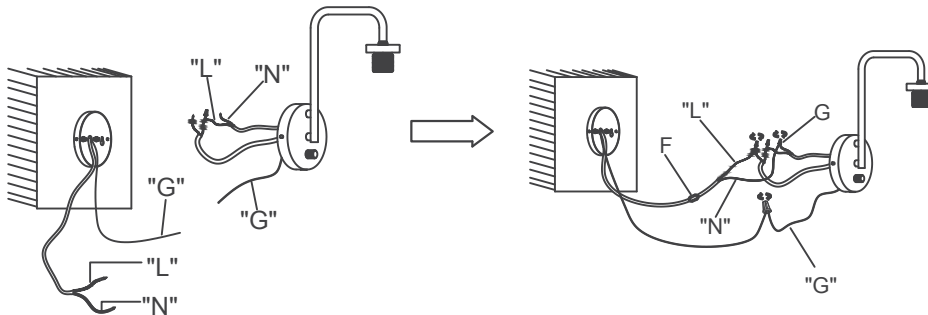

### GENERAL PRODUCT INFORMATION:

This product is suitable for dry locations only.



### IMPORTANT SAFETY INSTRUCTIONS:

This portable lamp has a polarized plug (one blade is wider than the other) as a feature to reduce the risk of electric shock. This plug will fit in a polarized outlet only one way. If the plug does not fit fully in the outlet, reverse the plug. If it still does not fit, contact a qualified electrician. Never use with an extension cord unless plug can be fully inserted. **DO NOT ALTER THE PLUG.**

BULB TYPE: (1) 40 watt type A vintage bulb included.

## Step 4.

Push up the canopy (B) to cover Bracket (A) properly and fasten with the 2 screws (C) separately to tighten.

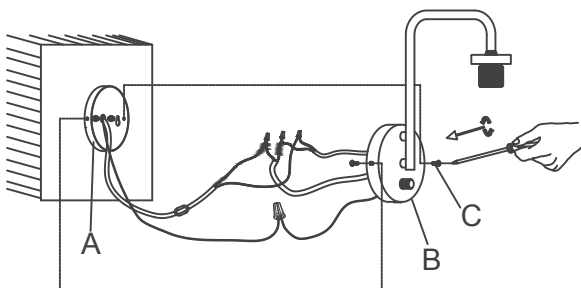

## Step 5.

Place shade (J) on lamp socket (I) and tighten clockwise with socket ring (K) to secure shade. Then Screw bulb (L) clockwise into socket (I) to tighten.

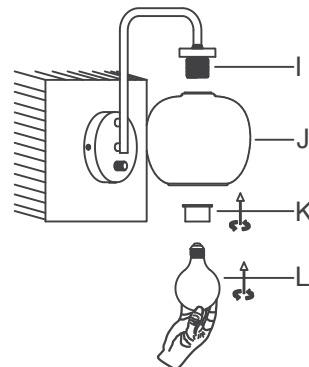

### PARTS DIAGRAM:

- (3) Screw (E)
- (3) Wire nut (G)
- (2) 8-shade cord (F)